

# ASSEMBLY INSTRUCTION

WALL CABINET

MODEL#

W3024 W3624 W362424

Estimated Assembly Time: 30 - 40 minutes  
2-person assembly recommended

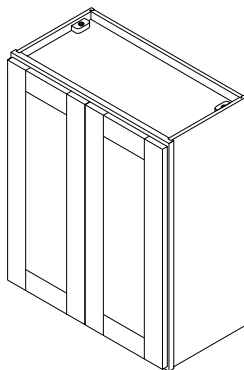

## TOOLS REQUIRED

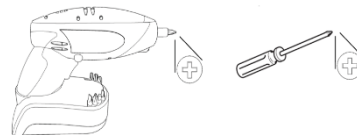

PART	DESCRIPTION	QTY	PART	DESCRIPTION	QTY
A1	Box side panel - left	1	D	Face frame & door panel	1
A2	Box side panel - right	1	K	Adjustable shelf	1
B	Box bottom panel	1	L	Box top panel	1
C	Box back panel	1			

## HARDWARE CONTENTS

**DD** Rubber bumper x 4

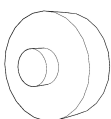

**EE** Adjustable shelf clip x 4



**FF** 1" Flat head phillips screw x 8



1

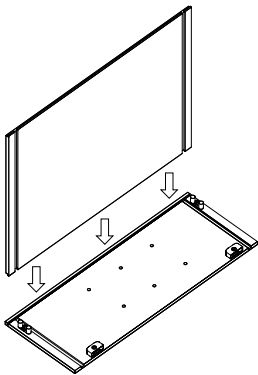

2

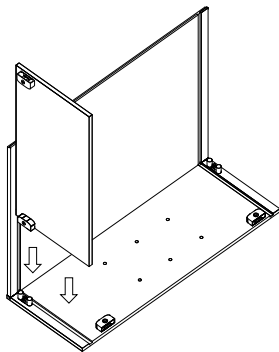

3

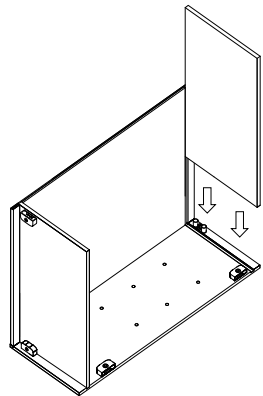

4

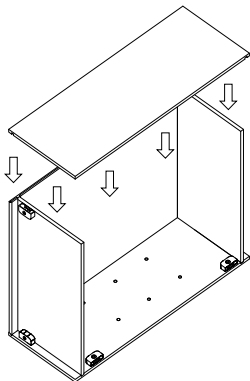

5

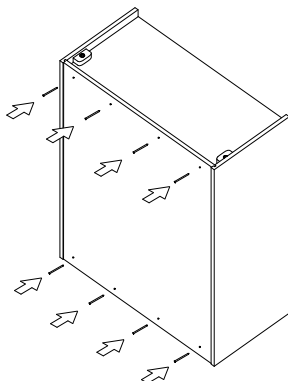

6

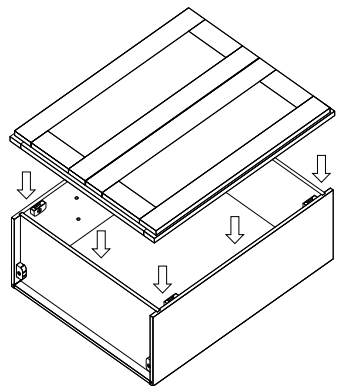

7

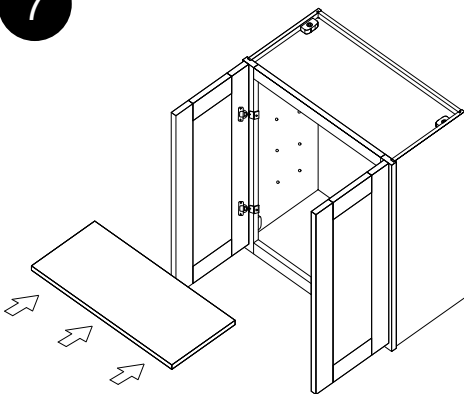

8

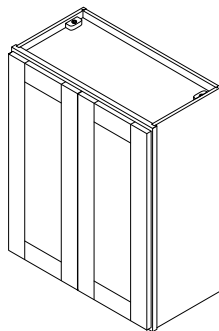

## CAMLOCK CONNECTION

---

1. Insert the camlock to the locker.

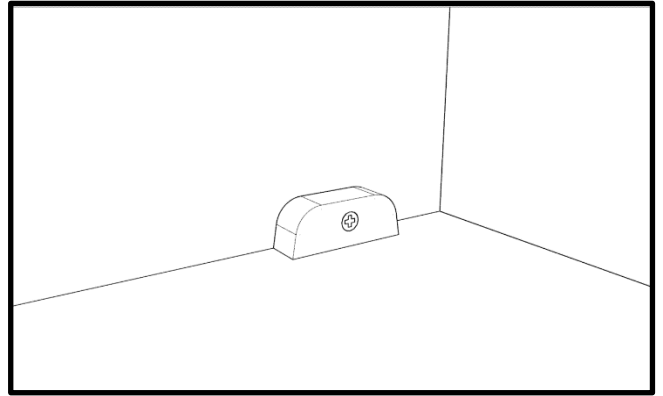
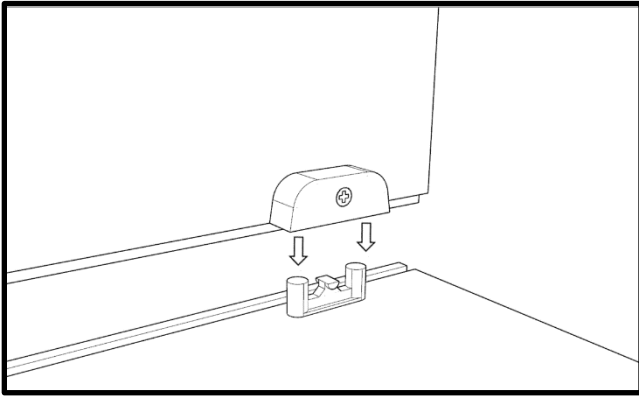

2. Turn the nut clockwise to latch two parts.

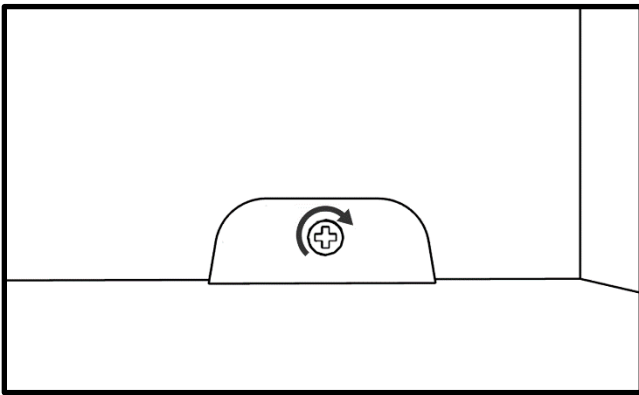

## ADJUSTABLE SHELF INSTALLATION

1. Insert four shelf clips into the pre-drilled holes on the inner side of cabinet box side panels at the same height for one shelf.

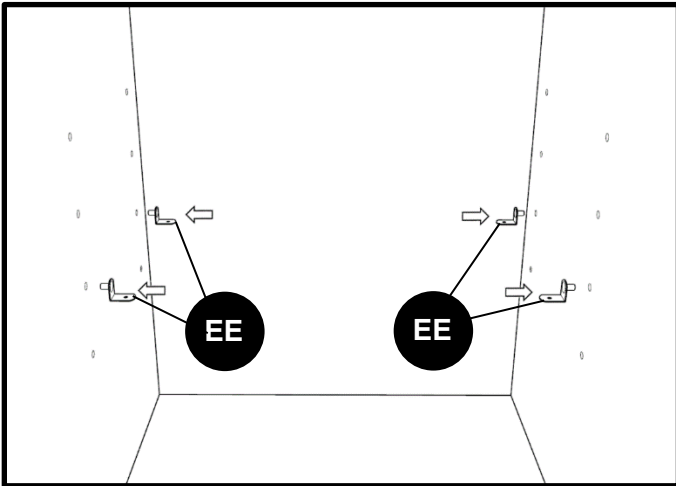

2. Insert the adjustable shelf at a tilted angle.

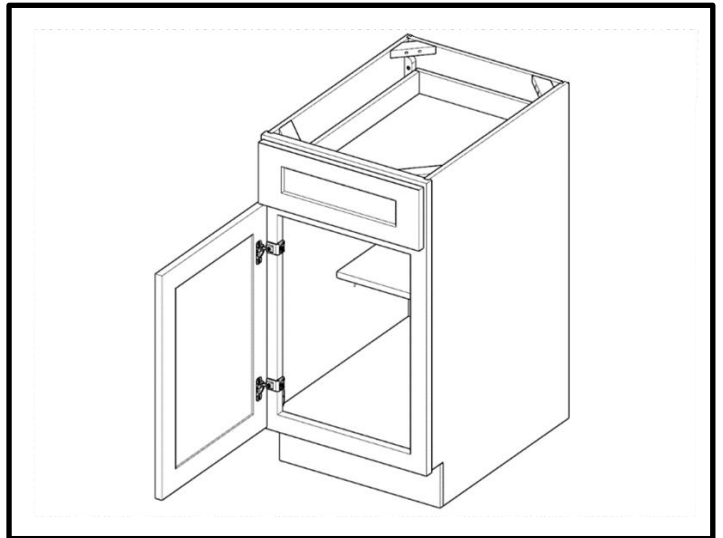
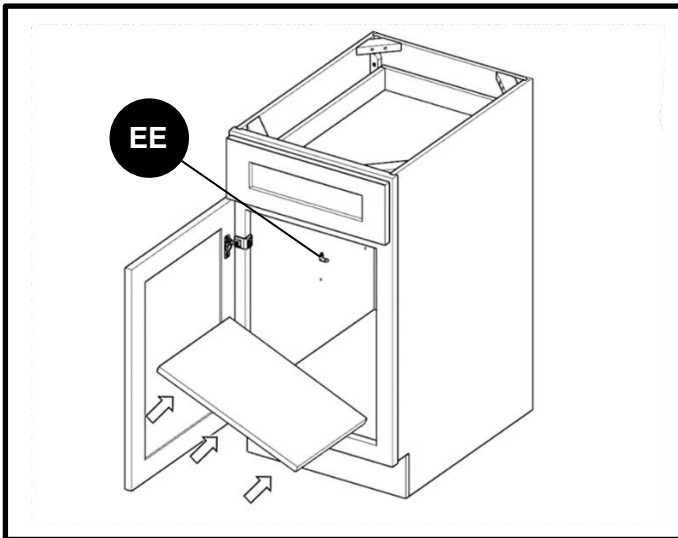

## FASTEN BOX BOTTOM PANEL AND BOX BACK PANEL

1. Drill 1" flat head Phillips screw to the predrilled holes and fasten box bottom panel with box back panel

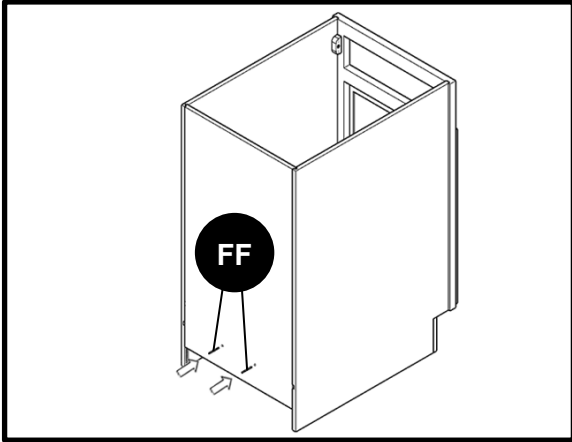

## RUBBER BUMPER INSTALLATION

1. Attach rubber bumpers to 4 corners of each drawer face panel and 2 outsider corners of each door panel.

