



Wi-Fi Smart Plug

NSH-1000

Quick Start Guide

► Connecting to Wi-Fi

1. To Begin, you must first download the Smart Life App. For easy access, scan the QR code below and download the app.



Otherwise, search "Smart Life" in the Google Play Store™, App Store™, or Android Market in your phone.



2. Once downloaded, the app will ask you to register your device. Enter your phone number or email. If you select phone number, a registration code will be texted to you. No registration code is required if you choose the email method.

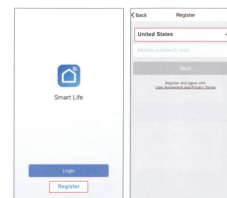

Please note: Smart Life supports two mode configurations, Easy mode and AP mode. It is recommended that you choose Easy mode before adding the device to the app.

To ensure your Smart Plug is in easy mode, hold the power button for 6 seconds, until the light begins to flash rapidly (flashing twice per second). If the indicator light is flashing slowly (once every two seconds), then it is in AP mode.

3. Once the Smart Plug is in Easy mode, tap the "+" icon in the top right-hand corner of the screen. Choose your device type "Electrical Outlet", and continue to "Add Device".

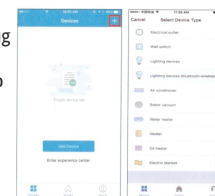

4. Follow the in-app instructions to connect your Smart Plug on the Wi-Fi network.

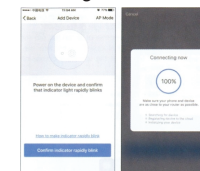

5. Once connected, Smart Life will prompt the connection. Click "Done"

6. Now you will be able to fully control your Smart Plug via the Smart Life app.

► Connecting with Alexa™

You can also control your Smart Plug using just your voice. To do so, follow these steps:

1. Open the Smart Life app, sign in to your account, and ensure that the Smart Plug is in the device list.
2. Rename the Plug so Alexa can more easily recognize it, such as: Kitchen Socket, Bedroom Socket, etc.

3. Minimize the Smart Life app and sign in to your Alexa account on the Alexa app. If you do not have a registered Alexa account, sign up for one.

4. In the upper left-hand corner of the Home page, click ≡ to show the app menu. Click "Skills".

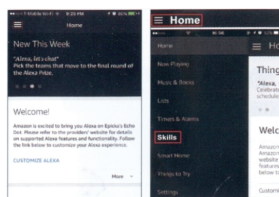

5. Type "Smart Life" in the search bar.

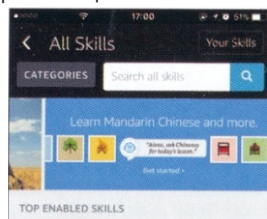

6. Enable Smart Life as a skill, then sign in to your Smart Life account to complete the account linking.

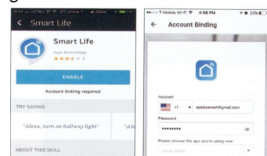

7. After your accounts have been successfully linked, you can ask Alexa to discover devices. Alexa will show all the discovered devices after 20 seconds.

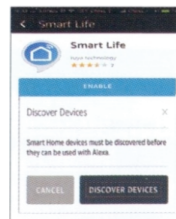

8. Go back to the Menu screen and click "Smart Home".

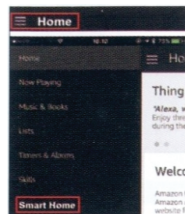

9. In your Smart Home page, you can group your devices for different categories. Your Smart Life app has been skilled with Alexa, so you may now control your Smart Plug through Alexa.

► Connecting with Google Home™

1. Open the Google Home app and sign in to your account. If you do not have a Google Home account, download the app from the Play Store or App Store and sign up for one.

2. Once Google Home is installed, click ≡ to open the app menu. Click "Home Control" in the menu dropdown.

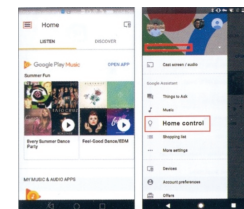

3. Go to the "Add Device" page, scroll down to find "Smart Life" and then click it. Sign in to the Smart Life app with your account and password.

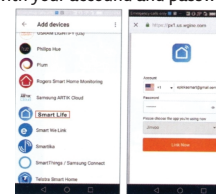

4. After successfully linking accounts, you can see all the smart devices from your Smart Life account on the Google Home app.

5. You can now use Google Home to voice control your smart devices.

OK Google, turn on/off wall light
OK Google, set bedroom light to red.

► Support

If you have problems with your device, please consult the instructions in this manual. Please also visit us on the web at www.naxa.com to get the latest news, alerts, and documentation for your device. For additional assistance, please contact Naxa Technical Support.

NAXA Technical Support
2320 East 49th St.
Vernon, CA 90058

Trademark & Regulatory Statements
Google Home™, Google Assistant™, and the Google Play Store™ and all Google Brand Features are trademarks or distinctive brand features of Google Inc., LLC.
The Apple App Store™ is a trademark of Apple Inc.
*Amazon, Alexa, and all related logos are trademarks of Amazon.com, Inc. or its affiliates.

