

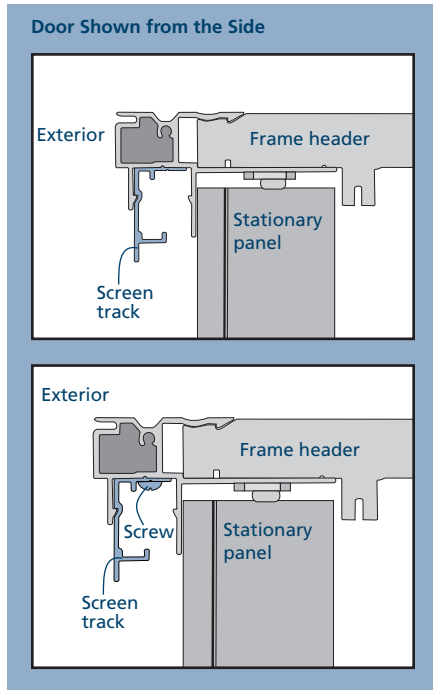

Installation Instructions for Hanging Screens

If the track is not factory installed, we recommend beginning with steps 1-4 to pre-install the track to make it easier to install the screen. If the track is already installed, skip to step 5.

1. Place the screen track in the exterior most track of the frame header. Center the track in the header and position with the long leg facing toward the outside edge as shown.
2. Hold the track securely so that it does not move and mark the frame header through one of the pre-drilled holes in the track.
3. Secure with one of the provided screws.
4. Repeat for the two remaining screws.
5. Remove the screws and the screen track from the frame header (if installed on frame).



6. Insert the screen rollers into one end of the screen track.

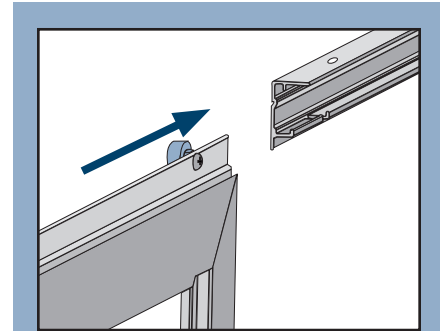

7. Place the screen and screen track into place in the frame header. Secure with previously removed screws on the open side. Move screen to opposite end and install the remaining screw(s).

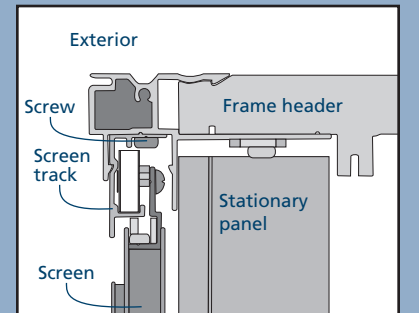

8. On the bottom of the screen, lift the guide on both ends up and over the rail on the sill track until the groove in the guides aligns with the rail. Adjust the guides up or down with a Phillips screwdriver so that they do not rub on the sill.

