

Features

- Metal construction
- Wall-mount installation
- Includes check valve for backflow prevention
- 1/2" - 14 NPT connection
- Pivots to position a handshower
- For use with handshower and hose
- Coordinates with Artifacts faucets and accessories

Codes/Standards Applicable

Specified model meets or exceeds the following:

- ASME A112.18.1/CSA B125.1

HANDSHOWER HOLDER K-72797

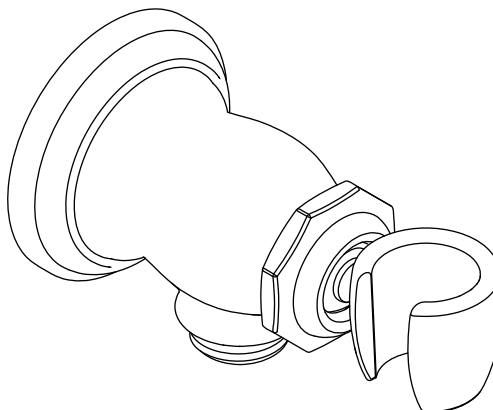

Colors/Finishes

- CP: Polished Chrome
- Other: Refer to Price Book for additional colors/finishes

Specified Model

Model	Description	Colors/Finishes	
K-72797	Handshower holder	<input type="checkbox"/> CP	<input type="checkbox"/> Other_____

Product Specification

The handshower holder shall be of metal construction. Product shall be wall-mount installation. Product shall include check valve for backflow prevention. Product shall have 1/2" - 14 NPT connection. Product shall pivot to position a handshower. Product shall be for use with handshower and hose. Product shall coordinate with Artifacts faucets and accessories. Product shall be Kohler Model K-72797-_____.

Installation Notes

Install this product according to the installation guide.

Product installs using a NPT connection to a 1/2" - 14 NPT nipple.

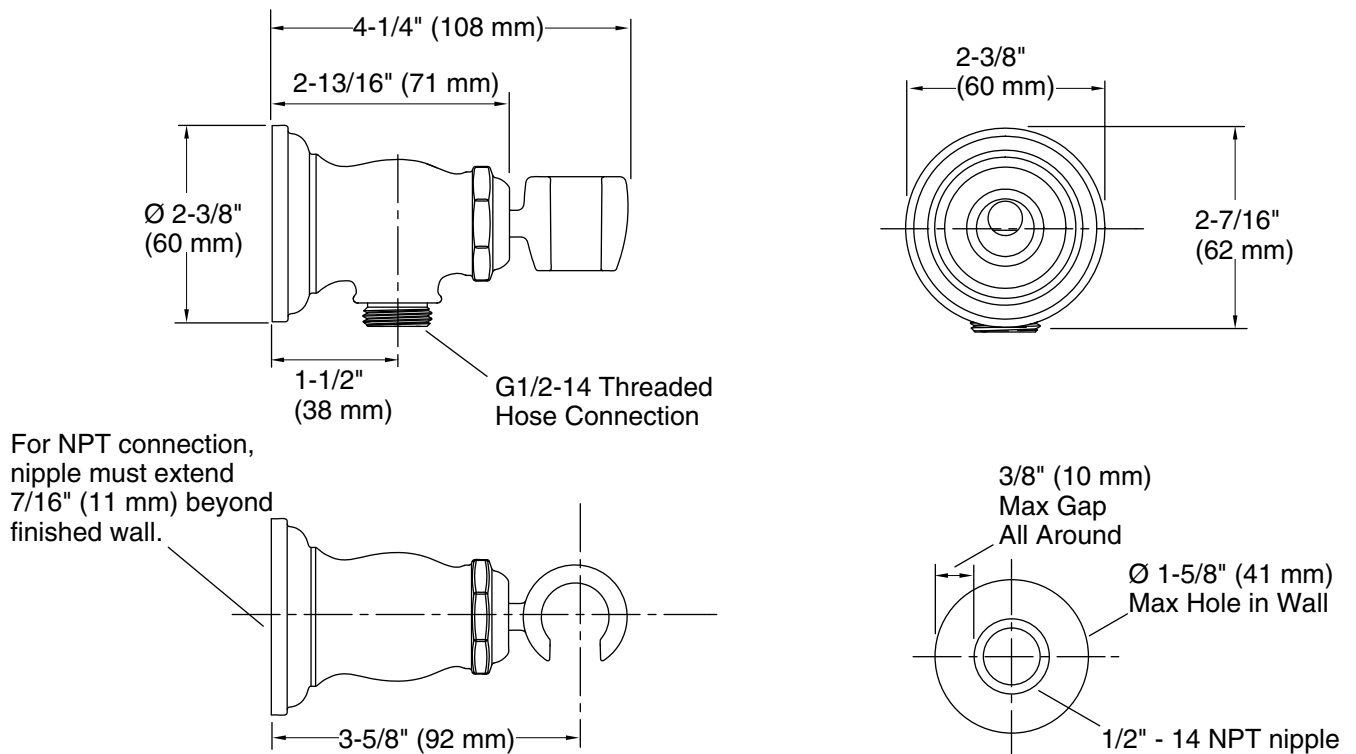

Product Diagram