

# SuperOak

Hybrid Wood Planks



SuperOak Flooring Installation Guide

### Installation

SuperOak is a high-quality, floating floor system designed for indoor use within controlled environmental conditions. This guide outlines the necessary steps and precautions for its proper installation, ensuring compliance with both aesthetic and building code requirements.

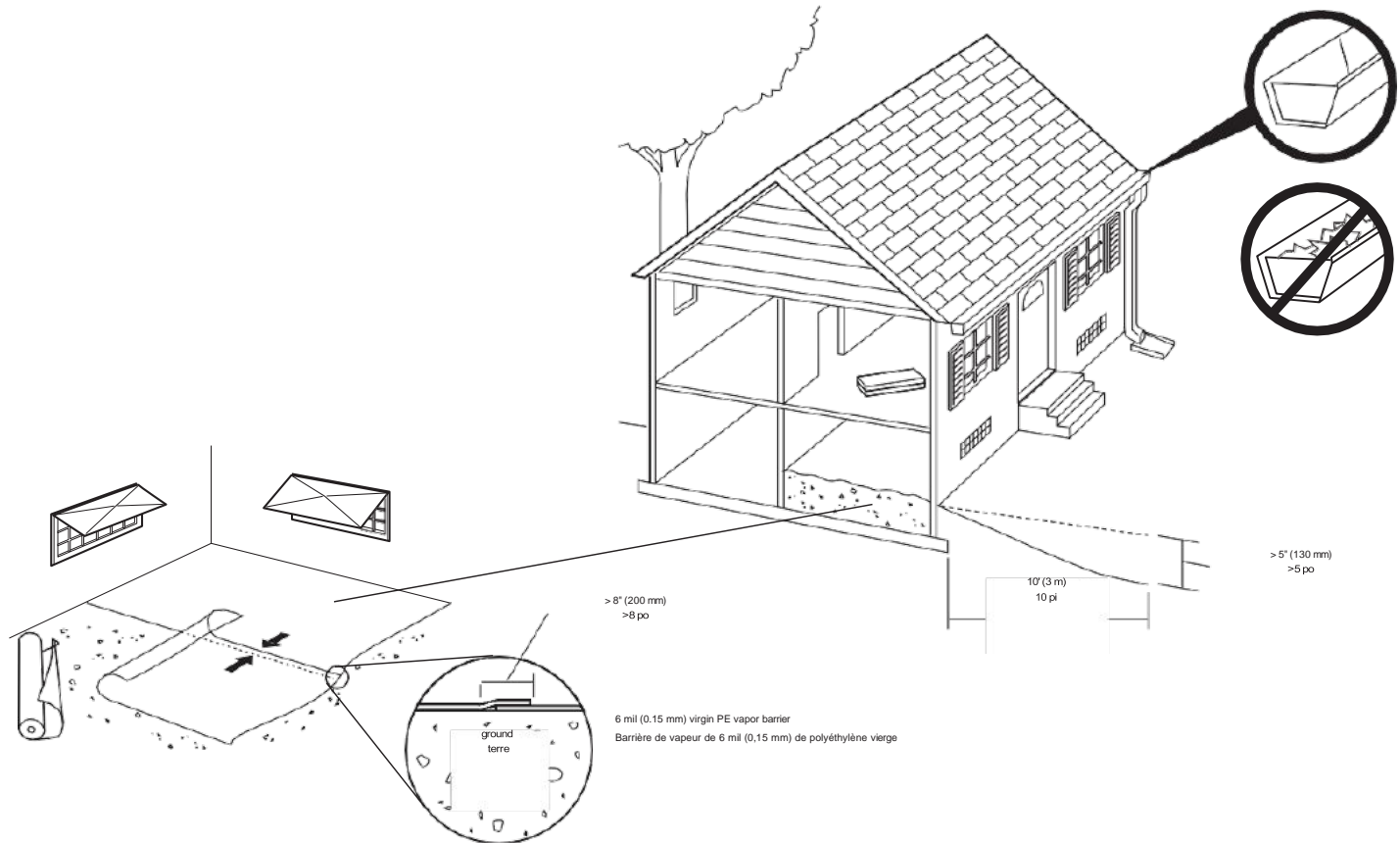

### I. General Requirements

- Purpose: SuperOak is intended solely as a floor covering, not as a load-bearing surface.
- Environment Suitability: Install only in climate-controlled areas (35-65% RH and 60-85°F).
- Subfloor Compliance: Must comply with local building codes, be clean, dry, and secure.
- Moisture Testing: Essential for both concrete (per ASTM F1869  $\leq 5 \text{ lbs}/1000\text{ft}^2/24\text{-hr}$  or  $< 80\% \text{ RH}$  per ASTM F2170) and wood subfloors (moisture content  $\leq 12\%$ ).

### II. Preparatory Steps

- Subfloor Preparation: Remove existing flooring materials, ensuring all are asbestos-free. Correct any subfloor irregularities to maintain a level within  $3/16"$  per 10-foot span.
- Undercutting: Modify door frames and bases to accommodate a minimum of  $1/4"$  flooring clearance and a  $3/8"$  expansion gap.
- Acclimation: Allow the flooring materials to adjust to the installation environment, aligning temperature and humidity variations within a 25°F and 20% RH differential.



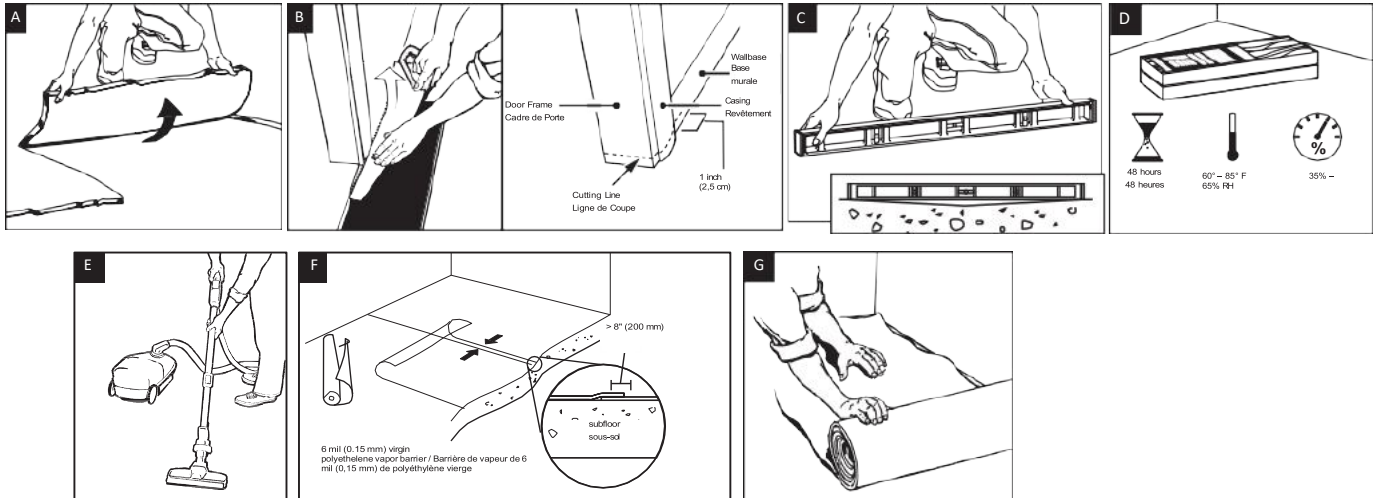

### III. Installation Protocol

- **Layout and Planning:** Start by blending planks from various cartons to ensure uniform appearance. Plan the first row by removing the tongue on necessary sides, and maintain alignment against the longest wall.
- **Securing Planks:** Connect planks by inserting the tongue into the groove and rotating downward to lock. Ensure each joint is tight and flush, utilizing a tapping block where needed.
- **Expansion Gaps:** Maintain a consistent 3/8" gap around the perimeter and fixed objects to allow for natural expansion.
- **Finishing Rows:** Measure and cut the final rows to fit, ensuring the tongue and groove engage properly with the aid of a pull bar and hammer for a secure fit.

### IV. Post-Installation

- **Sealing:** Apply a 100% silicone sealant around the perimeter over a backer rod, ensuring all gaps are filled to create a watertight barrier.
- **Trim and Transitions:** Install transition strips and base molding, sealing with silicone to prevent moisture ingress.
- **Site Cleanup:** Remove all spacers and clean the installation area thoroughly to remove any debris and excess material.

### V. Care and Maintenance

- **Routine Care:** Use a dust mop for regular cleaning. For heavier soil, use a damp mop with a mild solution (1 cup of vinegar per gallon of water or 1/3 cup non-sudsing ammonia per gallon of water). Avoid abrasive cleaners and excessive water.
- **Furniture Protection:** Attach felt pads under all movable furniture and utilize rubber casters to prevent scratches.

### VI. Special Considerations for Minnesota Residents

- Health Advisory: Be aware of formaldehyde emissions which may cause irritation and other respiratory symptoms. Enhance ventilation, especially during extreme temperatures, to mitigate exposure.

### Disclaimer

This installation guide does not supersede local building codes and regulations. Always consult a professional if uncertain about the installation requirements or conditions.

This guide ensures that both installers and end-users can effectively and safely install SuperOak -Hybrid Wood Planks, maintaining its quality and durability.

