

DESCRIPTION:

- Bath Cock with chrome finish

OPERATION:

- Metal handles

FLOW:

CARTRIDGE:

- Compression cartridge design

STANDARDS&CERTIFICATES:

- ASME A112.18.1/CSA B-125.1 and all applicable requirements referenced therein
- cUPC

WARRANTY:

-

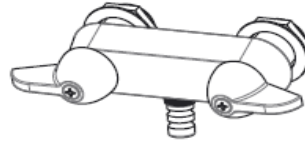

Bath Cock

Models: 3220-40-CH-B(Chrome Finish)

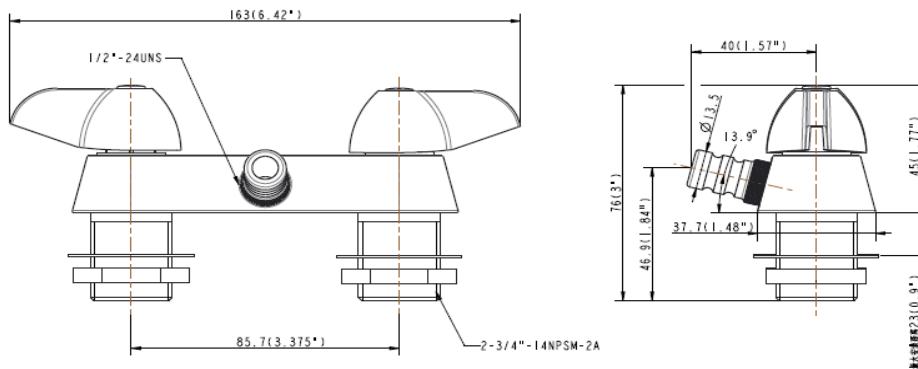

Homeworks product specifications in U.S. customary units and metric are approximate and are provided for reference only. For precise measurements, please contact Homeworks Technical service. Homeworks reserves the right to change or modify product design, construction, specifications, or materials without prior notice and without incurring any obligation to make such changes and modifications on Homeworks products previously or subsequently sold.

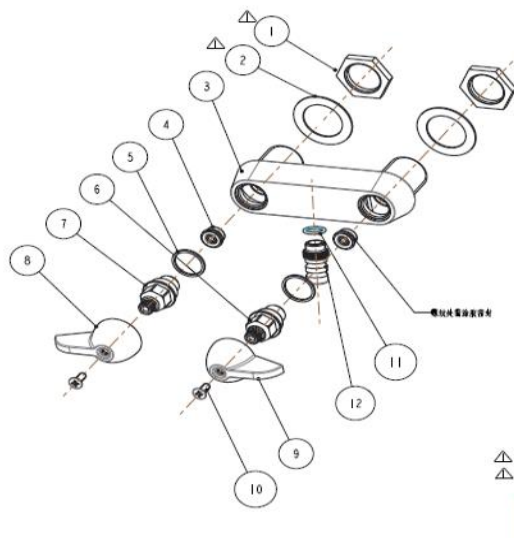

Part No.	Des.	Material	QTY
1	Mounting flange	Brass	2
2	Gasket	Red steel paper	2
3	Body	Brass	1
4	Adapter	Brass	2
5	Washer	POM	2
6&7	Hot/Cold Compression cartridge	Brass	1
8&9	Hot/Cold Zn	Zinc	1
10	Screw	S/S	2
11	O-Ring	Rubber	1
12	Connector	Brass	1