

### Features

- *Vitreous china*
- *Siphon jet*
- *3/4" rear spud*
- *1.0 gpf (3.8 lpf)*
- *Includes inlet and outlet spuds and hangers*

### Codes/Standards Applicable

Specified model meets or exceeds the following:

- *ASME A112.19.2/CSA B45.1*

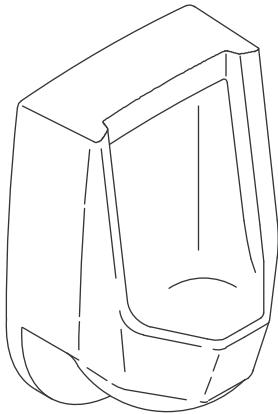

### Colors/Finishes

- 0: White
- Other: Refer to Price Book for additional colors/finishes

### Specified Model

Model	Description	Colors/Finishes	
K-4989-R	3/4" rear spud urinal	<input type="checkbox"/> 0	<input type="checkbox"/> Other_____

### Product Specification

Siphon jet urinal shall be made of vitreous china with a 3/4" rear spud. Urinal shall include inlet and outlet spuds and hangers. Urinal shall use 1.0 gpf (3.78 lpf). Urinal shall be Kohler Model K-4989-R-\_\_\_\_\_.

# FRESHMAN™

## Technical Information

Fixture:	
Configuration	Rear spud
Water per flush	1.0 gal (3.8 L)*
Spud inlet size	3/4"
* Designed to flush with 1.0 gal (3.8 L) of water when installed with a water-saving flushometer.	
Included components:	
3/4" inlet spud	18376
Hanger (2 required)	64512

## Installation Notes

Install this product according to the installation guide.

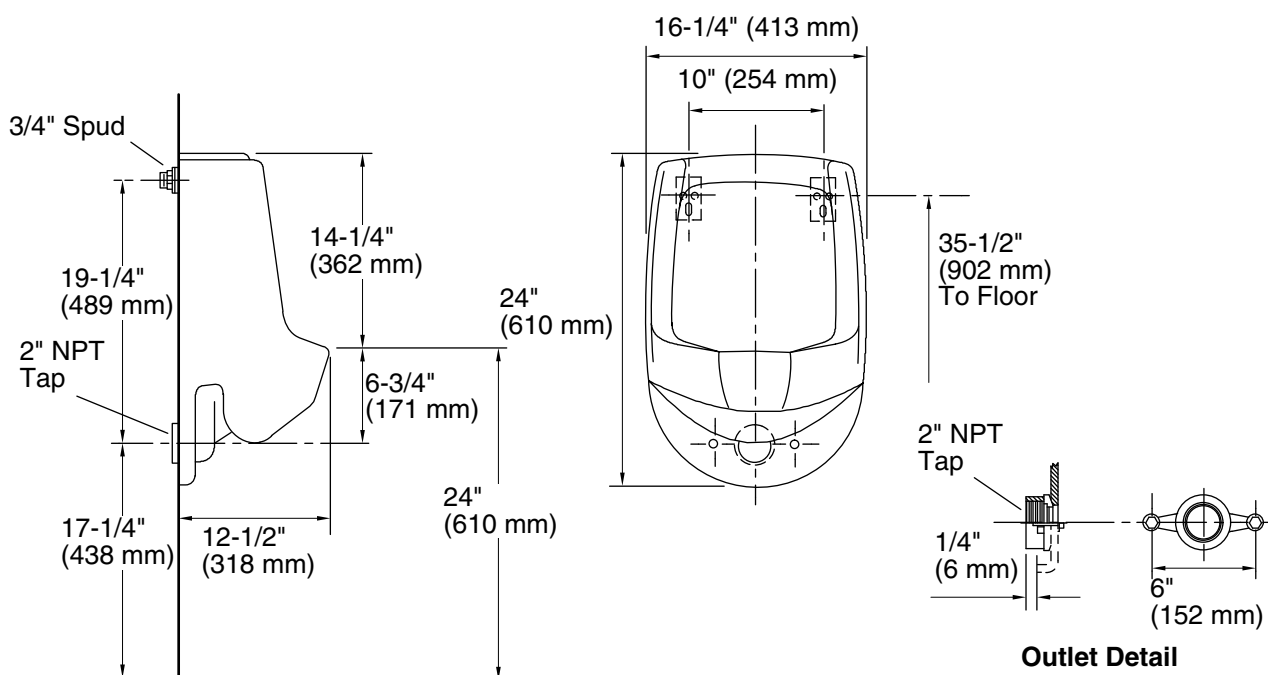

## Product Diagram