

# tunuo

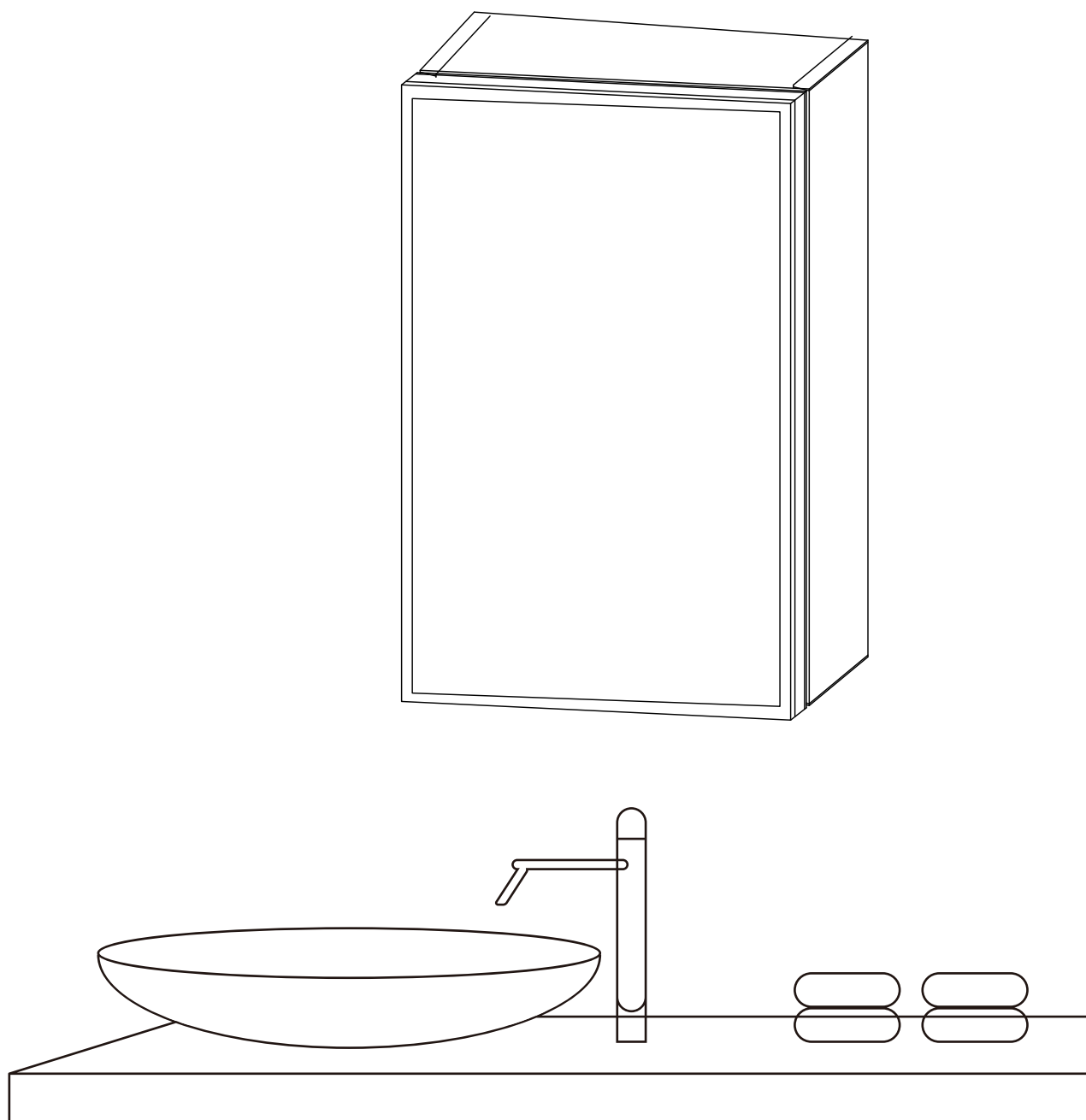

## INSTALLATION MANUAL

# HARDWARE AND TOOLS

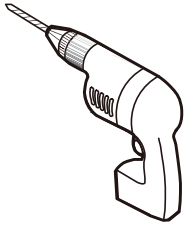

Power Drill



Mallet



Tape Measure

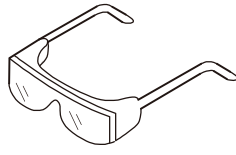

Safety Goggles



1/4" & 1/8" Drill Bits



Pencil



Level

## HARDWARE LISTS

ITEM	IMAGE	NAME
1	A line drawing of a screw.	Screw ST4
2	A line drawing of a wall anchor.	Wall Anchor
3	A line drawing of an aluminum alloy plate.	Aluminum Alloy Plate
4	A line drawing of an aluminum corner brace.	Aluminum Corner Brace

# INSTALLATION INSTRUCTIONS

## APPLY TO THE BELOW STYLE OF LED MEDICINE CABINET

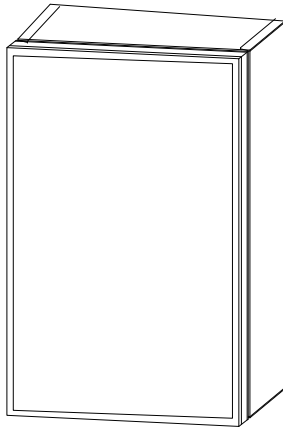

Please read carefully and save these instructions

Don't discard any of the packaging until you are sure that you have all of the parts and the fittings

Make sure power to the junction box is off before commencing installation.

### IMPORTANT

1. Unpack cabinet. DO NOT lay cabinet on tiled or concrete surface prior to installation  
Cabinet must be on protected surface to prevent chipping of the corners
2. Care must be taken before drilling pilot holes to avoid any existing wiring or pipe work that may be concealed.
3. A certified electrician must perform all work. The mirror must be connected to a GFI

### INSTALLATION

Please refer the installation diagram on next two installations manual.

- 1) Unpack the medicine cabinet and prepare tools needed. (See Pic.1)
- 2) Use the tape measure the height, and draw the horizontal. Measure the distance of the mirror hole, and mark the hole place on the wall. (See Pic.2)
- 3) Drill holes, and put in the plastic expansion bolt, then fix the aluminum bar by screws (See Pic.3 & Pic.4);
- 4) Hang the cabinet on the wall; don't remove your hands until its safety. (See Pic.5)
- 5) Connect the lower end of wall with the cabinet body by using the corner brace. (See Pic.6)

### MAINTENANCE

Wipe clean with a soft damp cloth. Apply glass cleaner to cloth and do not apply directly to mirror

Never use abrasive cleaners as these could damage the finish.

# INSTALLATION DIAGRAM

- 1 Unpack the medicine cabinet and prepare tools needed.

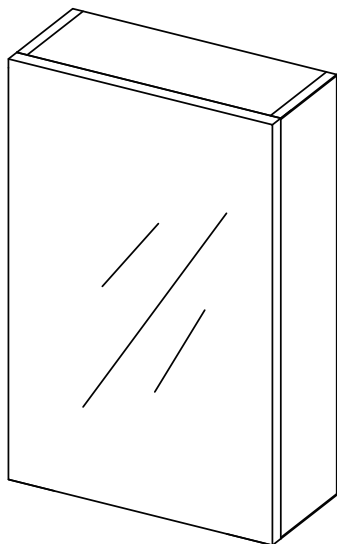

- 2 Measure and mark the back mounting holes on the wall.

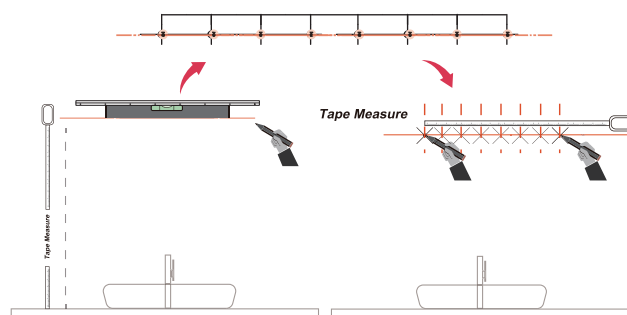

Draw horizontal line connecting the marked location. The line should be level. Adjust to level if necessary.

- 3 Drill holes, and put in the plastic expansion bolt.

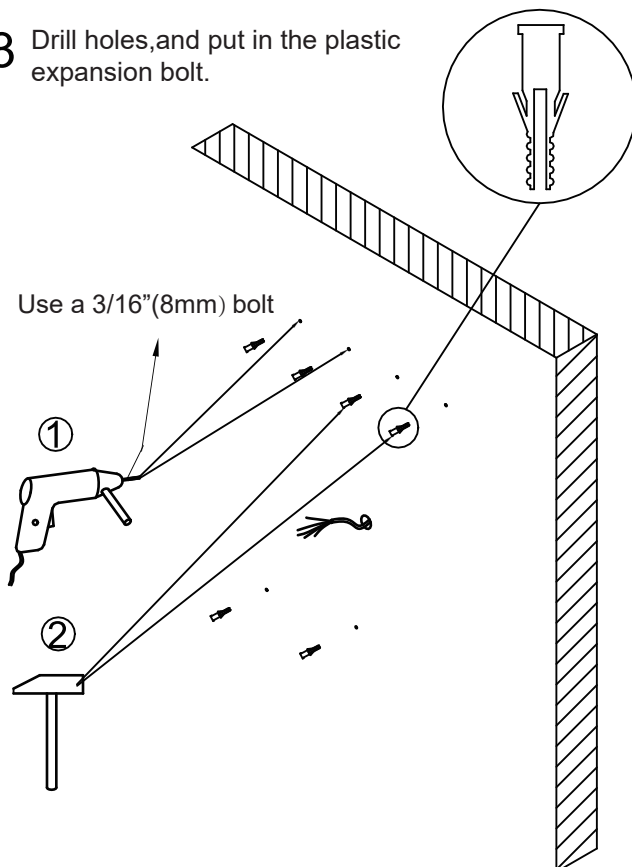

- 4 Fix the aluminum bar by screws

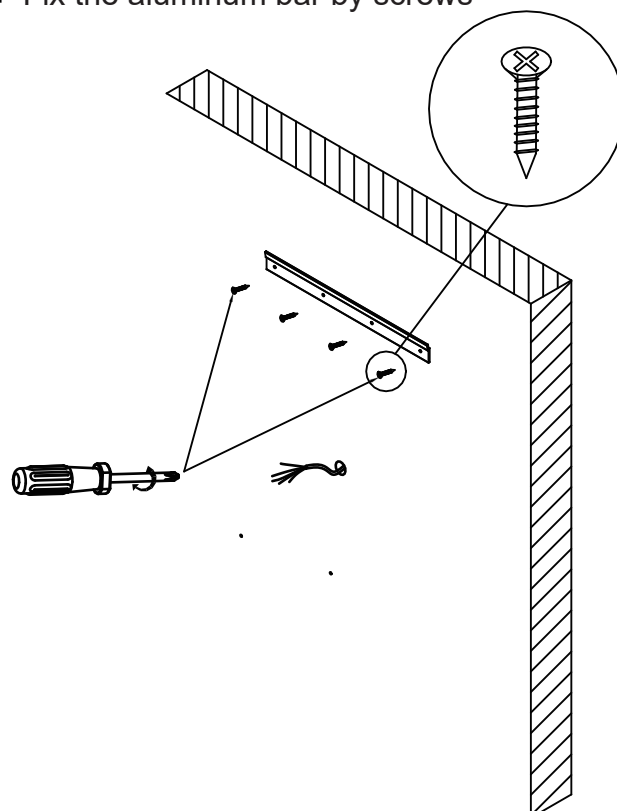

- 5 Hang the cabinet on the wall; don't remove your hands until its safety.

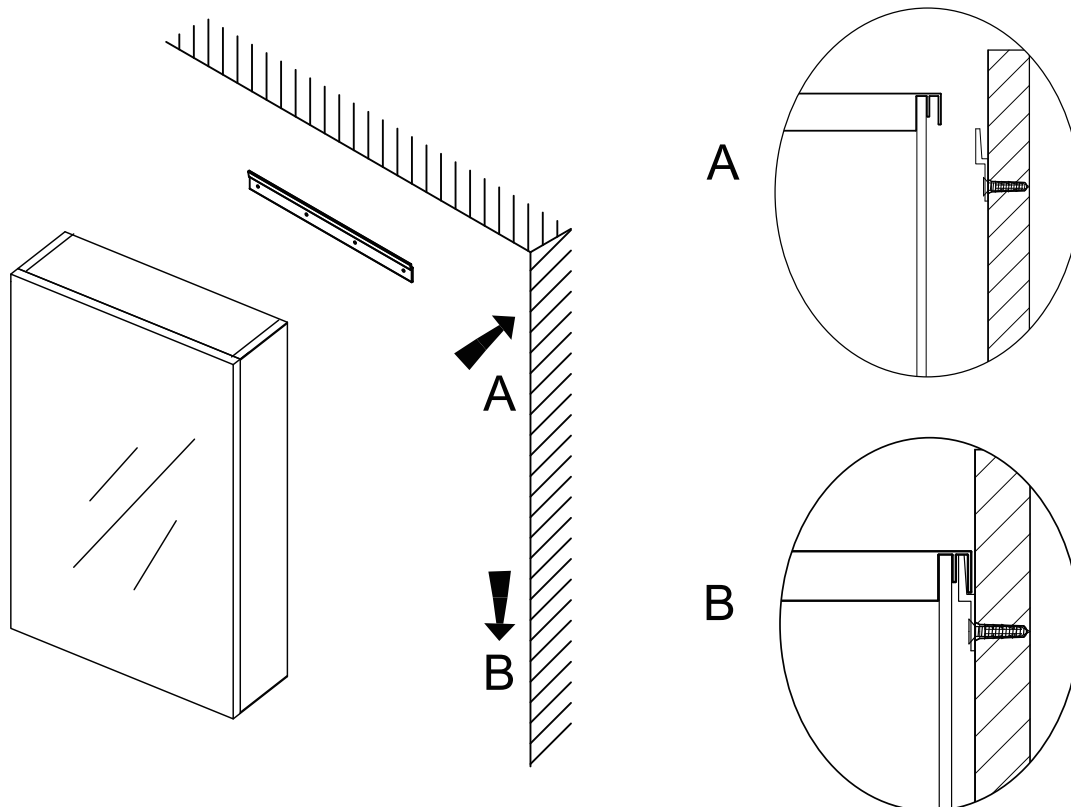

- 6 Connect the lower end of wall with the cabinet body by using the corner brace.

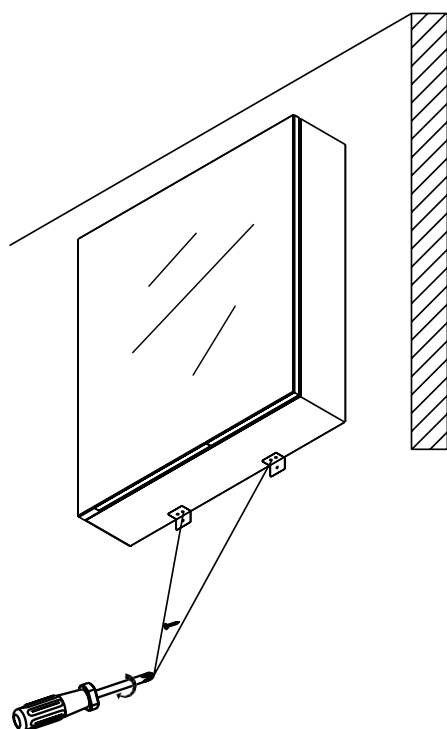

## 7 Hinge adjustment

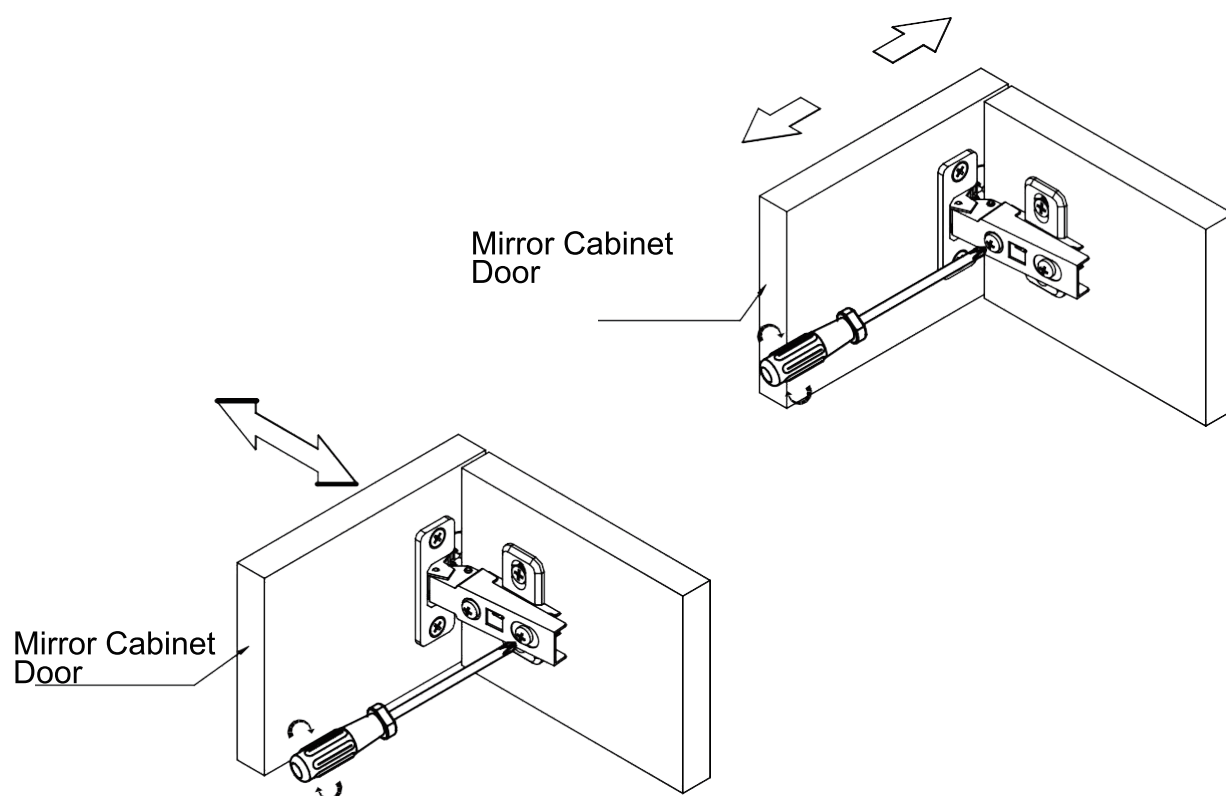
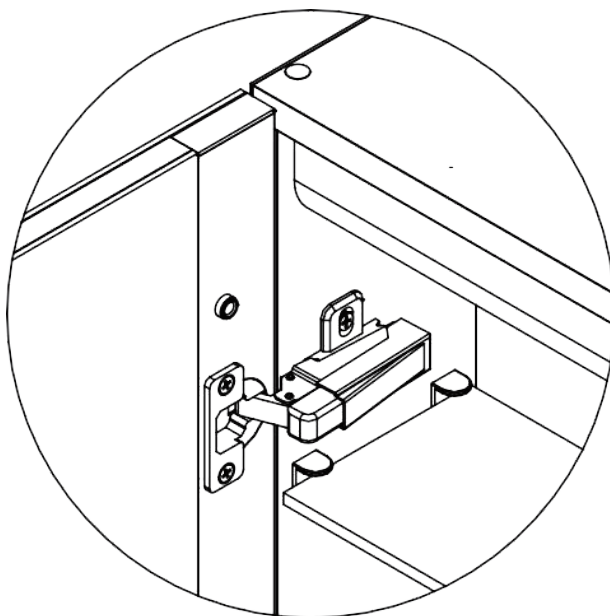

## Removing door latch:

1. Take off the hinge cover(1).
2. Press down forcefully on the rear end of the hinge chain arm(2).

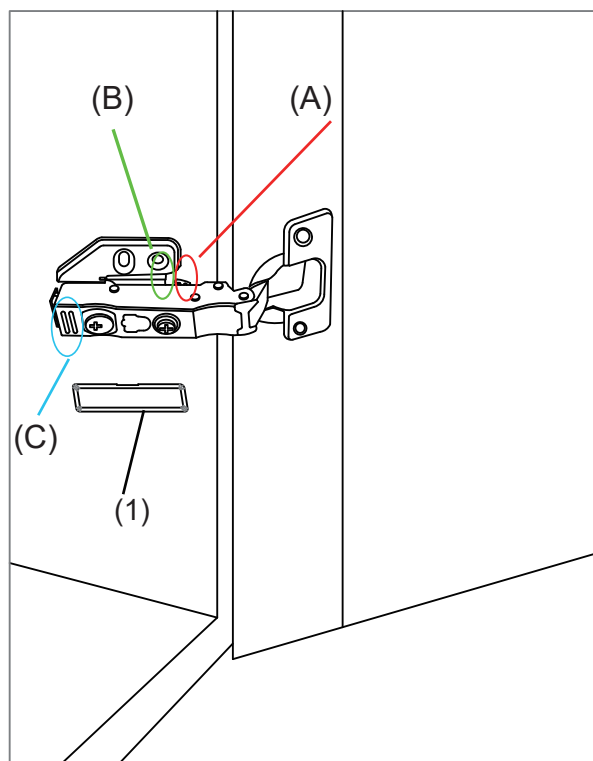
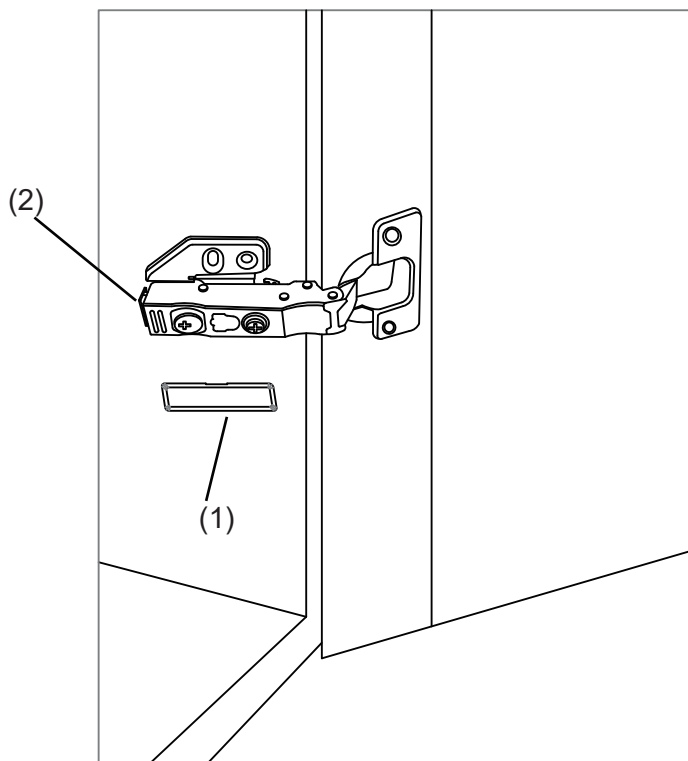

## Installing door latch:

1. Attach the hook of the hinge arm to the hinge base. (Red hook(A) onto green catch(B) )
2. Press down firmly on the rear end of the hinge arm.  
(Using strong force, push down on the blue section(C) )
3. Put on the hinge cover(1).

## Adjust the shelf to suitable position.

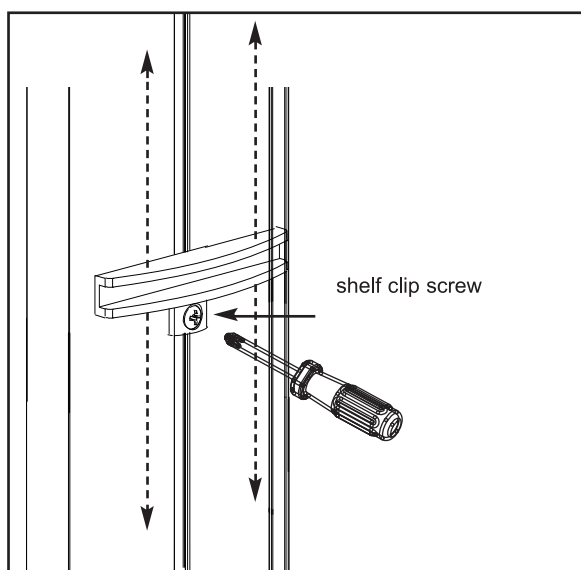

sider for adjustable shelyes,  
unscrew and adjust the position  
of shelf directly and then  
tighten the screw for mixed.

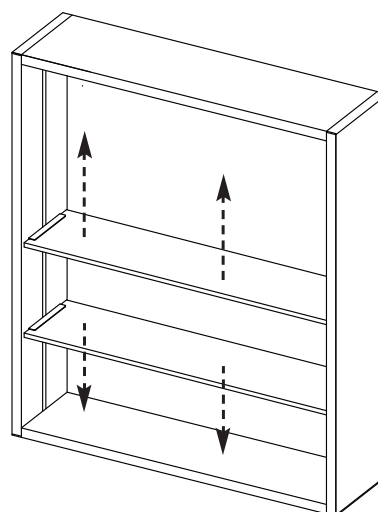

adjustable glass shelves

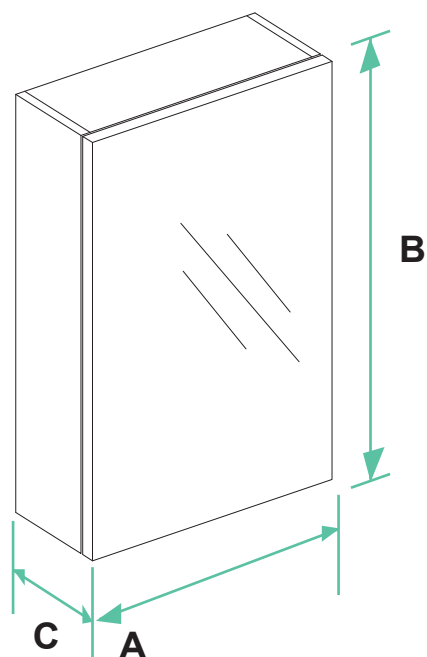

**A** - Width  
**B** - Height  
**C** - Depth

MODELS	A	B	C
S18W265HB	18	26.75	5.5

Unit: Inch

*Note: All dimensions & specifications are approximate and subject to change without notice.*

### Customer Service:

For any questions or queries regarding our products, please contact our support team:

customerservice@tunuo.net

or call 719-259-2880

Visit our website for more information <https://tunuo.net>