



BH35200V USER MANUAL

ONEPWR® TOWER FOR EMERGE CORDLESS STICK VACUUM

THIS PRODUCT IS INTENDED FOR HOUSEHOLD USE ONLY. IF USED COMMERCIALY WARRANTY IS VOID.

VERSIÓN EN ESPAÑOL: PUEDE ENCONTRAR LA VERSIÓN EN ESPAÑOL DE ESTE MANUAL EN HOOVER.COM EN ESTA PÁGINA DE PRODUCTOS.
© 2022 TECHTRONIC FLOOR CARE TECHNOLOGY LIMITED. ALL RIGHTS RESERVED. DISTRIBUTED BY, ROYAL APPLIANCE MFG. CO. CHARLOTTE, NC 28262

IMPORTANT SAFETY INSTRUCTIONS
SAVE THESE INSTRUCTIONS

READ ALL SAFETY WARNINGS AND INSTRUCTIONS BEFORE USING THIS CHARGER:

- WARNING:** WHEN USING AN ELECTRICAL PRODUCT, CERTAIN BASIC PRECAUTIONS SHOULD ALWAYS BE FOLLOWED TO AVOID ELECTRIC SHOCK, FIRE, AND/OR SERIOUS INJURY, INCLUDING THE FOLLOWING:
- Fully assemble product prior to use.
 - Do not use charger outdoors.
 - Dry location use only.
 - Do not allow to be used as a toy. Not intended for use by children age 12 and under. Close supervision is necessarywhen used by or near children. To avoid injury or damage, keep children away from product, and do not allow childrento place fingers or other objects into any openings.
 - Use only as described in this user’s manual.
 - For use with Emerge Cordless Stick Vacuum and ONEPWR™ Batteries. Charge only battery packs listed in Compatible Battery Packs Section of this User’s Manual. Charging any other battery packs may create a risk of injury or fire.
 - Do not use with damaged cord or plug. If charger is not working as it should, has been dropped, damaged, left outdoors, or dropped into water, call Customer Service at 1-800-406-2005.
 - Do not pull or carry by cord, use cord as a handle, or pull cord around sharp edges or corners. Keep cord away from heated surfaces.
 - Do not unplug by pulling on cord. To unplug, grasp the plug, not the cord.
 - Do not handle charger, plug, or charger terminals with wet hands.
 - Follow all charging instructions and do not charge the battery pack outside of the temperature range specified in the charging instructions. Charging improperly or at temperatures outside of the specified range may damage the battery and increase the risk of fire.
 - Do not disassemble charger. Do not modify or attempt to repair the charger. This charger has no serviceable parts. Call Customer Service at 1-800-406-2005.
 - Follow all mounting instructions. Failure to do so could result in personal injury or property damage. Manufacturer is not responsible for damage or injury caused by incorrect installation.

WARNING: RISK OF FIRE, PROPERTY DAMAGE, AND INJURY. NEVER EXPOSE YOUR BATTERY PACK OR CHARGER TO WATER, MOISTURE, OR FLUIDS, INCLUDING BUT NOT LIMITED TO CORROSIVE OR CONDUCTIVE FLUIDS, OR ALLOW FLUIDS TO FLOW INSIDE THESE ITEMS. Corrosive or conductive fluids, such as salt water, chlorine, certain industrial chemicals, and bleach or bleach containing products, etc., can cause a short circuit in the battery pack. If your battery pack is exposed to a corrosive or conductive fluid, do not attempt to use or charge the battery pack and immediately perform the following steps:

- Wear appropriate personal protective equipment, including eye protection and rubber gloves.
- Place your exposed battery pack in a large bucket, such as a 5 gallon or similar bucket, and fill the bucket with regular tap water. Do not place more than two packs in the bucket.
- Locate the bucket outdoors in an area inaccessible to children and pets and away from all buildings, garages/sheds, structures, vehicles, and combustible/flammable materials.
- Leave the battery pack(s) in the bucket filled with tap water and call Customer Service at 1-800-406-2005 for additional instructions on the proper disposal of the exposed battery pack(s).

ASSEMBLY

WARNING: To prevent risk of strangulation, fire, or shock, route cord properly, avoiding loops, is out of the reach of children, and where they cannot get snagged or pulled.

1. Lay base on flat ground.
2. Insert end of pole (with connector) into base.
3. Connect the two poles together.
4. Insert charger head into top of pole.
5. Attach power cord to charger head.
6. Press Power cord into hidden channel.
7. Continue pressing power cord into channel down the back of the pole.
8. Connect Hoover® power supply to outlet.
9. Clip tool accessory onto pole.

WARNING: Fully assemble or install product prior to use.

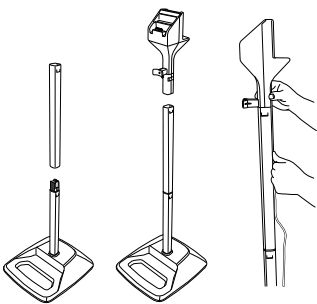

Figure 1
figure 1
Figura 1

OPERATION

APPLICATIONS

You may use this product for the following purpose: Charging ONEPWR® Lithium Ion Batteries.

CAUTION: When not in use, place stand on its side on a stable surface where it will not cause a tripping or falling hazard. A stand with a large battery pack will stand upright but may be easily knocked over.

CHARGING (Figure 2)

- Charge the battery fully before first use. This will take up to 4 hours. In accordance with federal regulations, the battery does not come fully charged.
- Make sure the power supply is normal household voltage, 120 volts, AC only, 60 Hz.
- Do not place the charger in an area of extreme heat or cold. It will work best at normal room temperature.
- Plug the charger into a power outlet.
- Place Emerge Cordless Stick Vacuum in self-standing position.
- The battery inserted into the Emerge Cordless Stick Vacuum will charge first.
- Attach the battery pack to the charger by aligning the ribs on the battery pack to the grooves in the charger. Slide the battery pack into the charger. Note: The battery on the Emerge will charge while docked as well as the spare on the back.
- The battery pack will become slightly warm to the touch while charging. This is normal and does not indicate a problem.
- When charging, the lights on the battery will illuminate to show the state of charge. The light on the charger will flash.
- If the light on the charger flashes red, there is an error with the battery or the charger. Try again or call customer service for support.
- When the charge is complete the lights on the battery and charger will turn off.
- To remove the battery pack from the charger, press the latches and pull up on the battery pack.
- During charging, the pack and ambient temperature should be between 41 to 86°F (5 and 30°C).
- Do not charge battery in a damp or wet location. Do not use, store, or charge battery packs or products in locations where the temperature is less than 50° F or more than 100° F. Do not store outside or in vehicles.
- The charger will sense if the pack, or ambient temperature, is too cold or too hot, and will return an error code (red light will remain on) and not charge the pack until ambient temperature is reached.

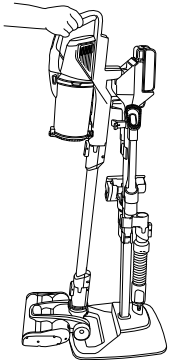

Figure 2
figure 2
Figura 2

MAINTENANCE

- Do not disassemble charger. Do not modify or attempt to repair the charger. This charger has no serviceable parts. For available replacement parts, call Customer Service at 1-800-406-2005.

If charger is not working as it should, has been dropped, damaged, left outdoors, or dropped into water, call customer service at 800.406.2005 prior to continuing use.
This product contains no serviceable parts. Call 1-800-406-2005 for Customer Service.

MODE	BATTERY PACK	RED LED ON CHARGER	WHITE LED ON CHARGER	ACTION NEEDED
POWER	Without Battery Pack	On for 3 seconds	On for 3 seconds	Ready to charge battery pack
TESTING	HOT Battery Pack	ON	OFF	When battery pack reaches normal temperature, charger begins charge mode
	COLD Battery Pack	ON	OFF	When battery pack reaches normal temperature, charger begins charge mode
DEFECTIVE	Defective	Flashing	OFF	Battery pack or charger is defective
• If defective, try to repeat the conditions a second time by removing and reinstalling the battery pack. If LED status repeats a second time, try charging a different battery. • If a different battery charges normally, dispose of the defective pack • If a different battery also indicates “Defective”, the charger may be defective.				
CHARGING	Charging – LED lights will flash depending on charge level	OFF	Flashing	Battery is being charged
FULLY CHARGED	Charged – lights will go off	OFF	LED lights will remain on	Charging is complete; charger maintains charge mode

COMPATIBLE BATTERY PACKS: ONEPWR® BATTERY PACKS	
Battery:	Model #
2.0 Ah	BH15020
3.0 Ah	BH15030, BH25030
4.0 Ah	BH15240, BH25040
8.0 Ah	BH25280

SERVICE INFORMATION & LIMITED WARRANTY FOR ONEPWR BATTERIES

THREE YEAR LIMITED WARRANTY (DOMESTIC USE)

If this product is not as warranted, contact TTI Floor Care North America Customer Service at 1-800-406-2005. Please have available the proof of purchase and model number for the warranted product. Failure to register the product does not diminish product warranty rights.

WHAT THIS LIMITED WARRANTY COVERS: This limited warranty provided by Royal Appliance Mfg. Co., doing business as TTI Floor Care North America (referred to hereafter as “Warrantor”) applies only to products purchased in the U.S. (including its territories and possessions), a U.S. Military Exchange, or Canada. When used and maintained in normal household use and in accordance with the User Manual, your ONEPWR charger is warranted against original defects in material and workmanship for three years from the date of original purchase (the “Warranty Period”). If Warrantor determines that the issue you are experiencing is covered under the terms of this warranty (a “covered warranty claim”), we will, at our sole discretion and free of charge (subject to the cost of shipping), either (i) repair your product, (ii) ship you a replacement product, subject to availability; (iii) in the event that the applicable parts or replacement are not reasonably available, ship you a similar product of equal or greater value; or (iv) issue you a store credit (if applicable) or a refund of the actual purchase price at the time of the original purchase, as reflected on the original sales receipt. Parts and replacements may be new, refurbished, lightly used, or remanufactured, in Warrantor’s sole discretion.

WHO THIS LIMITED WARRANTY COVERS: This limited warranty extends only to the original retail purchaser, with original proof of purchase from Warrantor or an authorized dealer of Warrantor products, in the U.S., U.S. Military Exchanges, and Canada.

WHAT THIS LIMITED WARRANTY DOES NOT COVER: This warranty does not cover use of the product in a commercial operation (such as maid, janitorial, and equipment rental services, or any other income-generating activity); improper maintenance of the product; the product if it has been subject to misuse, negligence, neglect, vandalism, or the use of voltages other than that on the data plate of this product. This warranty does not cover damage resulting from an act of God, accident, owner’s acts or omissions, service of this product by other than Warrantor or a Warrantor authorized service provider (if applicable), or other acts beyond the control of Warrantor. This warranty also does not cover use outside the country in which the product was initially purchased, or resale of the product by the original owner. Pick-up, delivery, transportation, and house calls are not covered by this warranty. In addition, this warranty does not cover any product that has been altered or modified; repairs made necessary by normal wear; or the use of products, parts, or accessories which are either incompatible with this ONEPWR charger or adversely affect its operation, performance, or durability. Normal wear items (if applicable) are not covered under this warranty.

OTHER IMPORTANT TERMS: This warranty is not transferable and may not be assigned; any assignment made in contravention of this prohibition is void. This warranty shall be governed and construed under the laws of the state of North Carolina. The Warranty Period will not be extended by any replacement of batteries or parts or repair performed under this warranty.

THIS WARRANTY IS THE EXCLUSIVE WARRANTY AND REMEDY, AND ALL EXPRESS AND IMPLIED WARRANTIES OTHER THAN THE LIMITED WARRANTY SET FORTH ABOVE, INCLUDING IMPLIED WARRANTIES OF MERCHANTABILITY AND FITNESS FOR A PARTICULAR PURPOSE, ARE EXPRESSLY DISCLAIMED. IN NO EVENT WILL WARRANTOR BE LIABLE FOR ANY SPECIAL, INDIRECT, INCIDENTAL OR CONSEQUENTIAL DAMAGES OF ANY KIND OR NATURE TO OWNER OR ANY PARTY CLAIMING THROUGH OWNER, WHETHER BASED IN CONTRACT, NEGLIGENCE, TORT, OR STRICT PRODUCTS LIABILITY OR ARISING FROM ANY CAUSE WHATSOEVER. TO THE EXTENT PERMITTED BY APPLICABLE LAW, NO WARRANTIES THAT ARISE BY OPERATION OF LAW, IF APPLICABLE, SHALL EXCEED THE DURATION OF THE LIMITED WARRANTY PROVIDED HEREIN. Warrantor’s liability for damages to you for any costs whatsoever arising out of this statement of limited warranty shall be limited to the amount paid for this product at the time of original purchase and Warrantor shall not be liable for any direct, indirect, consequential, or incidental damages arising out of the use of or inability to use this product.

Some states do not allow the exclusion or limitation of incidental or consequential damages, disclaimers of implied warranties, or limitations on the duration of implied warranties, so the above exclusions, disclaimers, and/or limitations may not apply to you. This warranty gives you specific legal rights, and you may also have other rights, which vary from state to state.