

USE AND CARE GUIDE

SONOMA MEDICINE CABINET

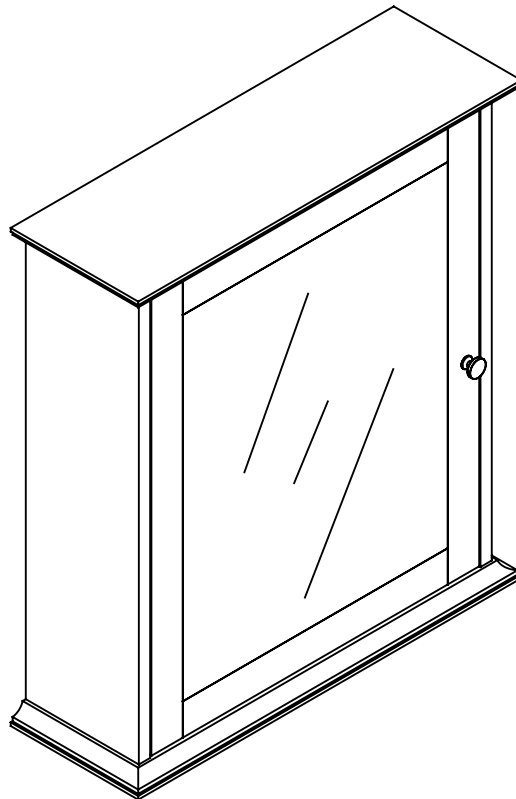

Questions, problems, missing parts?
Before returning to the store, call Home Decorators Collection Customer Service
8 a.m. - 7 p.m., EST, Monday - Friday, 9 a.m. - 6 p.m., EST, Saturday

1-800-986-3460

HOMEDEPOT.COM/HOMEDECORATORS

THANK YOU

We appreciate the trust and confidence you have placed in Home Decorators Collection through the purchase of this vanity. We strive to continually create quality products designed to enhance your home. Visit us online to see our full line of products available for your home improvement needs. Thank you for choosing Home Decorators Collection!

Table of Contents

Table Of Contents	2
Safety Information	2
Warranty	3
Warranty Information.....	3
Pre-Installation.....	3
Planning Installation	3
Tools Required	3
Package Contents	4

Installation	5
Shelf Adjustment	7
How To Adjust The Door's Position	8
Care And Cleaning	9

Safety Information



DANGER

- ☐ Keep small parts away from children during assembly.
- ☐ Failure to follow warnings and cautions could result in serious injury.
- ☐ DO NOT use harsh bathroom cleaners or grout cleaners on any natural stone.



WARNING

- ☐ Read these instructions carefully and keep in a safe place.
- ☐ Adult assembly required.
- ☐ Do not over tighten connectors (screws, bolts, etc.)
Overtightening can lead to product damage.
- ☐ Small parts may present choking hazard prior to assembly.
- ☐ Do not stand, step or climb on unit.



Caution

- ☐ USE preventative cleaning measures to keep your stone pristine.
- ☐ USE sealers according to the product specific directions.
- ☐ Blot spills quickly, and wash with mild soap and warm water.
- ☐ Be sure to check all packing materials carefully for small parts that may have come loose inside the carton during shipment. If parts are missing, contact THE HOME DEPOT to obtain any missing parts.
- ☐ Using abrasive cleansers will damage the surface.

Warranty

WARRANTY INFORMATION

Home Decorators Collection products are manufactured to meet high-quality standards and workmanship and are backed by our 1-Year Warranty. This warranty is provided to the original consumer purchaser and covers any defects in materials or workmanship under normal residential use. We will replace, free of charge, any product or parts that prove to be defective during the warranty period.

To obtain warranty service, please return the product or part to any Home Depot retail location or contact our customer service at 1-800-986-3460 to receive a replacement item. Proof of purchase (the original sales receipt) from the original consumer purchaser is required for all warranty claims.

Pre-Installation

PLANNING INSTALLATION

Check the vanity for damage before installation. If any part of the vanity is missing or damaged, contact the Customer Service Team at 1-800-986-3460.

Ensure that the vanity location is accessible to water supply and drain lines. It is suggested that you rough-in the water lines and drain before installing the vanity.



NOTE: A drain pipe and trap are not included with this vanity.

TOOLS REQUIRED



NOTE: Tools are not included.



Safety goggles



Philips screwdriver



Level

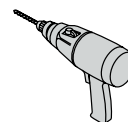

Drill



Rubber mallet



Clean rag



Pencil

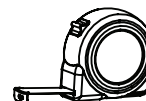

Measuring Tape

Pre-Installation (continued)

PACKAGE CONTENTS

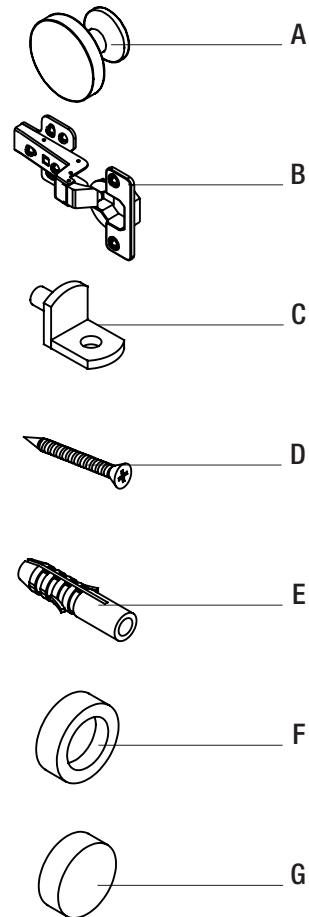
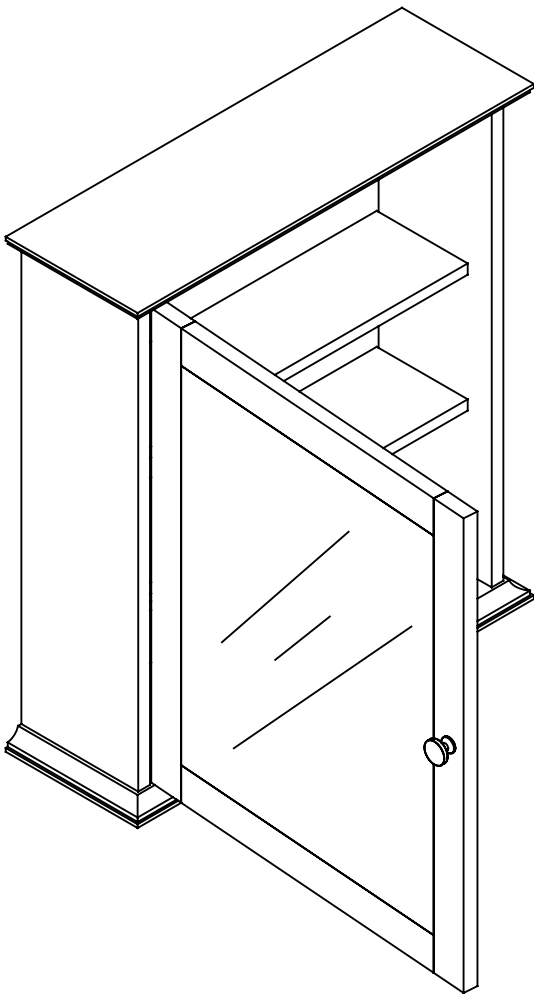

Part	Description	Quantity
A	Knob (Pre-assembled)	1
B	Door hinge (Pre-assembled)	2
C	Shelf holder (Pre-assembled)	2
D	Screw \varnothing 4.0x40mm	4
E	Wall Anchor	4
F	Fitting	4
G	Cap	4

Installation

1 Positioning for medicine cabinet

- Measure the distance between the centers of the hangers on the back of the mirror. Use a level to mark these two points on the wall.

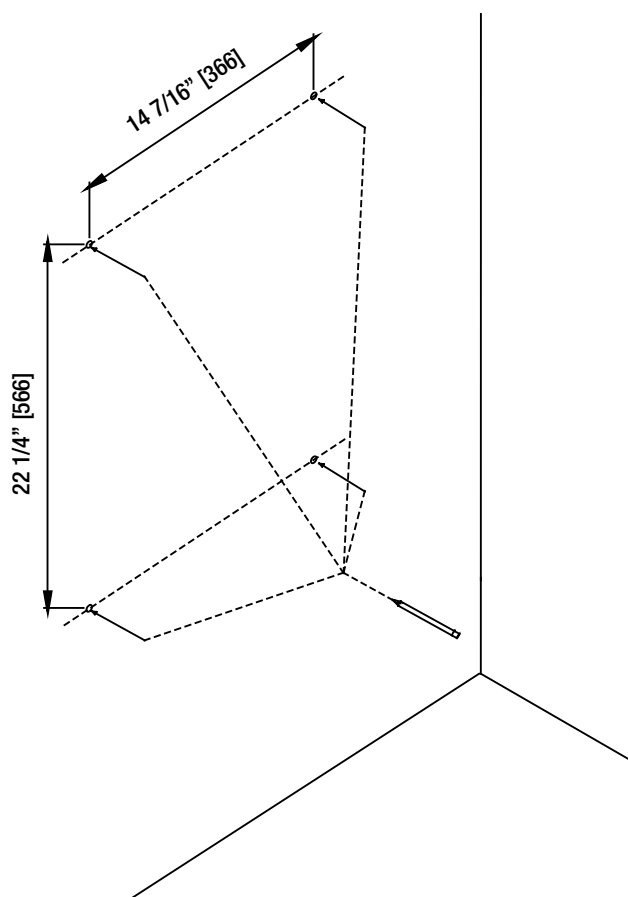

2 Drilling holes

- Gypsum wallboard or concrete walls: Drill pilot holes in the marked locations with a \varnothing 8 mm / 5/16 in drill bit. Insert the wall anchors (E) using a rubber mallet until the wall anchors are flush with the wall.
- Solid wood walls: Drill pilot holes in the marked locations with a \varnothing 2 mm / 1/16 in drill bit. Wall anchors are not necessary.



CAUTION: Wear a pair of rubber gloves to protect your hands.

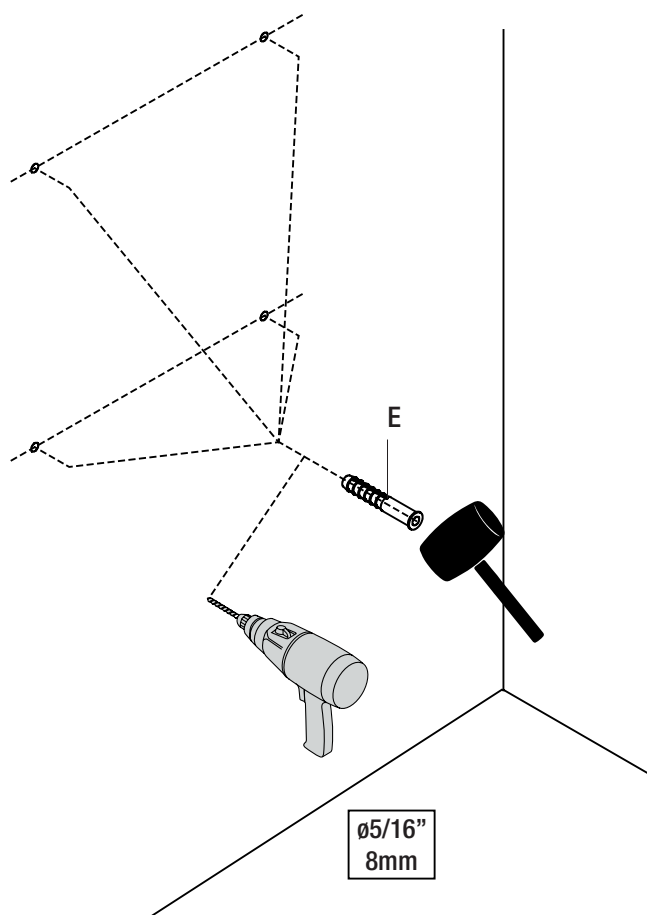

Installation (continued)

3 Securing the cabinet

- Hang on the cabinet to the wall, secure the cabinet with fittings (F), screws (D), caps (G).

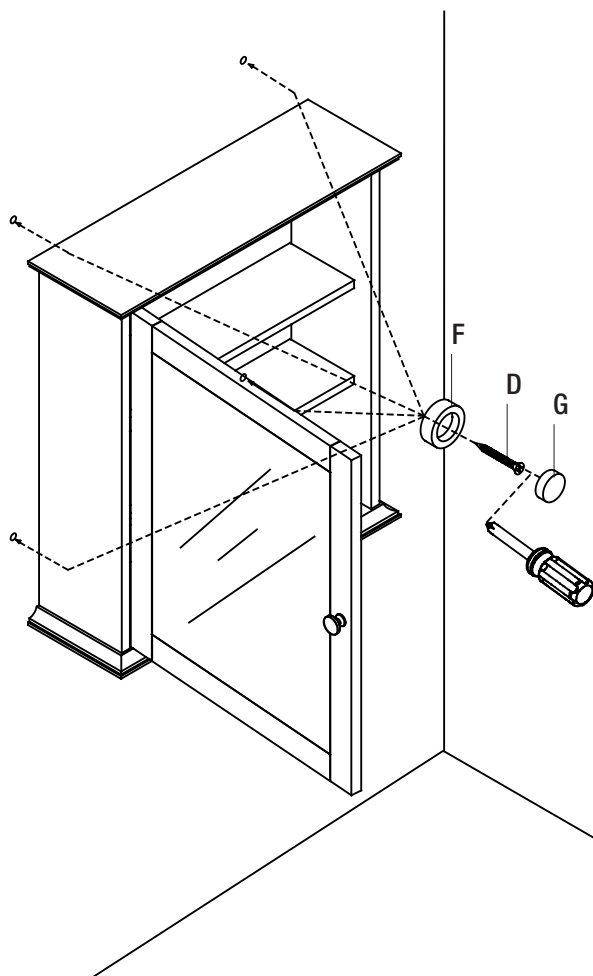

4 Installing complete

- Installation completed.

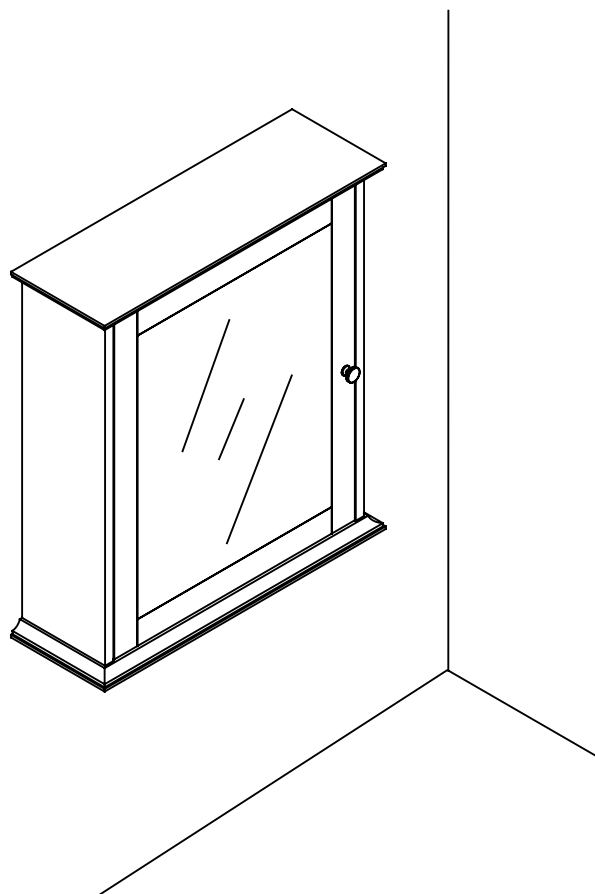

Shelf Adjustment

1 How to remove shelf

Each shelf can be removed or repositioned to create more space:

- Uninstall the screws and remove the shelf.
- Pull out the shelf holders.

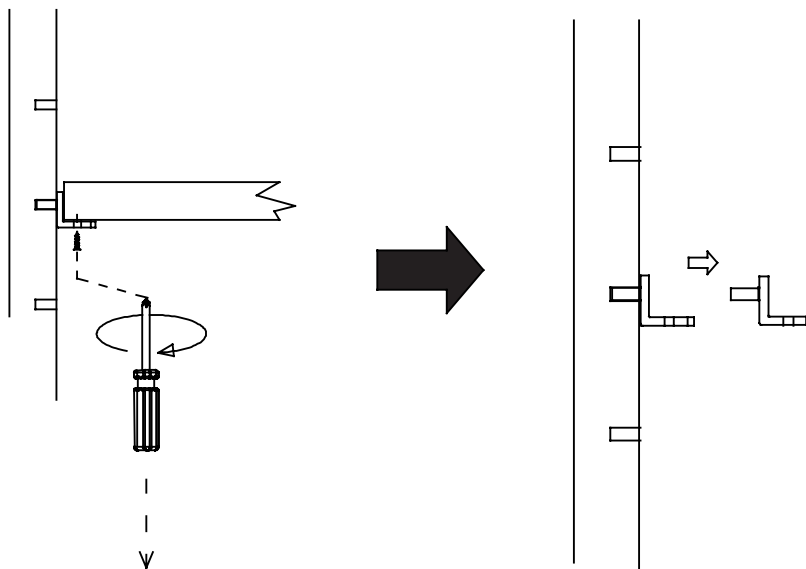

2 How to install shelf

- Select your desired location and push the shelf holder into place on both the right and left sides.
- Place the shelf onto the shelf holders. Make sure the shelf is properly level, and use screws to secure the shelf to the shelf holder.

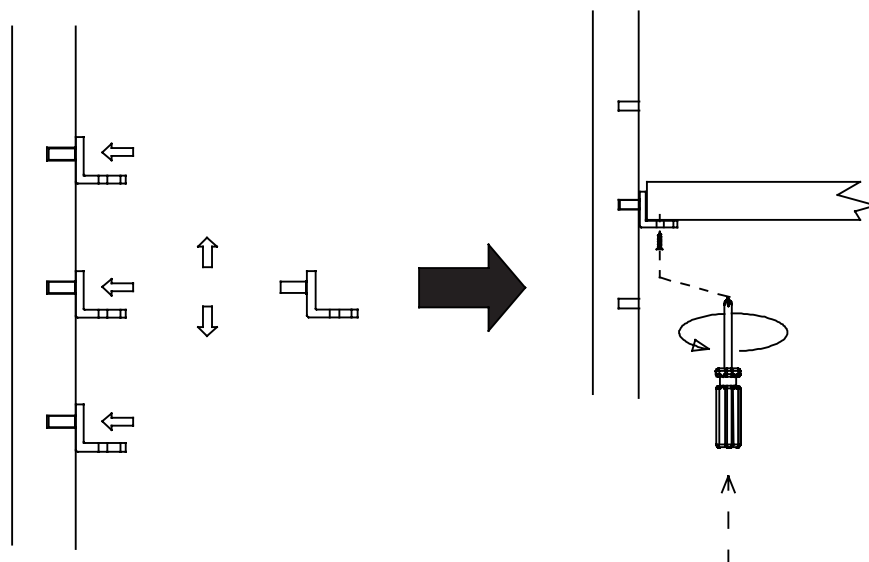

How to adjust the door's position

1 Door's in and out adjustment

- To adjust the door front In and Out in-depth, loosen screw (AA), align the door, and tighten screw (AA).

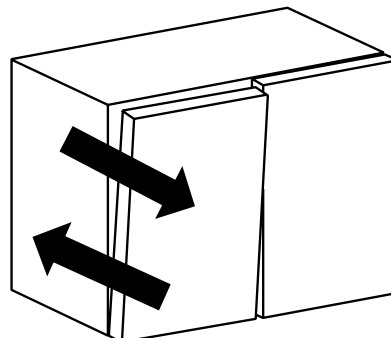
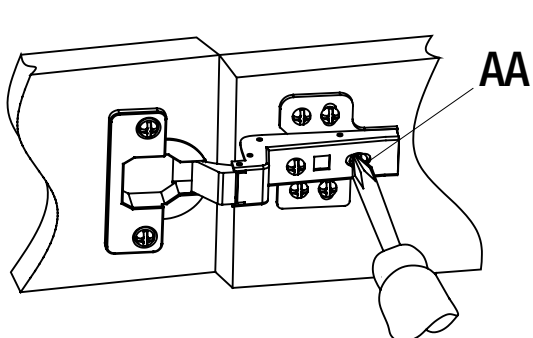

2 Door's left and right adjustment

- To adjust the door front Left and Right, rotate the adjustment screw (BB).

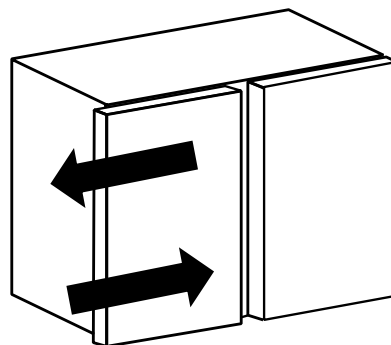
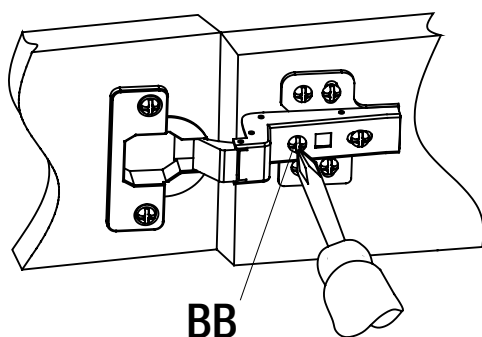

Care and Cleaning

- For daily maintenance, use a wet cloth and a soft liquid cleaner.
- Never use abrasive cleaners or strong bleach, scrapers, metallic brushes, or other objects or any products which can graze or tarnish surfaces.

The logo for Home Decorators Collection is centered on a dark gray rectangular background. It features the word "HOME" in a large, white, serif font. Below it, the word "DECORATORS" is written in a smaller, white, sans-serif font. At the bottom, the word "COLLECTION" is written in an even smaller, white, sans-serif font, followed by a registered trademark symbol (®).

HOME DECORATORS COLLECTION®

Questions, problems, missing parts?
Before returning to the store, call Home Decorators Collection Customer Service
8 a.m. - 7 p.m., EST, Monday - Friday, 9 a.m. - 6 p.m., EST, Saturday

1-800-986-3460

[HOMEDEPOT.COM/HOMEDECORATORS](https://www.homedepot.com/homedecorators)

Retain this manual for future use.