

# HAMPTON BAY®

## USE AND CARE GUIDE

### VANITY DRAWER BASE DRAWERS BASE /COOK TOP BASE CABINET

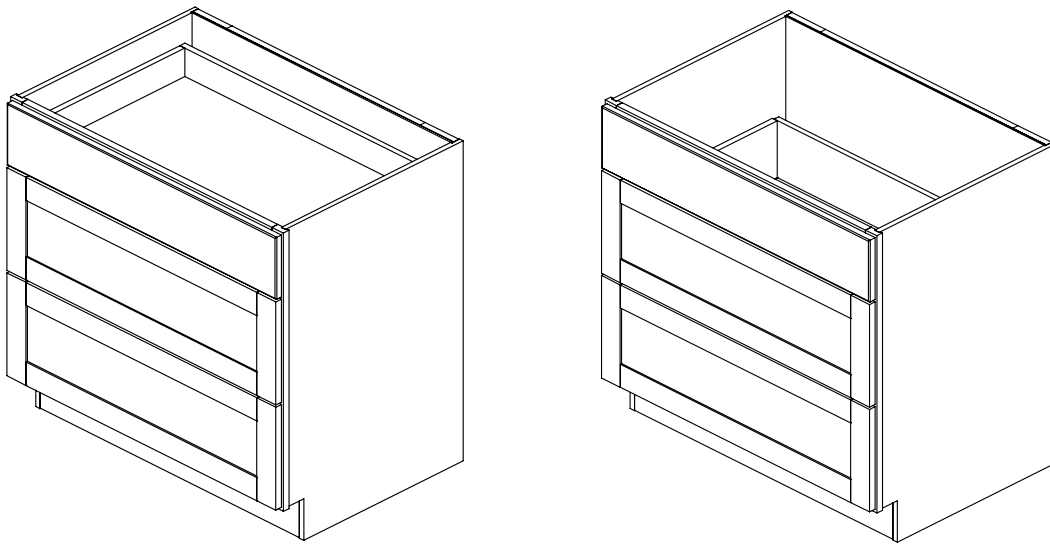

Questions, problems, missing parts? Before returning to the store,  
call Hampton Bay Customer Service  
8 a.m. – 7 p.m., EST, Monday – Friday, 9 a.m. – 6 p.m., EST, Saturday

1-855-HD-HAMPTON

HAMPTONBAY.COM

---

#### THANK YOU

*We appreciate the trust and confidence you have placed in Hampton Bay through the purchase of this Cabinet. We strive to continually create quality products designed to enhance your home. Visit us online to see our full line of products available for your home improvement needs. Thank you for choosing Hampton Bay!*

# Table of Contents

Table of Contents .....2

Safety Information.....2

    CALIFORNIA RESIDENTS.....2

    MINNESOTA RESIDENTS .....2

Warranty .....2

Introduction to CLICKREADY Technology .....3

Pre-Assembly .....4

    BEFORE YOU BEGIN.....4

    PEOPLE REQUIRED .....4

    TOOLS REQUIRED .....4

    HARDWARE INCLUDED .....4

Pre-Assembly ..... 5

    PACKAGE CONTENTS.....5

Cabinet Assembly ..... 6

Cabinet Assembly (Continued) ..... 8

Drawer Assembly ..... 10

Cabinet Assembly (Continued) ..... 11

Before Putting in Use ..... 13

Care and Cleaning ..... 14

# Safety Information

Please read and understand these instructions before you begin this assembly.

## CALIFORNIA RESIDENTS



WARNING: This product can expose you to chemicals including Formaldehyde (GAS), which is [are] known to the State of California to cause cancer. For more information go to [WWW.P65Warnings.ca.gov/products](http://WWW.P65Warnings.ca.gov/products).

## MINNESOTA RESIDENTS

### IMPORTANT HEALTH NOTICE

SOME OF THE BUILDING MATERIALS USED IN THIS HOME (OR THESE BUILDING MATERIALS) EMIT FORMALDEHYDE. EYE, NOSE, AND THROAT IRRITATION, HEADACHE, NAUSEA AND A VARIETY OF ASTHMA-LIKE SYMPTOMS, INCLUDING SHORTNESS OF BREATH, HAVE BEEN REPORTED AS A RESULT OF FORMALDEHYDE EXPOSURE. ELDERLY PERSONS AND YOUNG CHILDREN, AS WELL AS ANYONE WITH A HISTORY OF ASTHMA, ALLERGIES, OR LUNG PROBLEMS, MAY BE AT GREATER RISK. RESEARCH IS CONTINUING ON THE POSSIBLE LONG-TERM EFFECTS OF EXPOSURE TO FORMALDEHYDE.

REDUCE VENTILATION MAY ALLOW FORMALDEHYDE AND OTHER CONTAMINANTS TO ACCUMULATE IN THE INDOOR AIR. HIGH INDOOR TEMPERATURES AND HUMIDITY RAISE FORMALDEHYDE LEVELS. WHEN A HOME IS TO BE LOCATED IN AREAS SUBJECT TO EXTREME SUMMER TEMPERATURES, AN AIR-CONDITIONING SYSTEM CAN BE USED TO CONTROL INDOOR TEMPERATURE LEVELS. OTHER MEANS OF CONTROLLED MECHANICAL VENTILATION CAN BE USED TO REDUCE LEVELS OF FORMALDEHYDE AND OTHER INDOOR AIR CONTAMINANTS.

IF YOU HAVE ANY QUESTIONS REGARDING THE HEALTH EFFECTS OF FORMALDEHYDE, CONSULT YOUR DOCTOR OR LOCAL HEALTH DEPARTMENT.

# Warranty

Contact the Customer Service Team at 1-855-HD-HAMPTON or visit [www. Hamptonbay.com](http://www.Hamptonbay.com).

# **CLICK READY™** 101

## Introduction to **CLICKREADY** Technology

Powered by **OVVO**



This cabinet uses **PERMANENT** Ready to Assemble (RTA) technology that **CANNOT** be disassembled. You must carefully review instructions and ensure proper alignment during assembly.

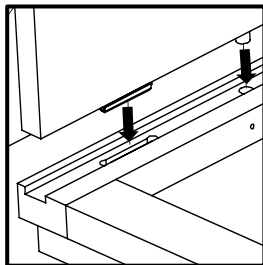

All connectors and dowels must line up when assembling cabinet.

Quantity of connectors/dowels depends on the cabinet type and size.

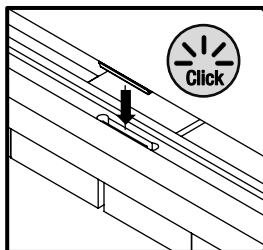

There will be a “clicking” sound when the connectors lock together properly.

**BEFORE INSTALLATION, ENSURE ALL CONNECTORS ARE LOCKED IN PLACE AND SEATED.**

# Pre-Assembly

## BEFORE YOU BEGIN

Compare all parts with the Hardware Included and Package Contents sections. If any part is missing or damaged, do not assemble this product. Contact Customer Service.

Assemble the cabinet on a soft surface such as carpet or the cardboard container of this product.

## PEOPLE REQUIRED



BASE CABINETS with a width greater than or equal to 27" , CORNER WALL CABINET, LAZY SUSAN CABINET, PANTRY, OVEN CABINET require two people to assemble.

## TOOLS REQUIRED



Rubber  
mallet

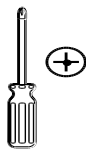

Phillips  
screwdriver

## HARDWARE INCLUDED



**NOTE:** Hardware not shown to actual size.

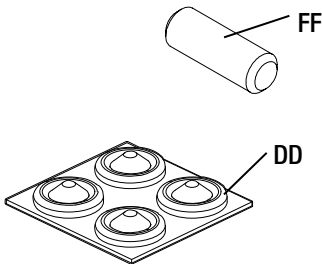
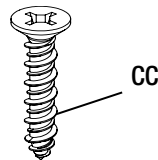
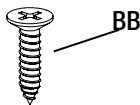
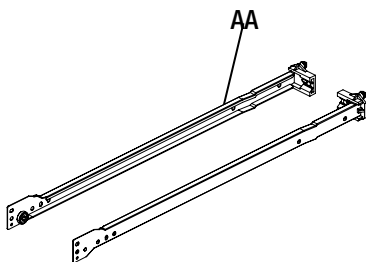

*\* Extras quantity is provided based upon your cabinet size/type*

Part	Description	Qty. Drawer Base Cabinet	Qty. Cooktop Base Cabinet
AA	Cabinet Glides	3	2
BB	M4 x 15 mm Screws (silver)	6	4
CC	#8 x 1 in. Screws (yellow)	12	8
DD	Silicone Pads	12	8
FF	Wooden dowel	2	2

# Pre-Assembly

## PACKAGE CONTENTS

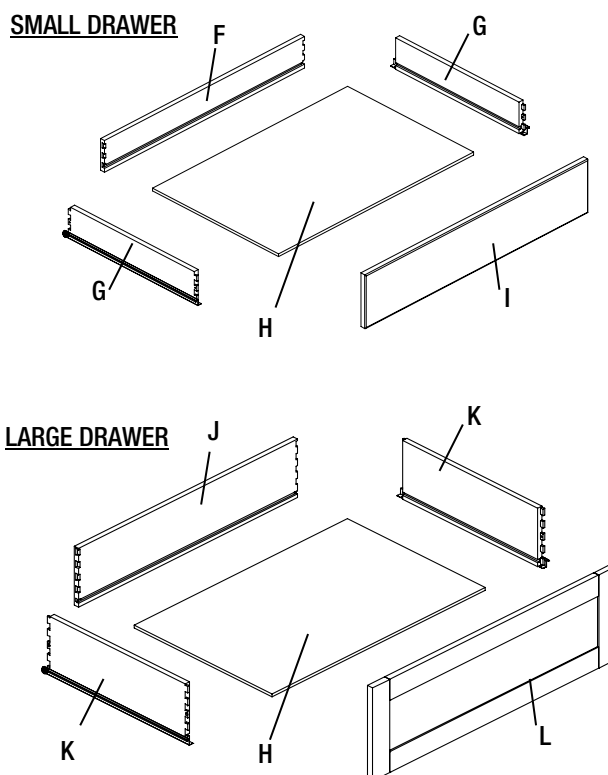
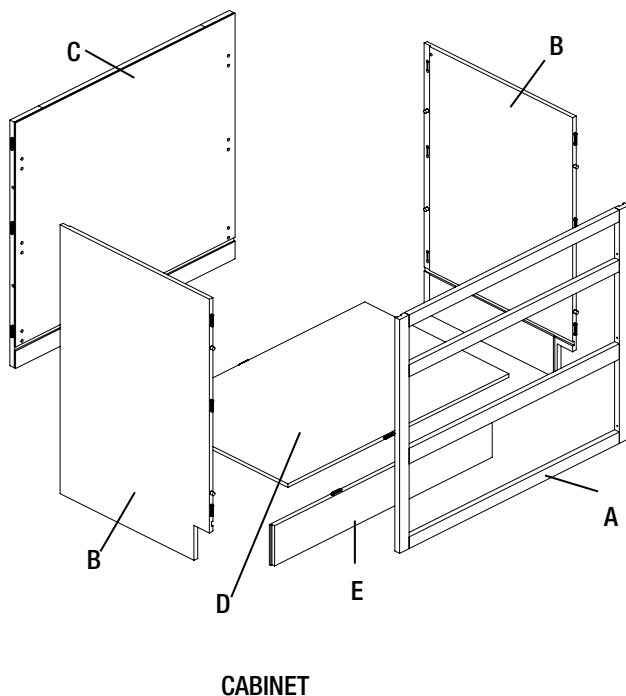

**NOTE:** The quantity of connectors which are preassembled on the panels depend on its size and type

Part	Description	Qty. Drawer Base Cabinet	Qty. Cooktop Base Cabinet
<b>CABINET</b>			
A	Face Frame and Doors	1	1
B	Side Panel	2	2
C	Back Frame	1	1
D	Bottom Panel	1	1
E	Toe Kick	1	1

<b>DRAWER</b>			
F	Small Drawer Back	1	0
G	Small Drawer Side	1	0
H	Drawer Bottom	3	2
I	Small Drawer Front	1	0
J	Large Drawer Back	2	2
K	Large Drawer Side	4	4
L	Large Drawer Front	2	2

# Cabinet Assembly

## 1 Attaching the side panels into the face frame

- Start by placing the face frame (A) flat on a smooth surface that will not scratch or damage the face of the cabinet, such as a towel or piece of cardboard (1) from the packaging.
- Install the two side panels (B) into the mating grooves on the face frame (A) by: aligning the wooden dowels & male connectors on side panel (B) to the holes & female connectors on face frame (A).
- Use both hands to firmly press the side panels (B) down at all locations with connectors to ensure they lock together tightly.



**IMPORTANT:** There will be a “clicking” sound when the connectors lock together properly.

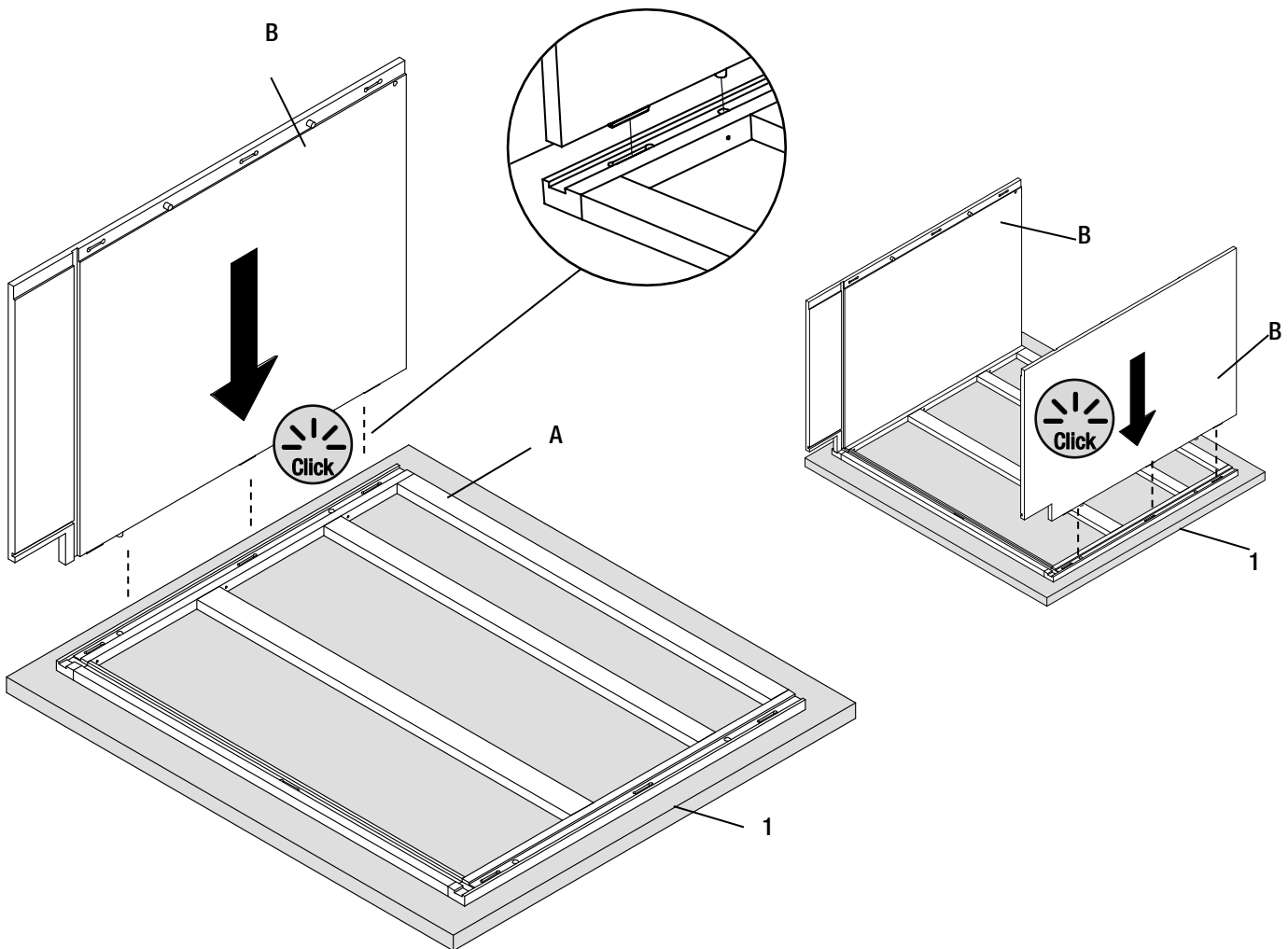

# Cabinet Assembly

## 2 Attaching the bottom panel for all cabinets

- Slide the bottom panel (D) into grooves in the sides (B). Use both hands to firmly press the panel (D) down at all locations with connectors to ensure they lock together tightly.



**NOTE:** Make sure the female connector on the bottom panel (D) is facing out.

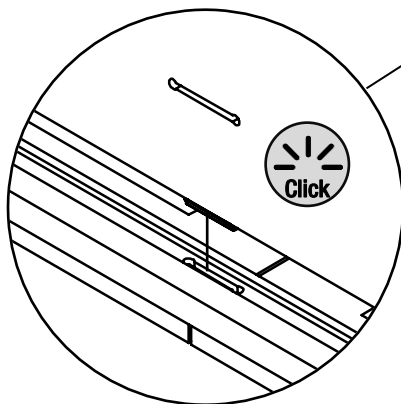
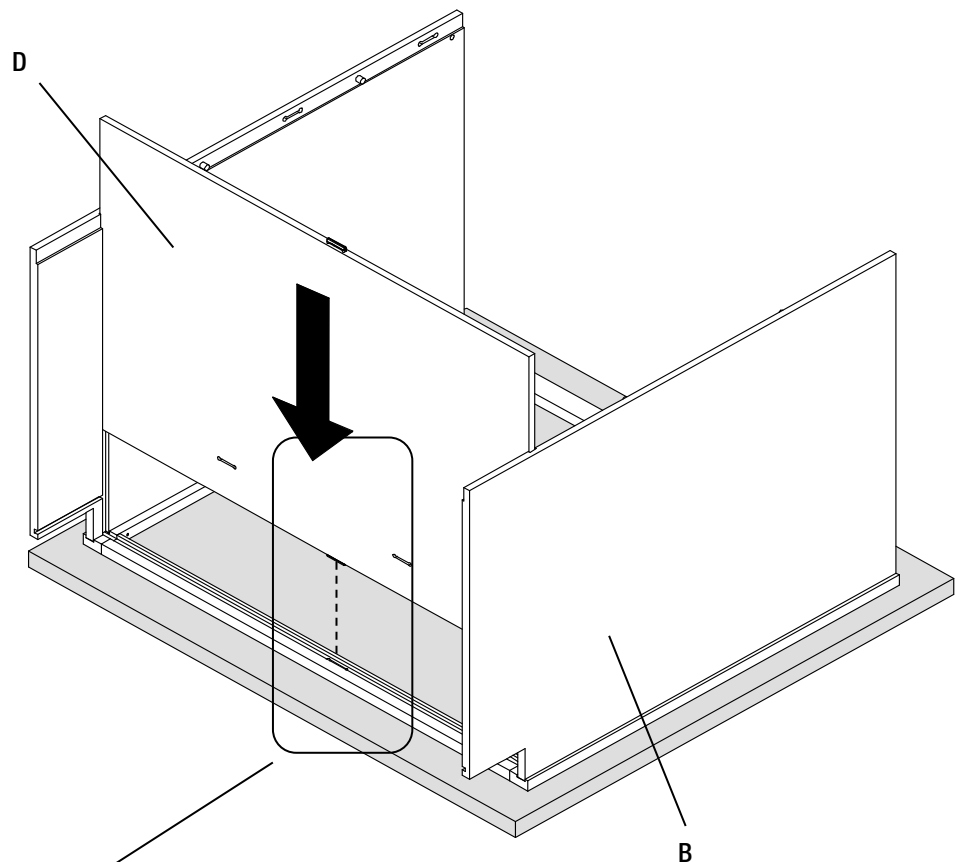
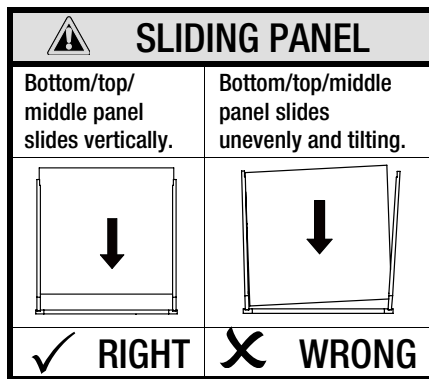

## Cabinet Assembly (Continued)

### 3 Attaching the back panel to the bottom panel/support shelf

- Install the Wooden dowels (FF) into the pre-drilled hole in side panels (B) as shown. It helps hold the other end on the back panel. *It can be removed after assembly is completed.*

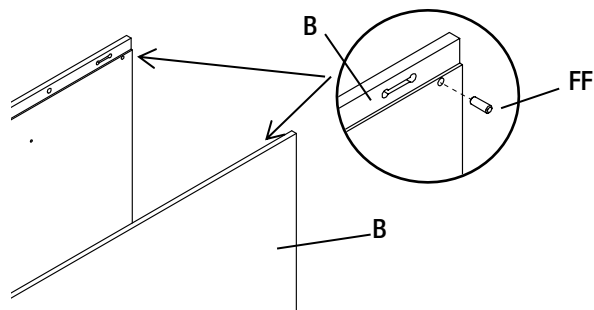

- Flex outwards 2 side panels (B) slightly then place mating groove on the back panel (C) to the bottom panel (D) as shown.
- Aligning the female connectors on back panel (C) to the male connectors on bottom panels (D).
- Use both hands to firmly press the back panel (C) down at all locations with connectors to ensure they lock together tightly.

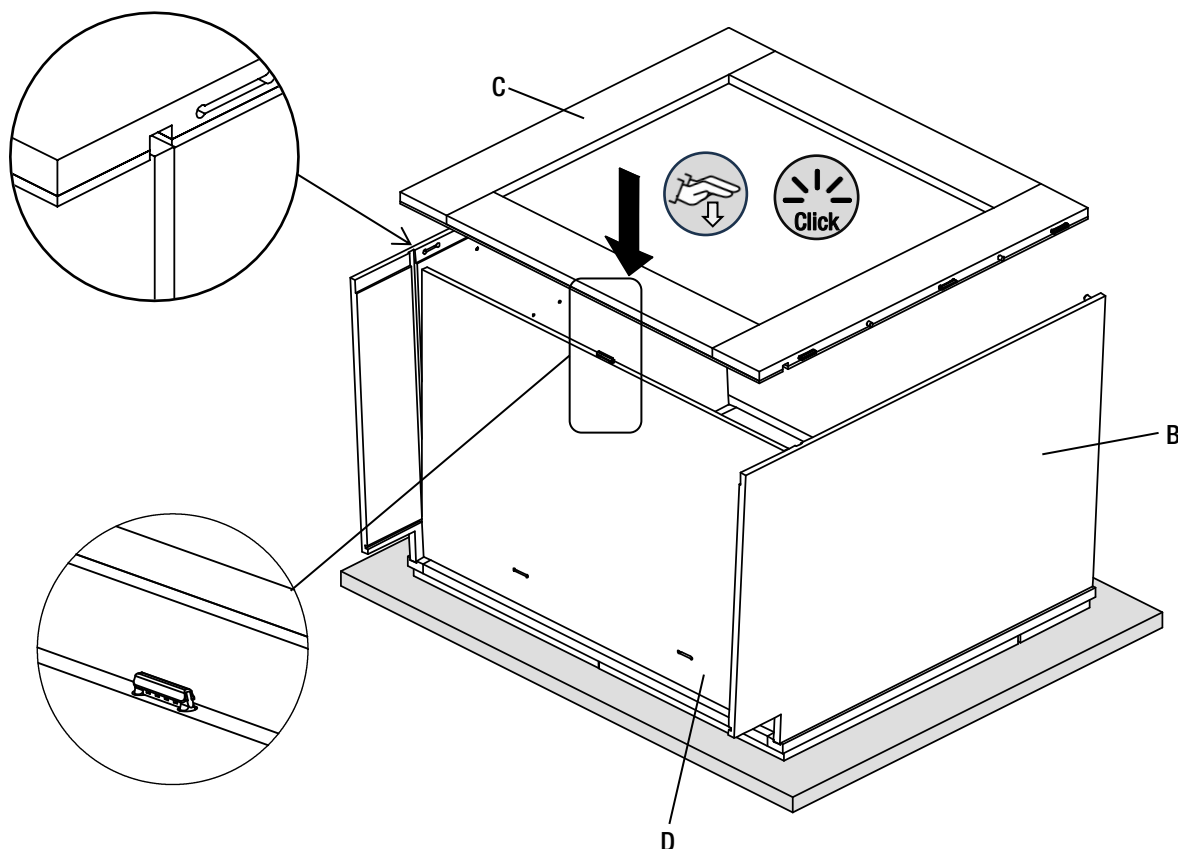



## Cabinet Assembly (Continued)

### 4 Attaching the side panels to bottom panel.

- Install the two side panels (B) to the back panel (C) by: aligning the wooden dowels & male connectors on the back panel (C) to the holes & female connectors on side panels (B).



**IMPORTANT:** Use your hands to grasp the 2 side panels (B) inward at all locations with connectors to ensure they lock together with (C) tightly.

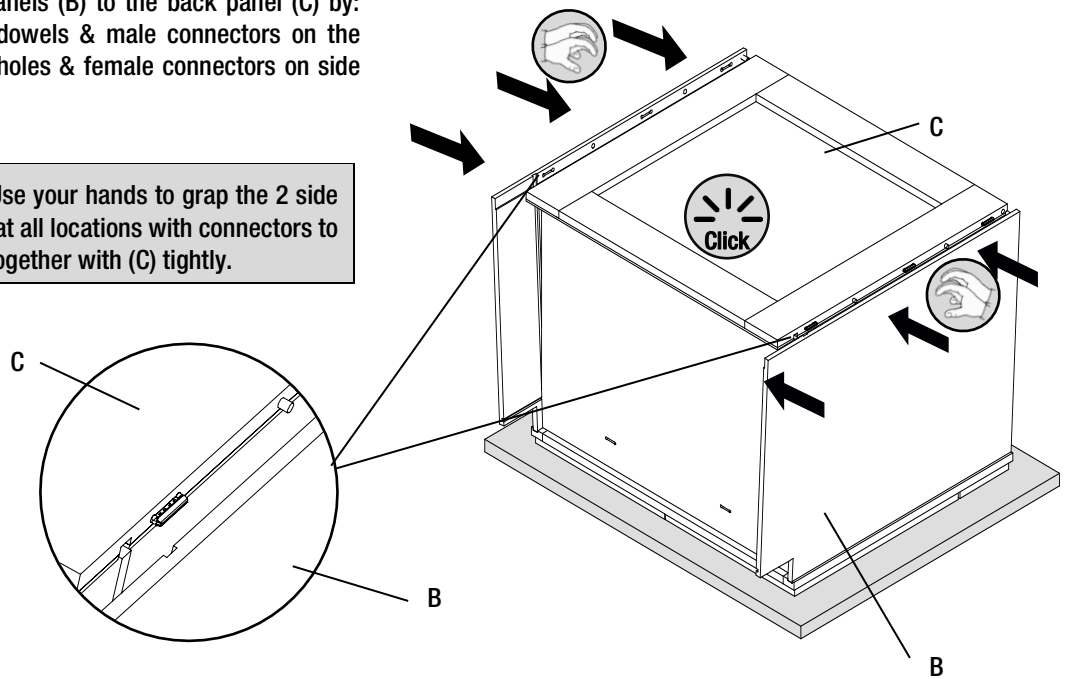

### 5 Attaching the toe kick

- Slide the toe kick (E) into grooves in the bottom (D), make sure the male connector on toe kick (E) is aligned with female connector on the bottom panel (D).
- Use both hands to firmly press toe kick (E) to ensure connectors they lock together tightly.

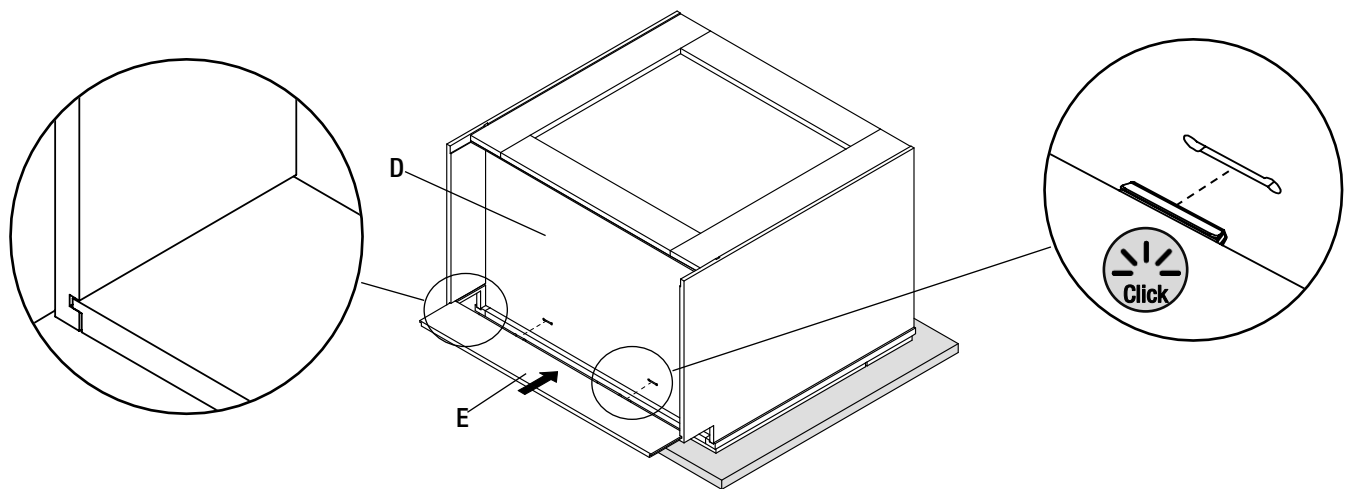

# Drawer Assembly

## 6 Attaching the drawer sides

- ☐ Place the drawer front (I) face down on a smooth surface that will not scratch or damage the face of the drawer, such as a towel or
- ☐ piece of cardboard (1) from the packaging.
- ☐ Use a rubber mallet to tap the drawer sides (G) into place on the drawer front (I).
- ☐ Insert a screw (CC) into the countersunk holes on each side, and partially tighten.
- ☐ Repeat these steps for the drawer fronts (J) and drawer sides (K)

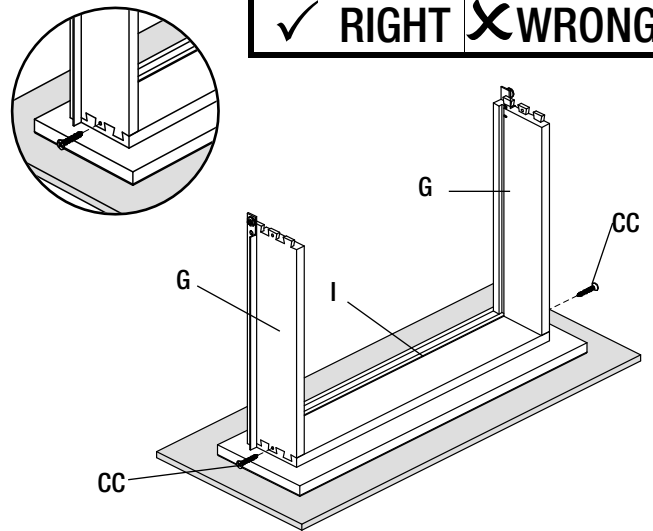
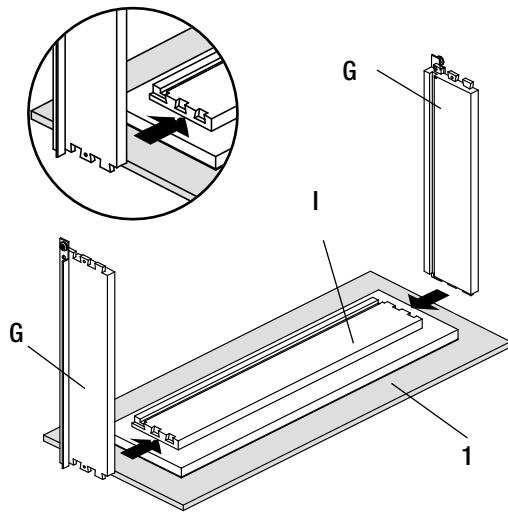

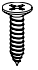
WHICH SCREW ?	
	
CC- #8 x 1 in. Screws (yellow)	BB- M4 x 15 mm (silver)
✓ RIGHT	✗ WRONG

## 7 Attaching the drawer bottom

- ☐ Slide the drawer bottoms (H) into the grooves on the sides of the drawer assembly.

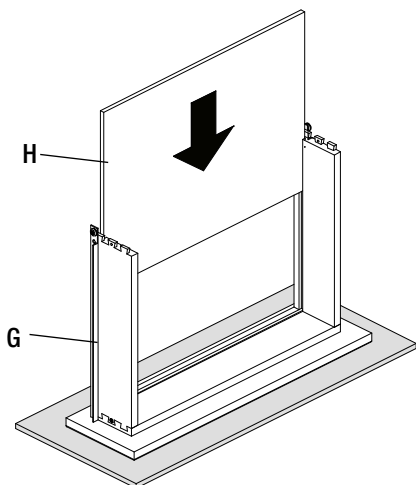

## 8 Attaching the drawer back

- ☐ Use a rubber mallet to tap the drawer back (F/J) into place. To fit the drawer back on, drawer sides will have to flex outwards slightly.
- ☐ Insert two more screws (CC) into the countersunk holes on each side. Fully tighten all four screws.

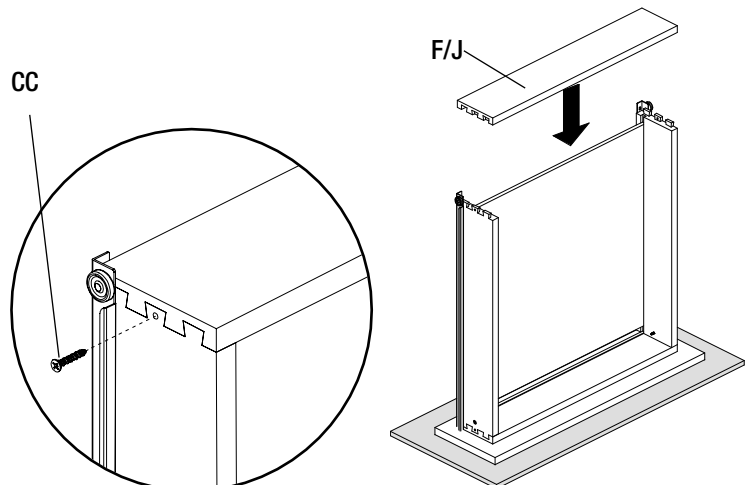

# Cabinet Assembly (Continued)

## 9 Attaching the cabinet glides

- Install the cabinet slides (AA) into the pre-drilled hole on the back panel (C) and secure with screws (BB) to the pre-drill hole on face frame.

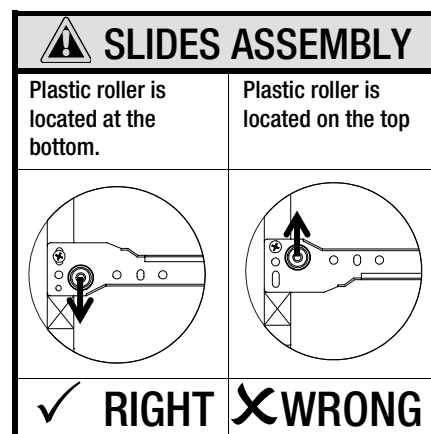
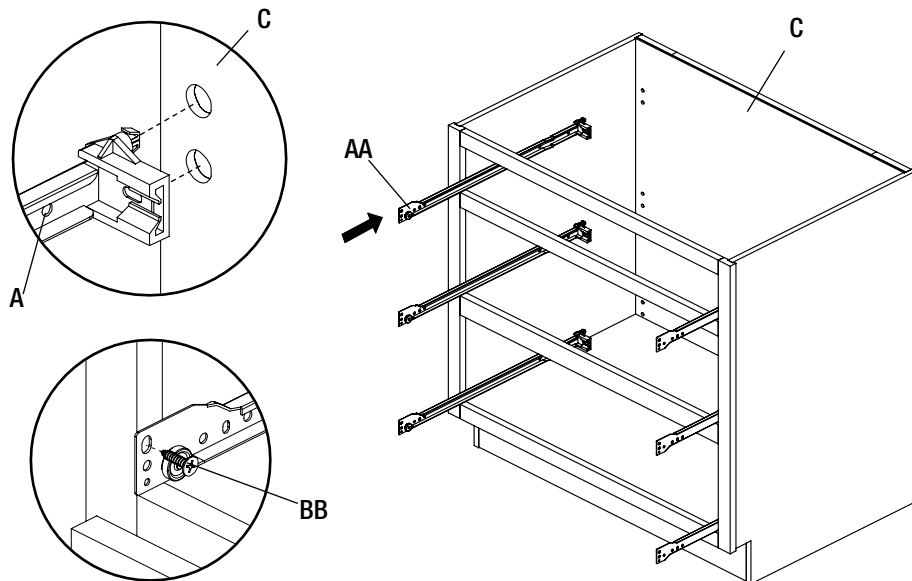

## 10 Installing/Removing the drawer

- Align the drawer slides with the slides on cabinet (AA) then slide in the direction of the arrow into position.
- Do it in the opposite direction of the arrow to remove the drawer.

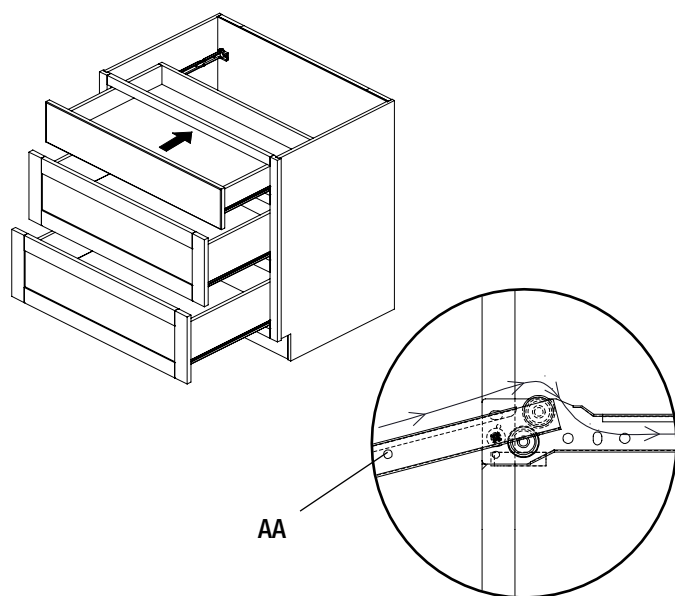

## 11 Attaching silicone pads

- Peel and stick 4 silicone pads (DD) onto the inside corners of each drawer.

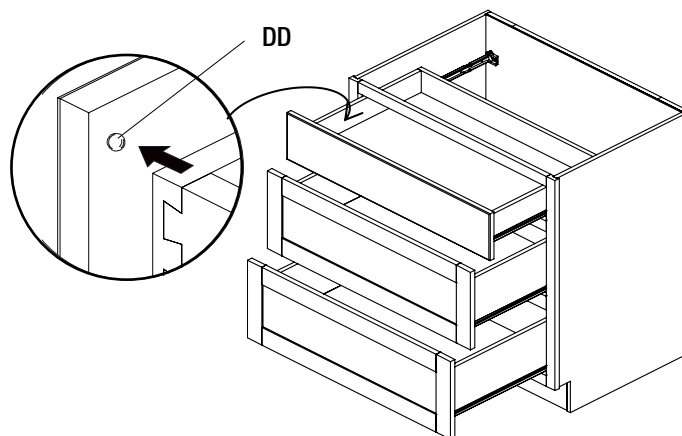

## Cabinet Assembly (Continued)

### 12 (OPTIONAL) Adjusting the drawer face.

- Adjust the drawer face in/out by shifting the Cabinet Glides (AA) to the left or right as shown.

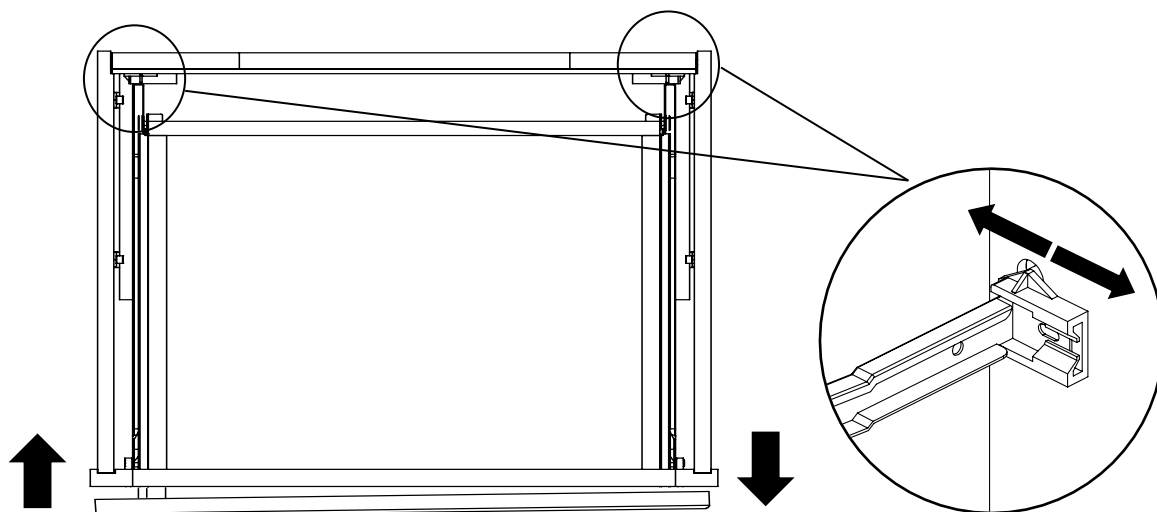

### 13 (OPTIONAL) Adjusting the drawer face.

- Adjust the drawer face up or down by loosening the screw (BB) and shifting the Cabinet Glides (AA) upward/downward, then secure it back in place by tightening the screw (BB) as shown.

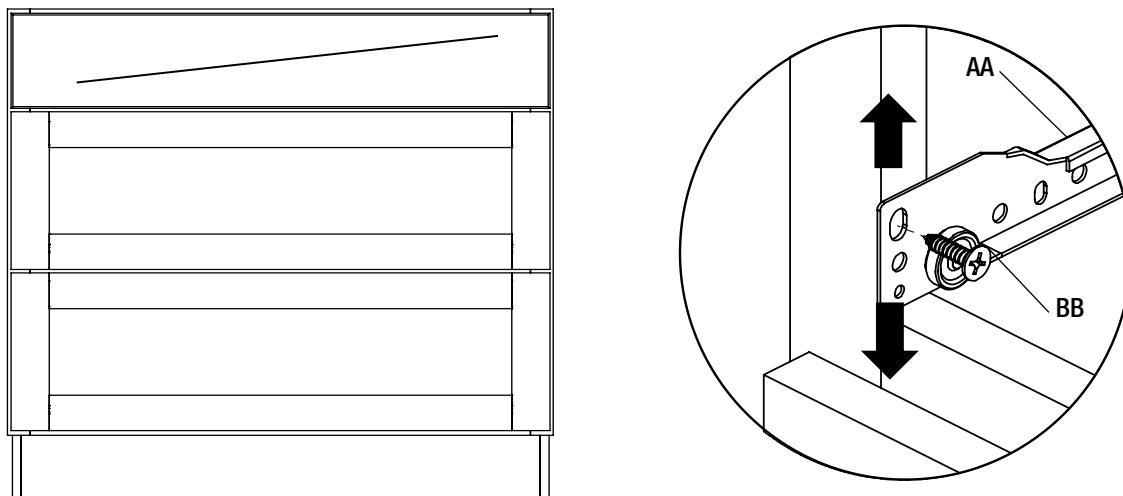

# Before Putting in Use

## 1 Check before putting in use



### IMPORTANT:

- Before putting in to use, use a rubber mallet and wooden pad to tap all locations with connectors to ensure they lock together tightly.
- The wooden pad helps avoid damaging the product.

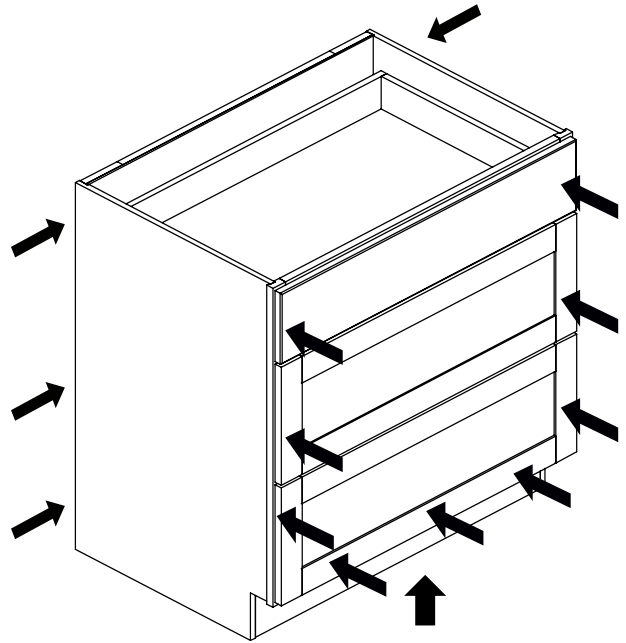
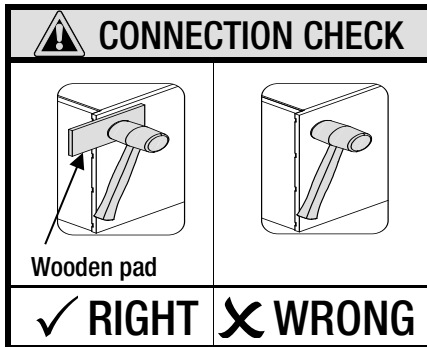

## 2 Attach the cabinet to the wall.



### IMPORTANT:

When attaching cabinet to the wall, making sure that it is attached to the "frame" of the back panel as shown beside.

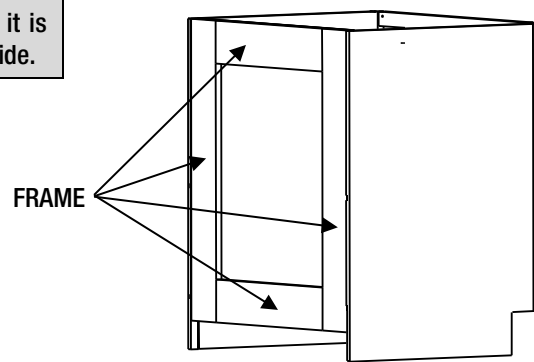

## Care and Cleaning

---

- For normal spills, a damp cloth is sufficient. Dry the surface immediately.
- Doors can be cleaned with most general-purpose household cleaners.
- Do not use caustic agents and/or abrasive scrubbers, or oven cleaners.
- Cabinets can be cleaned with a damp sponge or cloth using soapy water, or most general-purpose household cleaners. Do not use any abrasive cleaner or scrubbers.
- Do not allow liquids to remain on the surface for long periods of time.

# HAMPTON BAY<sup>®</sup>

Questions, problems, missing parts? Before returning to the store,  
call Hampton Bay Customer Service  
8 a.m. – 7 p.m., EST, Monday – Friday, 9 a.m. – 6 p.m., EST, Saturday

**1-855-HD-HAMPTON**

**HAMPTONBAY.COM**

Retain this manual for future use.