



**Caxton®**

17" oval undermount bathroom sink  
**K-R2210**

### Features

- Oval basin.
- No faucet holes; requires wall- or counter-mount faucet.

### Material

- Vitreous china.

### Installation

- Undermount.

### Recommended Products/Accessories

K-8998 P-Trap  
K-23726 Drain treatment  
K-23725 Cast iron cleaner

### Included Components

Additional Components:  
1193643



**ADA**

**CSA B651**

### Codes/Standards

ASME A112.19.2/CSA B45.1

ADA

ICC/ANSI A117.1

CSA B651

### KOHLER® One-Year Limited Warranty

See website for detailed warranty information.

### Available Colors/Finishes

*Color tiles intended for reference only.*

Color	Code	Description
-------	------	-------------



0

White



96

Biscuit

1-800-4KOHLER (1-800-456-4537)

Kohler Co. reserves the right to make revisions without notice to product specifications.

For the most current Specification Sheet, go to [www.kohler.com](http://www.kohler.com).

10-29-2022 05:36 - US//CA

THE BOLD LOOK  
OF **KOHLER®**

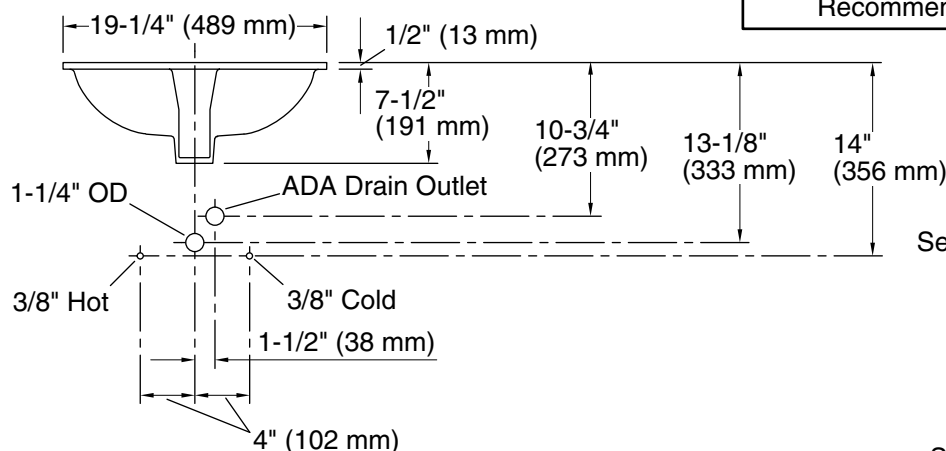
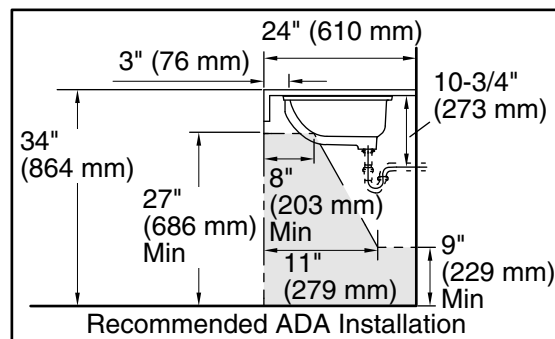
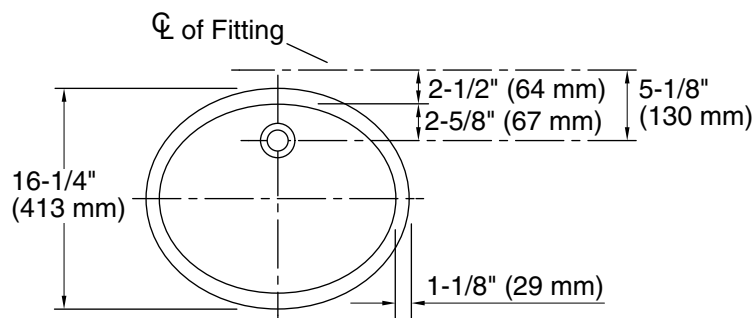

Standard Installation

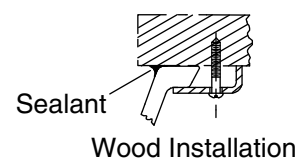
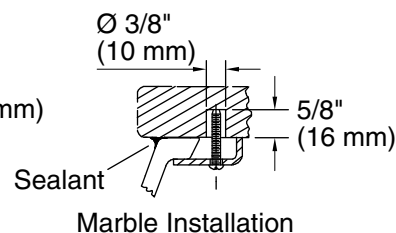

## Technical Information

All product dimensions are nominal.

Bowl configuration: Single

Installation: Undermount

Bowl area (Only): Length: 17" (432 mm)  
Width: 14" (356 mm)  
Water depth: 4" (102 mm)

Drain hole: 1-3/4" (44 mm)

Template: 1151011-7, required, not included

## Notes

Install this product according to the installation instructions.

**NOTICE:** Countertop manufacturer or cutter must use the cut-out template provided with the product, or a current one provided by Kohler Co. (call 1-800-4KOHLER). Kohler Co. is not responsible for cutout errors when the incorrect cut-out template is used.

ADA, CSA B651 compliant when installed to the specific requirements of these regulations.