

# Installation and Operating Manual

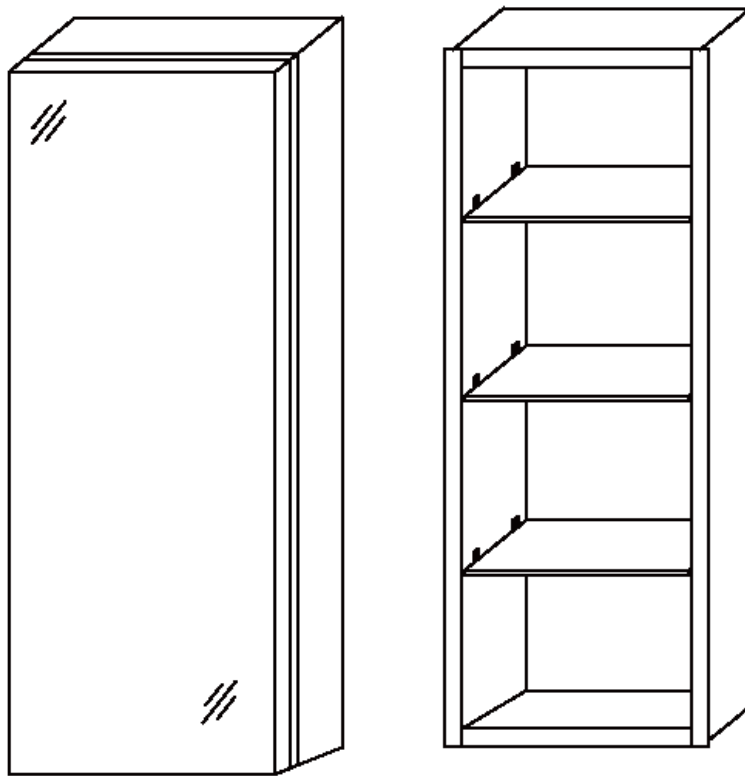

**Please do not return the product to the store.  
Contact us with any questions.**

## Model Specification

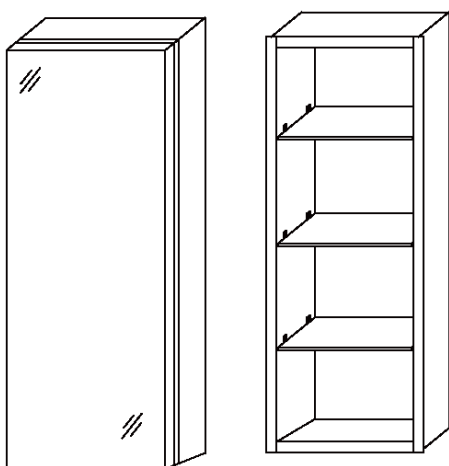

- Aluminum Frame
- Adjustable Shelves
- Quiet Hinge
- Recessed or surface mount

No.	Dimension	Color	Door Type	Remark
1	12" × 30"	Sliver	Left Door/Right Door	
2	12" × 30"	Sliver	Without Door	
3	12" × 26"	Sliver	Left Door/Right Door	
4	12" × 26"	Sliver	Without Door	
5	12" × 32"	Sliver	Left Door/Right Door	
6	12" × 36"	Sliver	Left Door/Right Door	
7	16" × 32"	Sliver	Left Door/Right Door	

## CONNECTING CABINETS

You can freely assemble the mirrored cabinet as needed. Below are some example combinations for reference.

$$12" + 24" = 36"$$

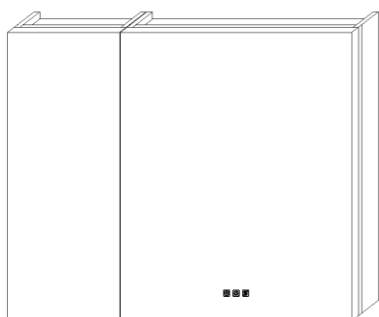

$$24" + 12" = 36"$$

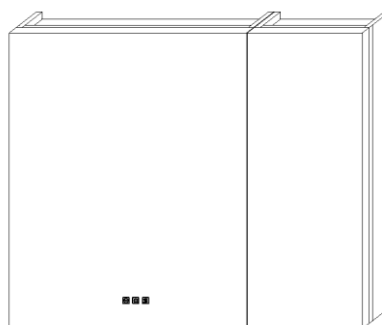

$$24" + 12" + 24" = 60"$$

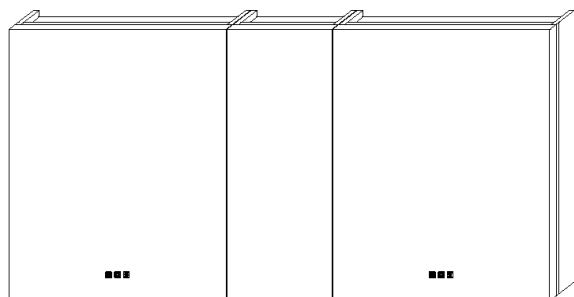

$$12" + 24" + 12" = 48"$$

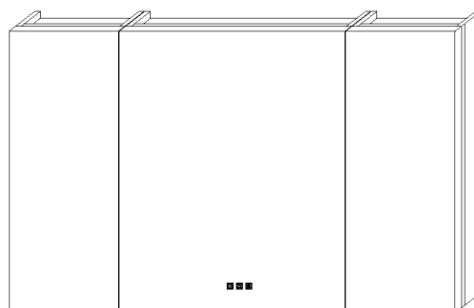

$$30" + 12" + 30" = 72"$$

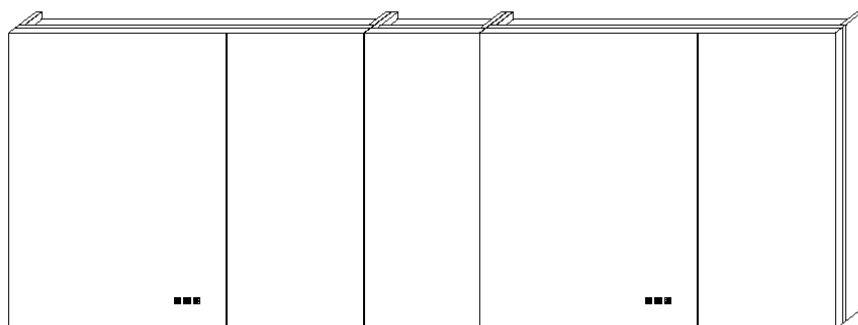



**For easy and safe installation, please refer to the following:**

Read all instructions thoroughly before installing the enclosed product. Read and take note of all **Safety Precautions**, care and maintenance information.

**PLEASE KEEP THIS INSTRUCTION MANUAL FOR FUTURE REFERENCE  
DURING PRODUCT OPERATION AND MAINTENANCE.**



### **WARNING AND SAFETY INSTRUCTIONS**

Before installing your LED Medicine Cabinet, please make sure that you carefully read through this instruction sheet, refer back to them during installation to ensure your product is fitted safely and correctly. Keep the instruction for future use.

#### **WARNING** Risk of Fire and Electric Shock

- All fittings must be installed in accordance with current IEE wiring regulations. If in doubt, please consult a qualified electrician.
- Turn breaker off the electrical supply at the main circuit board before installation and maintenance.
- Suitable for indoor use only. This product should be positioned well away from curtains and fabrics. Never cover the mirror.
- Regularly check any parts for damage, if any part is damaged the product should not be used.

#### **INSTALLATION SAFETY**

- Inspect the product immediately upon receipt for any possible damage during transportation or missing parts. Handle the product with care and protect against knocks to all sides and edges of the glass.
- Ensure there are no hidden pipes or cables in the wall before drilling and sawing.
- Wear suitable safety glasses when drilling. Take care if drilling on tiled surfaces in case the drill slips.

#### **CAUTION**

The light source of this product is non-changeable light diodes (LED). **Do not disassemble the product**, as the light diodes can cause damage to the eyes.

NOTE: The important safeguards and instructions that appear in this manual are not meant to cover all possible conditions and situations that may occur. It must be understood that common sense, caution and care are factors that can't be built into any product. These factors must be supplied by the person(s) caring for and operating the fixture. Do not install this fixture in hazardous locations.

## PARTS SUPPLIED

**Z- Mounting Bar**  
×1

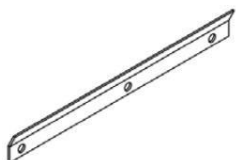

**Z-Supporting Hook**  
×1

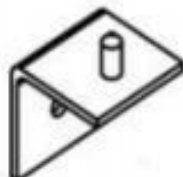

**Z-Hook Screw**  
×2



**Spare Support**  
×4



**Hinge Covers**  
×2



**Side Panel**  
×2

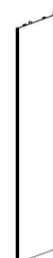

**Side Panel Covers**  
×4

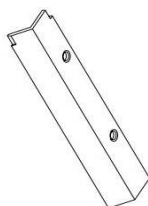

**Side Panel Cover Screws**  
×10



**Anchors**  
×3



**Anchor Screws**  
×3



**Connector**  
×4

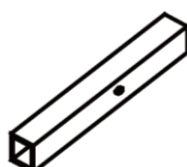

**Connector Screws**  
×8



## TOOLS REQUIRED

**Drill**



**Pencil**

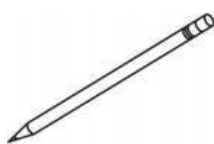

**Level**

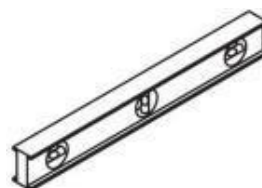

**Tape**

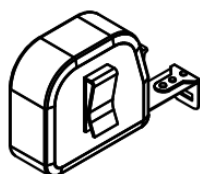

**Gloves**



**Safety Glasses**

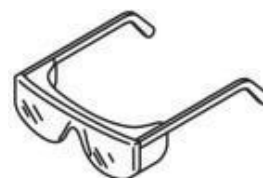

**Phillip  
Screw Driver**



**Drill Bit  
10mm(3/8")**

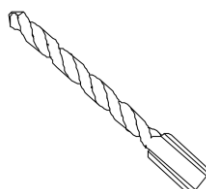

**Hammer**

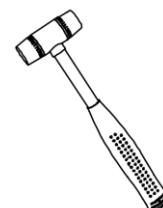

# Installation Instruction



The medicine cabinet supports two installation methods:  
**1.Surface Installation** and **2.Embedded Installation**.

Please choose the installation way as needed.



We will use a **12+24=36inch** cabinet as an example to demonstrate the installation method. The installation method is the same for the other combinations.



Please refer to the operation manual for instructions on how to use the main cabinet's functions.



## Preparation before installation

### Step 1:

**Before installing the medicine cabinet, please remove the all cabinet doors first. This will make the installation easier and more convenient.**

1. First, disconnect the wires from the cabinet doors.

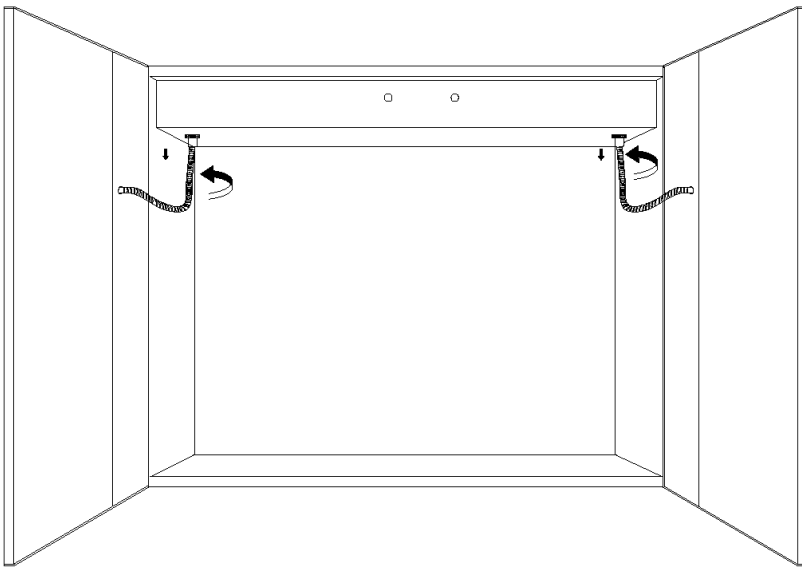

2. Then, press the end of the hinges and detach the cabinet door.

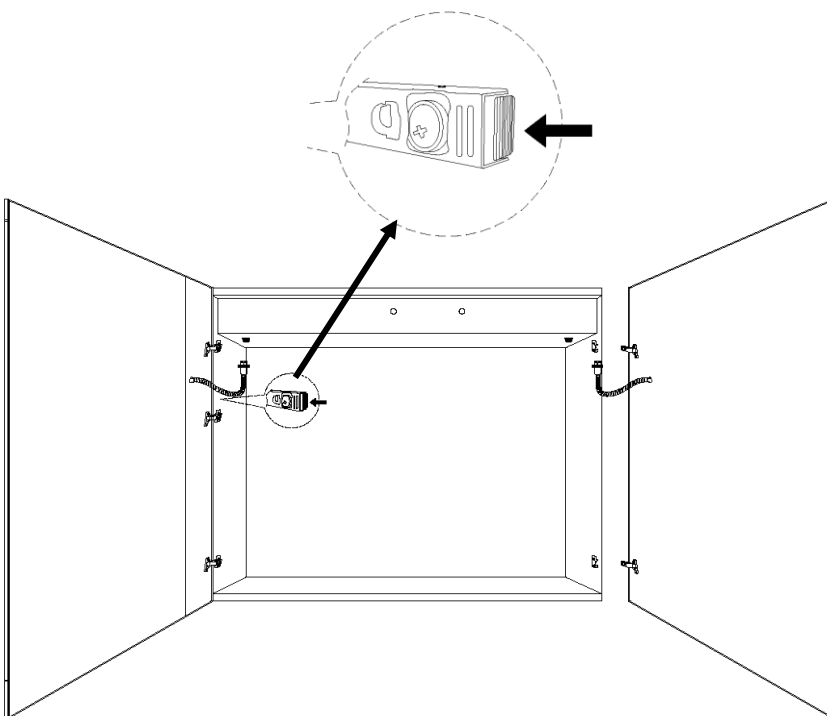

## Step 2: Combined Cabinet

Use connecting blocks to assemble the cabinet.

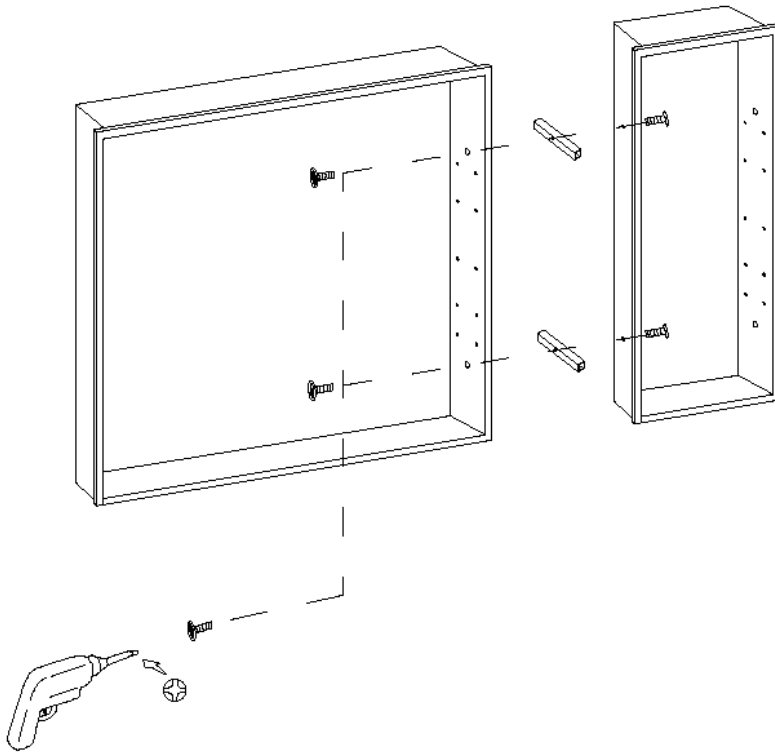

## Surface Installation Instruction

Verify minimum clearances

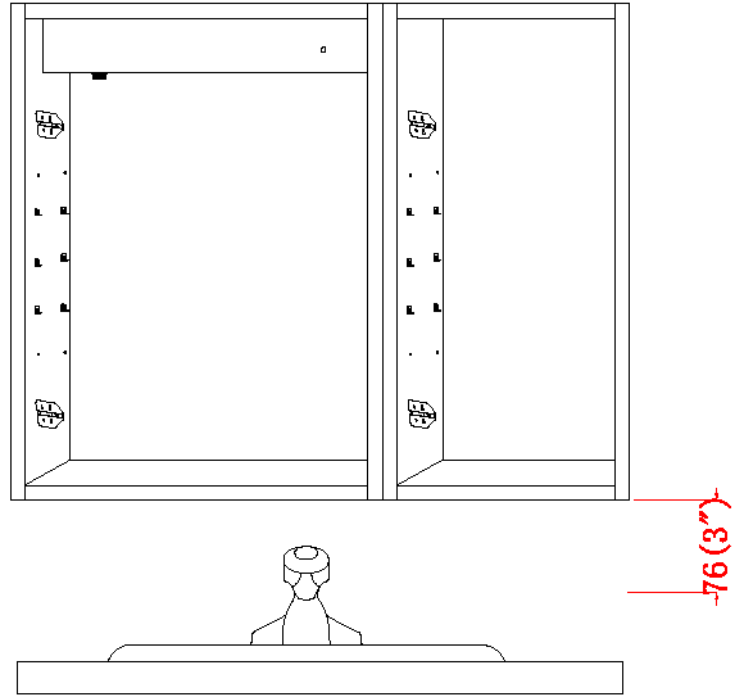

STEP 1

H is the total height of the mirror cabinet, and W is the total width of the mirror cabinet

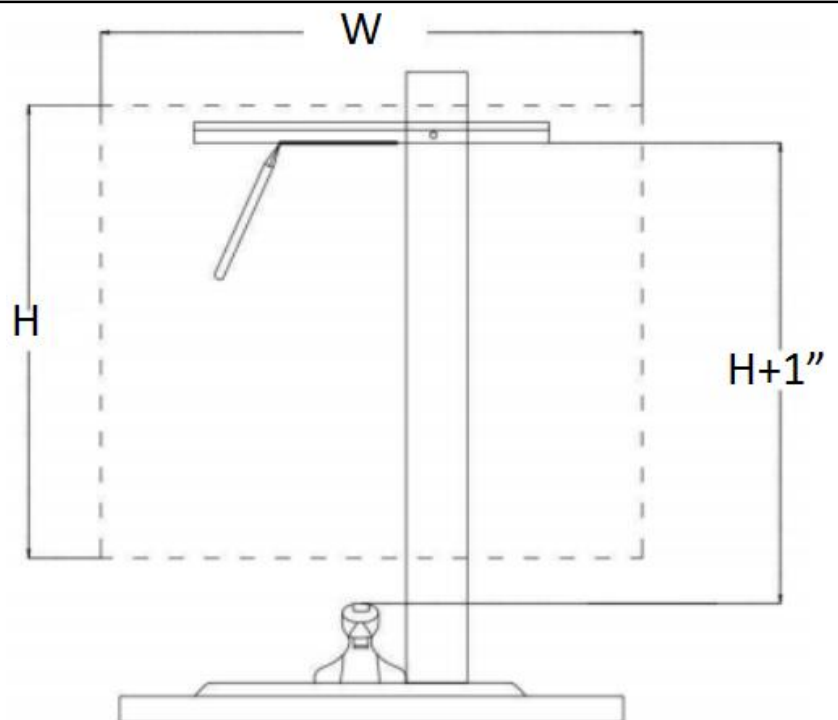

STEP 2

## Surface Installation Instruction

Level & Mark holes on the wall. Drill holes & Insert anchors

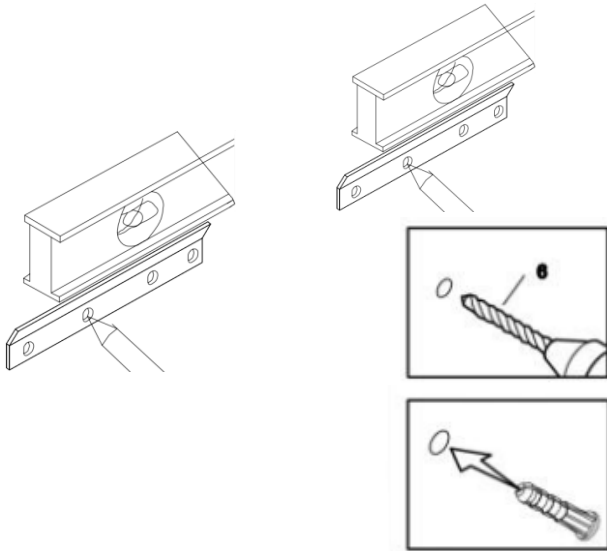

STEP 3

Secure the bars with screws

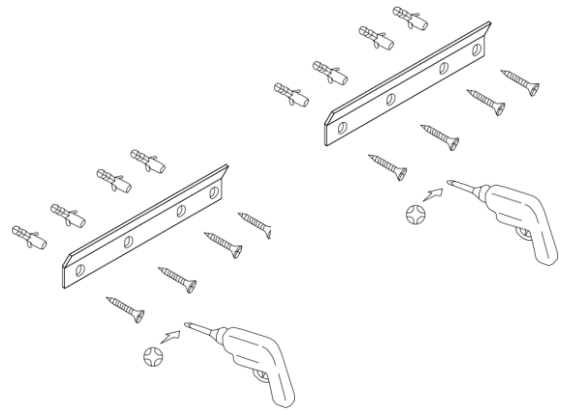

STEP 4

Install Side Panel

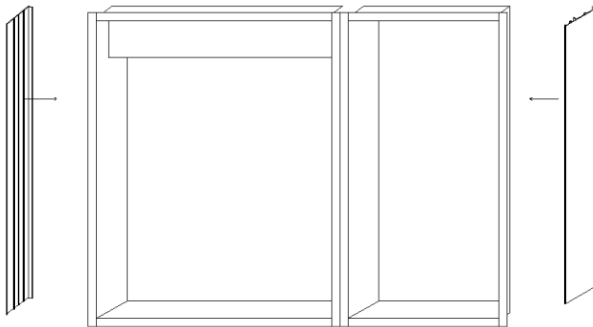

STEP 5

The side panels and cabinets are individually packaged , you need follow the STEP 5 to STEP 6 to install the side panels for surface mounting, for embedded installation no need install the side boards.

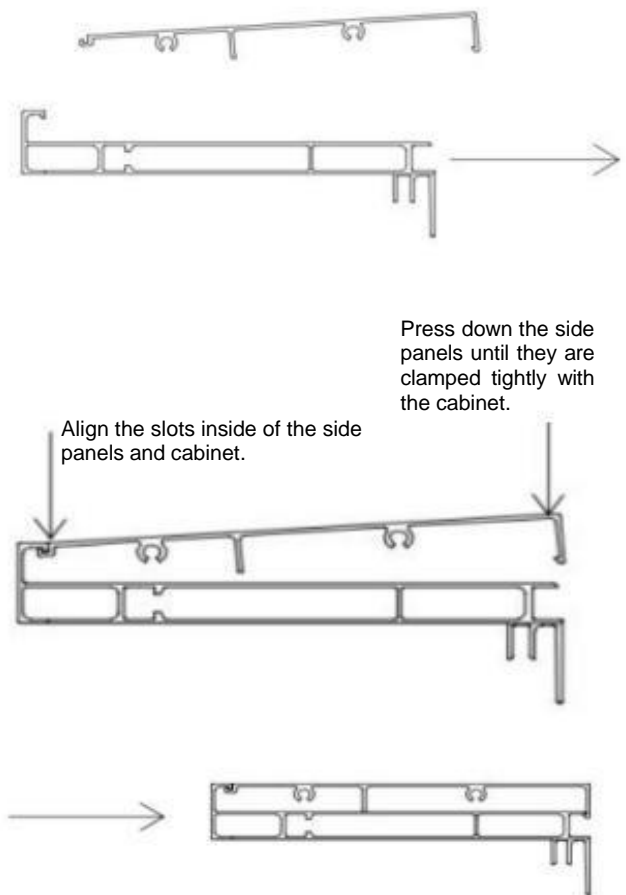

STEP 6

## Surface Installation Instruction

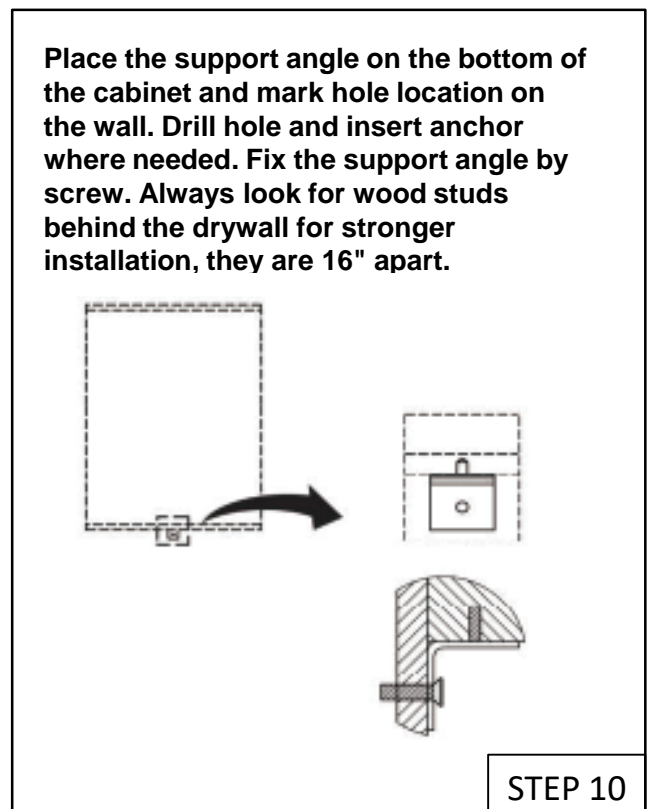
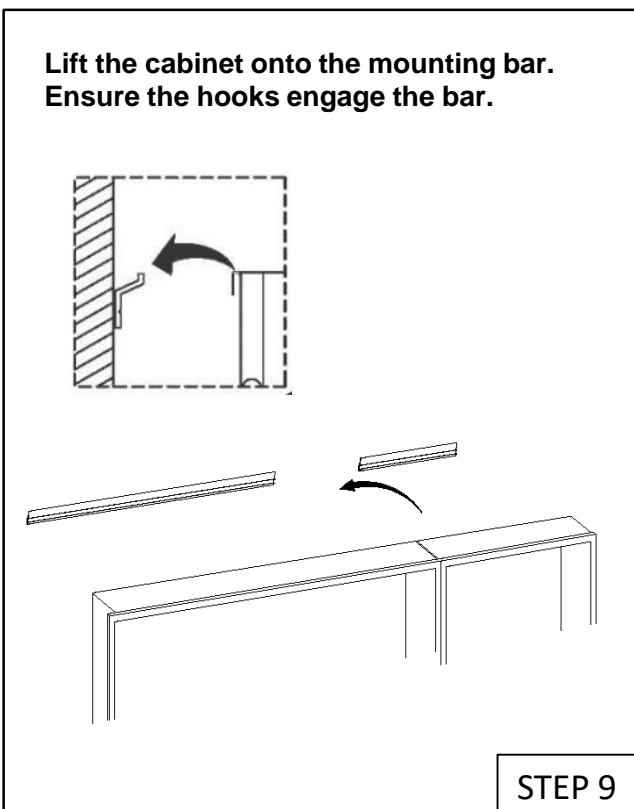
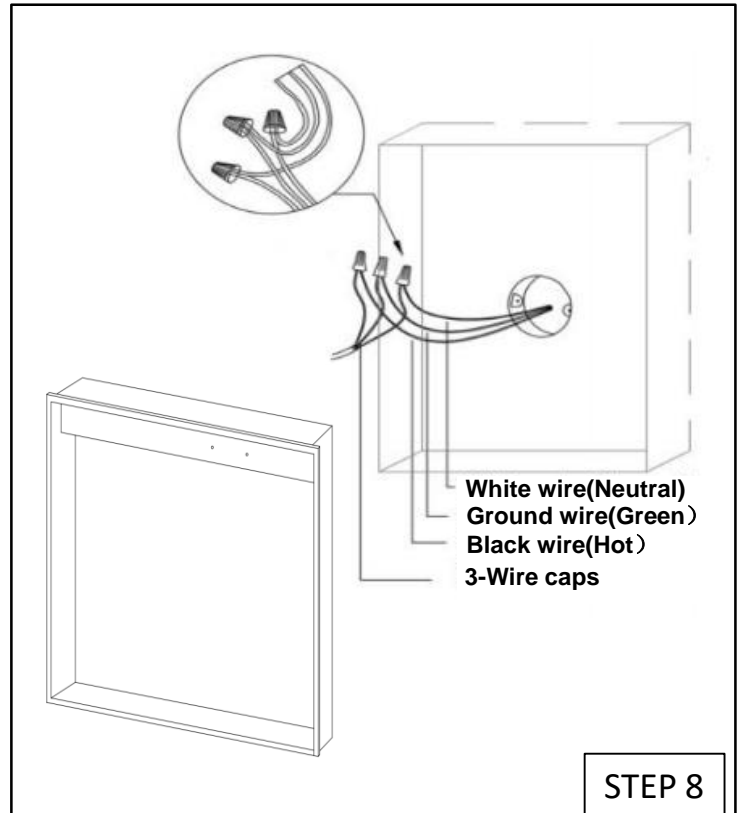
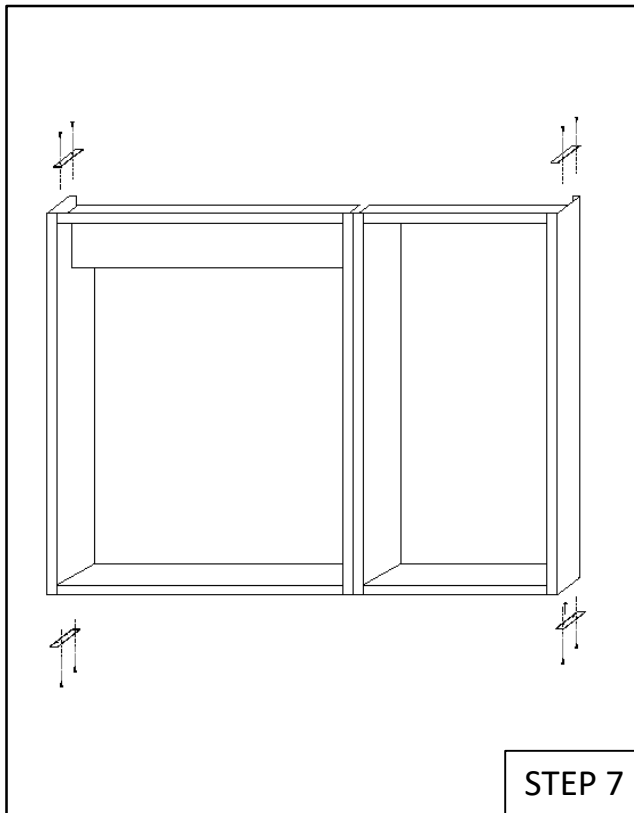

## Surface Installation Instruction

Insert the glass shelves between the layer board clips.

**Note:** You can adjust the shelves height using clips at different positions.

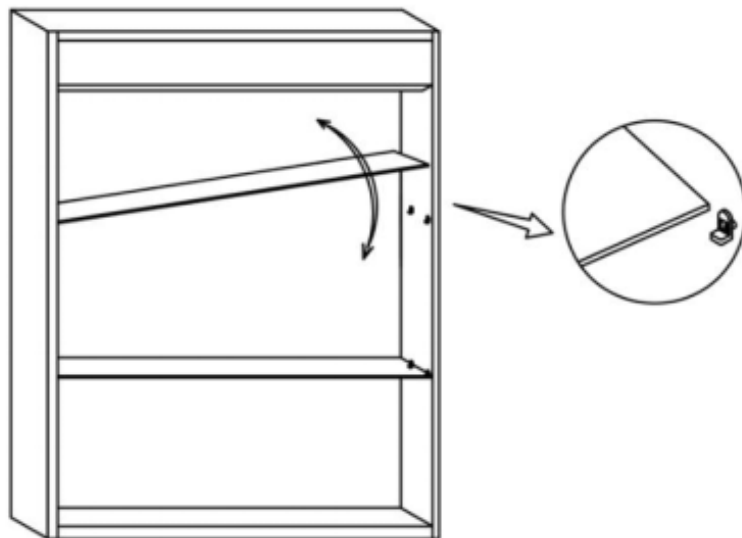

STEP 11

## Step12: Cabinet Door Installation

1.Insert the hinges to the base ,then connect the doors with the cabinet

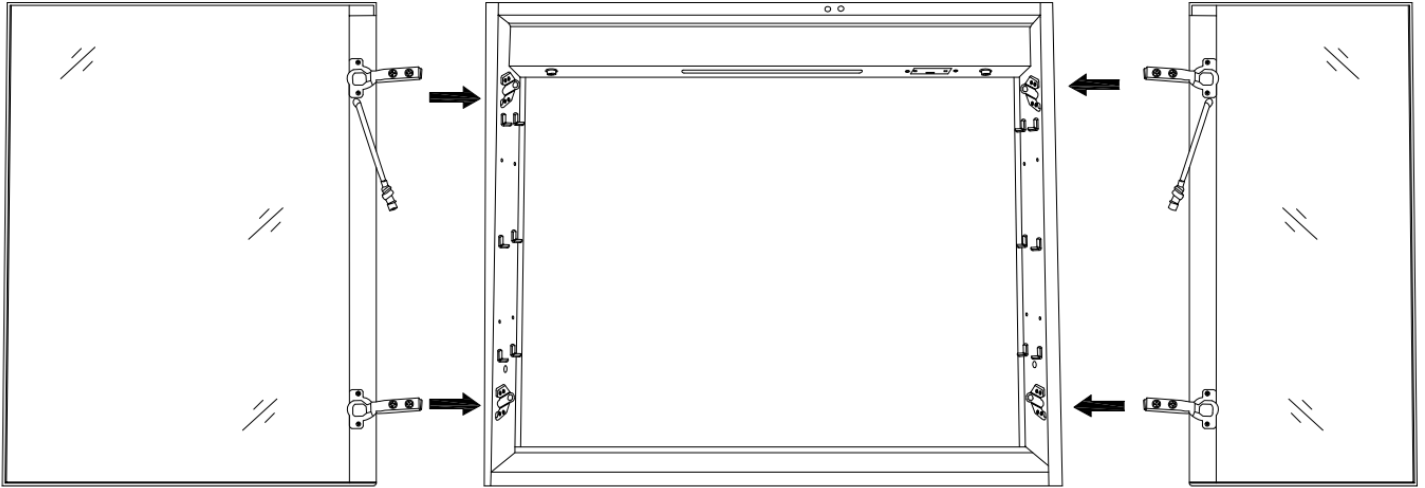

2.If necessary , adjust corresponding screws on the hinge to align the doors, ensure that gaps are even and the doors open and close smoothly

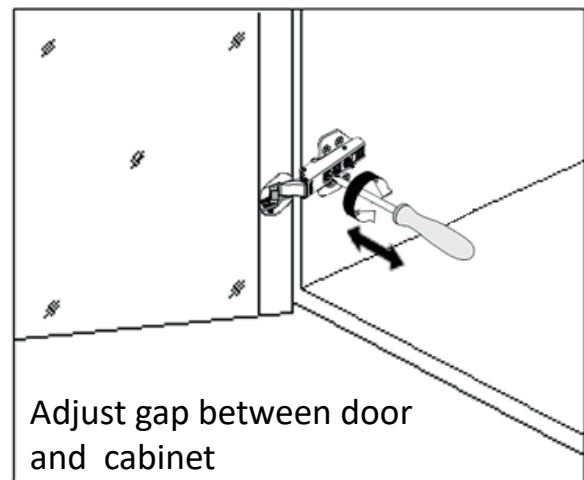
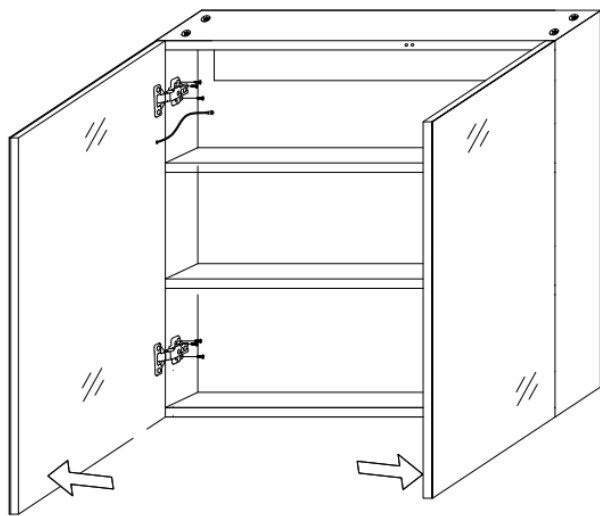

3.Insert the wire on the door into the terminal on the cabinet and tighten the screw

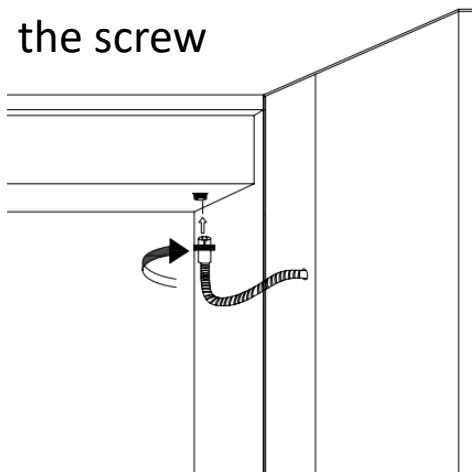

## Embedded Installation Instruction

### Step1: Measure the dimensions for Embedded Installation

**NOTE:** The dimensions for **Embedded Installation** refer to the length and width of the storage space behind the cabinet, not the total length and total width of the cabinet.

**NOTE:** The estimated dimensions for Embedded Installation are as follows:

$W = (\text{Total assembled width of the mirror cabinet}) - 3/4 \text{ inch};$

$H = (\text{Total assembled height of the mirror cabinet}) - 3/4 \text{ inch};$

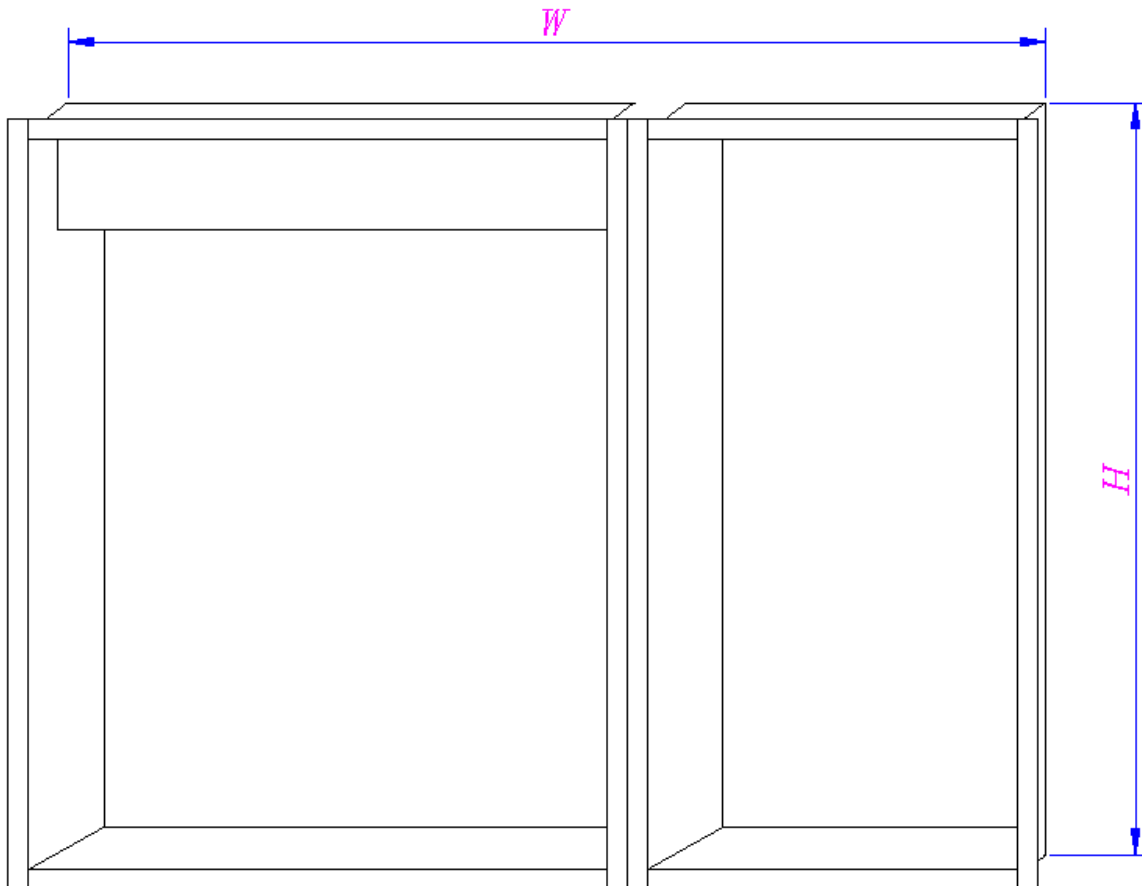



## Embedded Installation Instruction

Determine the size of the opening

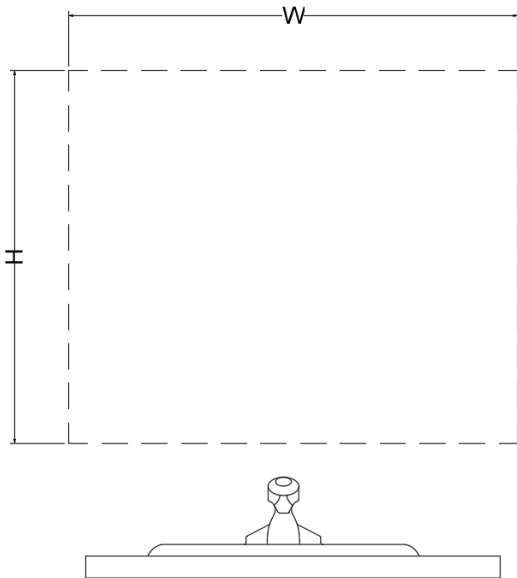

STEP 2

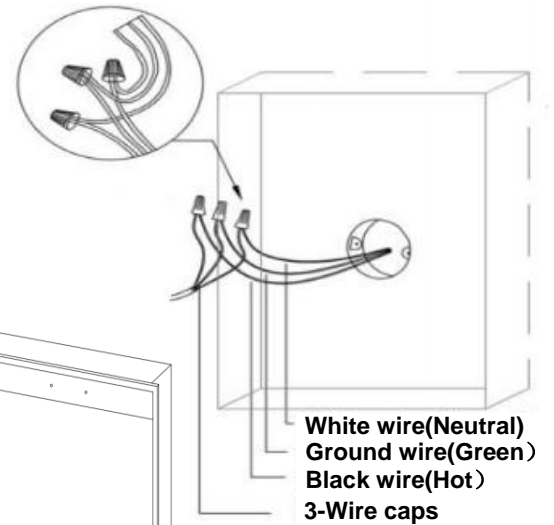

STEP 3

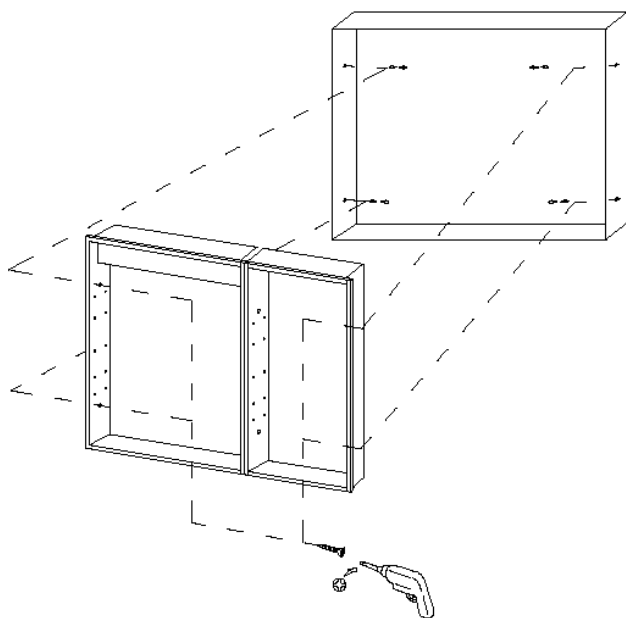

STEP 4

Insert the glass shelves  
between the layer board clips.

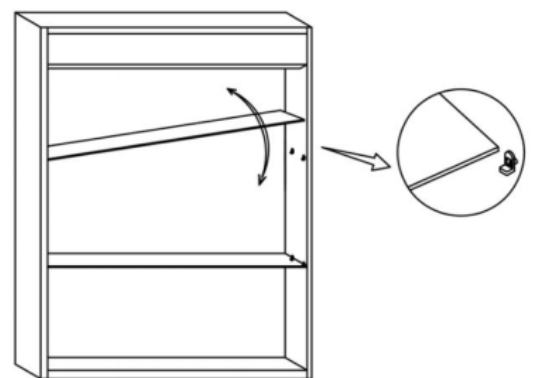

STEP 5

\*All diagrams are for reference only. All model dimensions and proportion position will vary.

## Step6: Cabinet Door Installation

1.Insert the hinges to the base ,then connect the doors with the cabinet

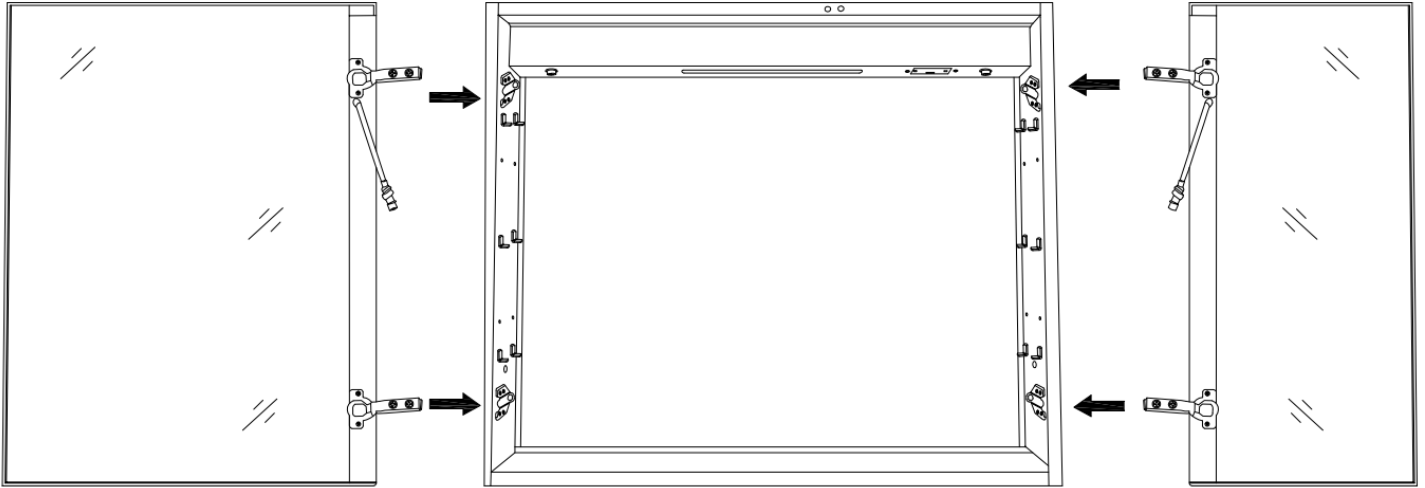

2.If necessary , adjust corresponding screws on the hinge to align the doors, ensure that gaps are even and the doors open and close smoothly

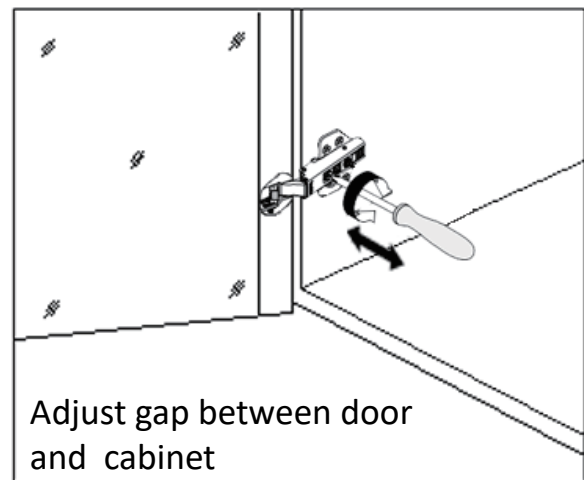
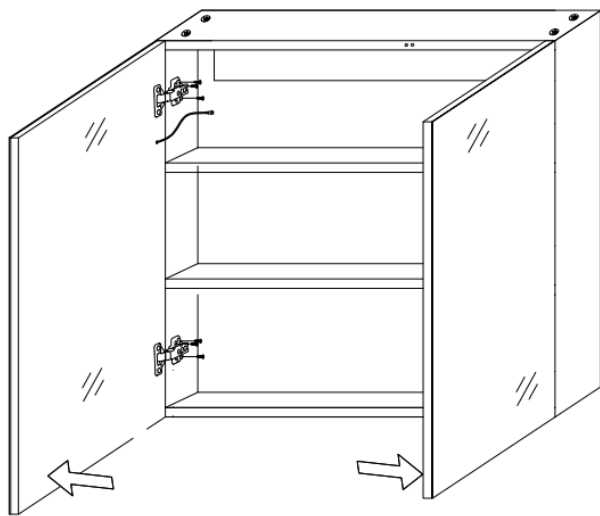

3.Insert the wire on the door into the terminal on the cabinet and tighten the screw

