

CANEST[®]

CANEST[®]

INSTALLATION GUIDE IMPORTANT SAFEGUARDS

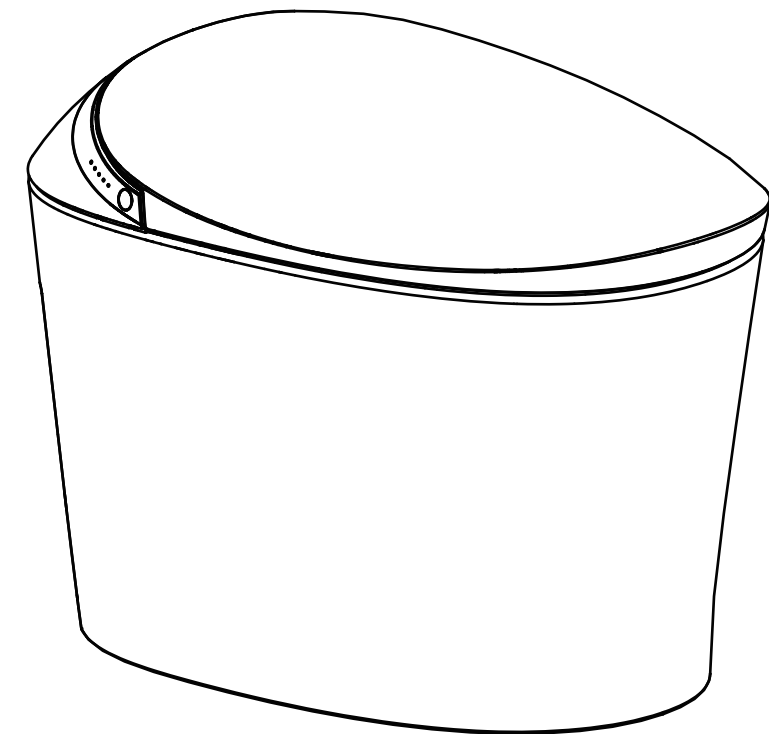

Get free technical support for the lifetime of your product.

Email: service@canesthome.com

Phone: (+1) 702-824-3195

READ ALL INSTRUCTIONS BEFORE USING.

Get free technical support for the lifetime of your product.

Email: service@canesthome.com

Phone: (+1) 702-824-3195

Table of Contents

Safety Precautions1

Technical Specifications4

Pre-installation5

Installation7

Remote Control Installation and Battery Replacement10

Button&Indicator light Instructions11

Remote Control Instructions 12

Automatic Function 16

Daily Maintenance 17

Label Illustration 19



Troubleshooting 20

Troubleshooting



Product part or function	Phenomenon	Cause	Solutions
Complete machine	Not working	Whether the power supply is off	Power on
		Whether the leakage protector is off	Press the leakage switch again
		Power failure or not	Wait for power supply
Rear wash	Not working	Whether the water supply switch is on	Turn on the water supply switch
		Whether the water supply is cut off	Wait for water supply to recover
		Whether the nozzle is blocked by foreign matters	Remove foreign matters and manually clean the nozzle
		No skin contact with seat sensor	Re-adjust sitting position to ensure skin contact with seat sensor
	Low water pressure	Is the water pressure gear set to low gear	Reset the water pressure gear
		Whether the water supply channel is normal	Clean the filter screen at the water supply outlet and supply water again
	Water temperature is low	Whether the water temperature is set to low gear	Reset the water temperature gear
	Stop water halfway	Whether the automatic stop time is exceeded	Re-execute the function
		No skin contact with seat sensor	Re-adjust sitting position to ensure skin contact with seat sensor
Warm air drying	Low heating temperature	Whether the wind temperature gear is set to low gear	Reset the wind temperature gear
	Half-way stop	Whether the automatic stop time is exceeded	Re-execute the function
		No skin contact with seat sensor	Re-adjust sitting position to ensure skin contact with seat sensor
Seat ring heating	Insufficient seat ring temperature	Is the seat temperature gear set to low gear	Reset the seat temperature gear
Deodorization	Not working	No skin contact with seat sensor	Re-adjust sitting position to ensure skin contact with seat sensor
Remote control	No reaction	Objects block the sensing window	Remove the objects
		Incorrect use angle and sensing distance	Adjust angle and distance
		Batteries run out	Replace with new batteries

Safety Precautions

Before installation, please read this manual carefully and install it in strict accordance with the instructions. After reading, please put this manual in a prominent position. Keep the place properly. In order to avoid injury and property damage to users and others, please strictly observe the safety warnings and precautions.

SIGN	MEANING
 Warning	It means that if the regulations in this warning are not observed and misoperation is made, serious injury or death may be caused.
 Danger	It means that if the regulations in this warning are not observed and misoperation is made, serious injury or death may be caused.

The following signs are used to indicate important safety precautions when using the product.

SIGN	MEANING
	This figure indicates that it is not feasible and [prohibited].
	This figure shows the content that must be enforced.

 **WARNING**



Do not install and use this product in damp places. This product must be reliably grounded, and the reliable connection of AC socket ground wire to the ground should be ensured. The grounding wire should use a tripod socket. If you are not sure whether it has been reliably grounded, please ask a qualified electrician or maintenance personnel to check and confirm. Please ensure that the wiring of the power socket conforms to the national standard (zero on the left and fire on the right) and cannot be reversed.

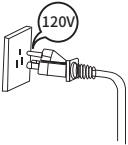

This product must be connected to a special standard socket and wiring with a 120V/60Hz load current of at least 10A, and the socket must be equipped with earth fault circuit breaker or earth leakage protector or similar high sensitive and fast leakage switch (rated sensitive current below 10mA).

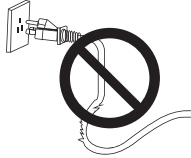

It is forbidden to use the power extension cord or loose and unstable power socket, otherwise it may cause fire or electric shock.



Do not touch the product that has fallen into water or soaked in water, and immediately unplug the power plug.



The lit cigarettes and other combustibles cannot be put into the toilet cover, otherwise it may cause fire. It is forbidden to disassemble, repair or modify the product by yourself, otherwise it may cause fire or electric shock.



If the power cord is damaged, in order to avoid danger, it must be replaced by professionals from the manufacturer, its maintenance department or similar departments.



WARNING

Please pull out the power plug when it thunders.

If the product function is abnormal or fails, please stop using it immediately and cut off the power supply, and contact the service provider in time.

When used by people (including children) with physical, cognitive and intellectual disabilities or lack of experience and common sense, it is necessary to use this product under supervision, patients with heart disease should use it carefully. Do not let children play with this product.

If it is not used for a long time, the power supply and water supply must be cut off.

It is forbidden to disassemble, repair or modify the product by yourself, otherwise it may cause fire or electric shock.

Banana water, gasoline, liquid medicine, detergent, insecticide, toilet cleaner and hard brush are prohibited to clean this product.

Do not pour water or detergent on the machine body or power plug, otherwise it may cause fire or electric shock.

This product is an electrical product. It is forbidden to put it in a place that is easy to be soaked by water. Do not pour urine or other liquids onto the body.

Do not use water other than tap water, otherwise it may cause skin inflammation and other problems.

Do not stand on the ceramic toilet, and do not hit the ceramic with gravity to prevent damage and water leakage.

Do not put fingers or other objects into or block the drying air outlet, otherwise it may cause scald, electric shock or burn.

It is forbidden to use other electrical appliances on the same socket.

When the product is powered on, it is not allowed to put the product sideways or upside down, otherwise it may cause fire or burn.

The socket shall be installed in a place that is not easy to be soaked by water. It is recommended to use waterproof socket.

The new hose assembly and other attached or designated parts attached with the appliance shall be used for installation. The old hose assembly cannot be reused, otherwise, it may cause water leakage, fire or electric shock.

When the product is moved indoors from a cold or wet place, it should be stored for 2 hours to fully volatilize the condensed water in the machine, and then it can be started for use, to avoid short circuit of products.

3. When water and electricity are cut off

1. Flushing during power outage
(under the condition that the spare battery box is connected and has filled battery)
Long press the side button to flush.

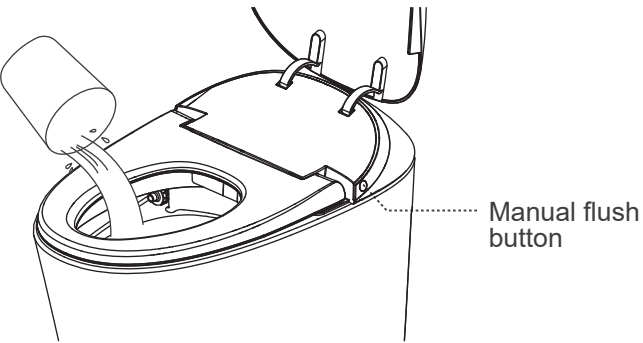

2. Flushing during water outage

Flush the toilet with external water (pour approx. 2 Gallons water into the bowl). Beware of overflow.

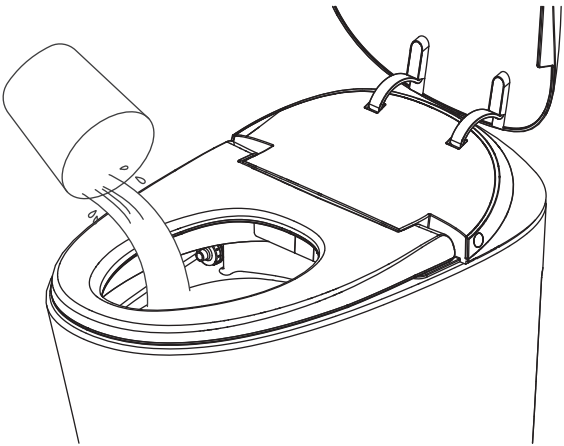

Label illustration

Illustration	Explain
	seat sensor
	foot sensor

Replace activated carbon

1. Open two rubber plugs, loosen two screws, and pick up two screws and gaskets.

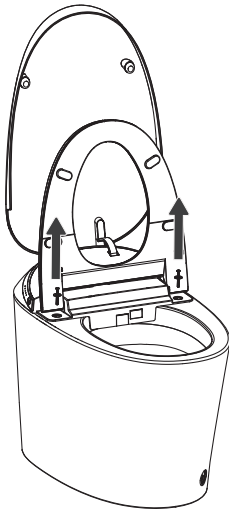

2. Pull out the activated carbon box directly, replace the used activated carbon with new one. Then insert the box into original place.

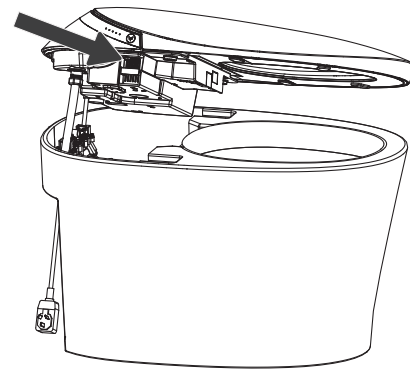

3. Assemble the cover into the ceramic body, lock the screws and cover the rubber plug.

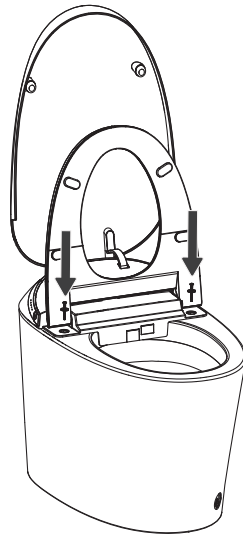

Drain the water in the pipeline when not in use for a long time

1. Pull out the power plug to cut off the power.
2. Close the inlet angle valve, unscrew the hose from the angle valve, drain the water in the pipeline and reinstall it.

For safety, it is recommended to put antifreeze into the accumulated water in the toilet.



TIPS

Before opening the angle valve, the power must be cut off! When using the toilet again, be sure to connect water supply first, then plug in.

WARNING

<p>Do not place the product where it may fall or be pulled into the bathtub or sink. </p>	<p>Do not connect the water pipe with the outlet pipe of the water heater. The water inlet temperature is 41 °F~104°F. If it exceeds the specified range, it may cause internal heating. The component does not work properly. </p>
<p>Do not put this product in water or other liquids. </p>	<p>When using this product, do not lean back on the toilet cover to avoid damaging the product. </p>
<p>Do not touch the product that has fallen into water or soaked in water, and immediately unplug the power plug. </p>	<p>Please do not flush newsprint, paper urinal pads, women's sanitary napkins and other easily clogged items into the toilet. </p>
<p>It is forbidden to embed cementitious materials (cement mortar) into the base of the ceramic toilet, otherwise the ceramic toilet may be cracked due to expansion. </p>	<p>Do not use the product in an environment below 32°F. If the room temperature is lower than 32°F, the water in the water supply line of the product must be drained, Prevent the water way from freezing and cracking, causing water leakage or fire during later use. </p>
<p>Do not exert strong force or impact, do not stand on the seat ring, toilet cover or this product, and do not place heavy objects. </p>	<p>To prevent damage caused by freezing, please take measures to keep warm and increase the temperature of the toilet. </p>
<p>Do not let the sun shine directly on the product to avoid discoloration and affect the reception effect of the remote control. </p>	<p>When installing, disassembling, repairing and maintaining the product, you must unplug the power plug and close the water supply valve. </p>
<p>The seat ring and toilet lid of this product would lower slowly. Do not press hard to avoid damaging it. </p>	

Technical Specifications

Rated voltage		120V~
Rated frequency		60Hz
Rated power		1240W
Pressure of Water supply		13.05psi(minimum necessary water pressure) - 116.03psi (static pressure)Flow of water supply at least 7.93gpm
Ambient temperature		32°F-104°F
Temperature of water supply		41°F-104°F
Toilet Flushing	Flushing type	Jet Siphon
	Rough in	12in
Cleansing	Water heating type	Instant heating
	Water heating power	1300W
	Warm water temperature	Off, 86°F-102.2°F(6 levels)
	Safety device	Temperature fuse, water temperature sensor, grounding protection, over-temp protection
Dryer	Min air volume	≥ 0.2m³/ min
	Air heating power	250W
	Dryer temperature	Off, 86°F-122°F(6 levels)
	Safety device	Temperature controller, temperature fuse, leakage protection plug.
Heating seat	Seat heating power	40W
	Seat temperature	86°F-100.4°F (6 levels)
	Safety device	Temperature sensor, temperature fuse, temperature controller, grounding protection,
Product size		28.2 x 16.3 x 19.4 in
Water proof rate		IPX4

Remarks:
Rated power: the product starts to power on and start up under the conditions of ambient temperature of 73.4 °F, static water inlet pressure of 116.03psi+/-2.9psi, and water inlet temperature of 41 °F. After setting the water pressure, seat temperature and water temperature to the highest level in turn, immediately start the rear wash and continue to work steadily for the average power of a cleaning cycle.

Daily Maintenance



Maintenance of body

- 1. Cut off the power supply**
Please cut off the power supply before maintenance.
- 2. Wipe with soft cloth**
Please wipe the dirty parts with a soft damp cloth and then let it dry.
- 3. Safety self-inspection**
Please reconnect the power supply after cleaning.

Filter screen cleaning



Automatic Function

1. Automatic flush after leaving the seat

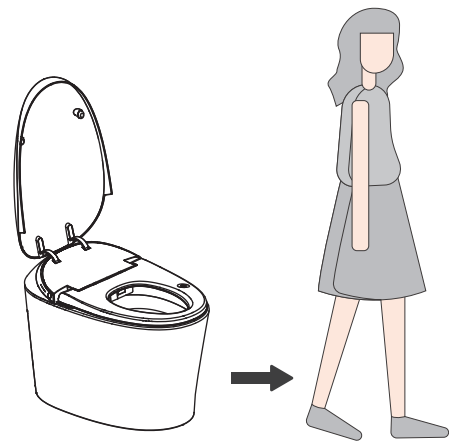

Under the automatic flush mode, when the user is detected staying on the seat for ≥ 30 seconds, after the user leave the seat for 5 ± 1 seconds, it will perform the automatic flush function.

2. Foot sensor

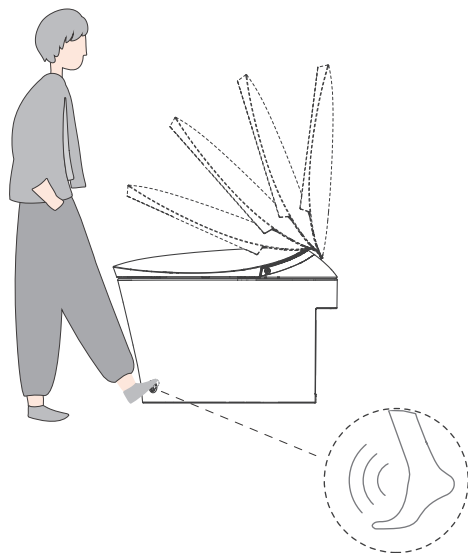

After toileting, foot approach the sensor area to perform the flushing function.

Pre-installation

Parts diagram

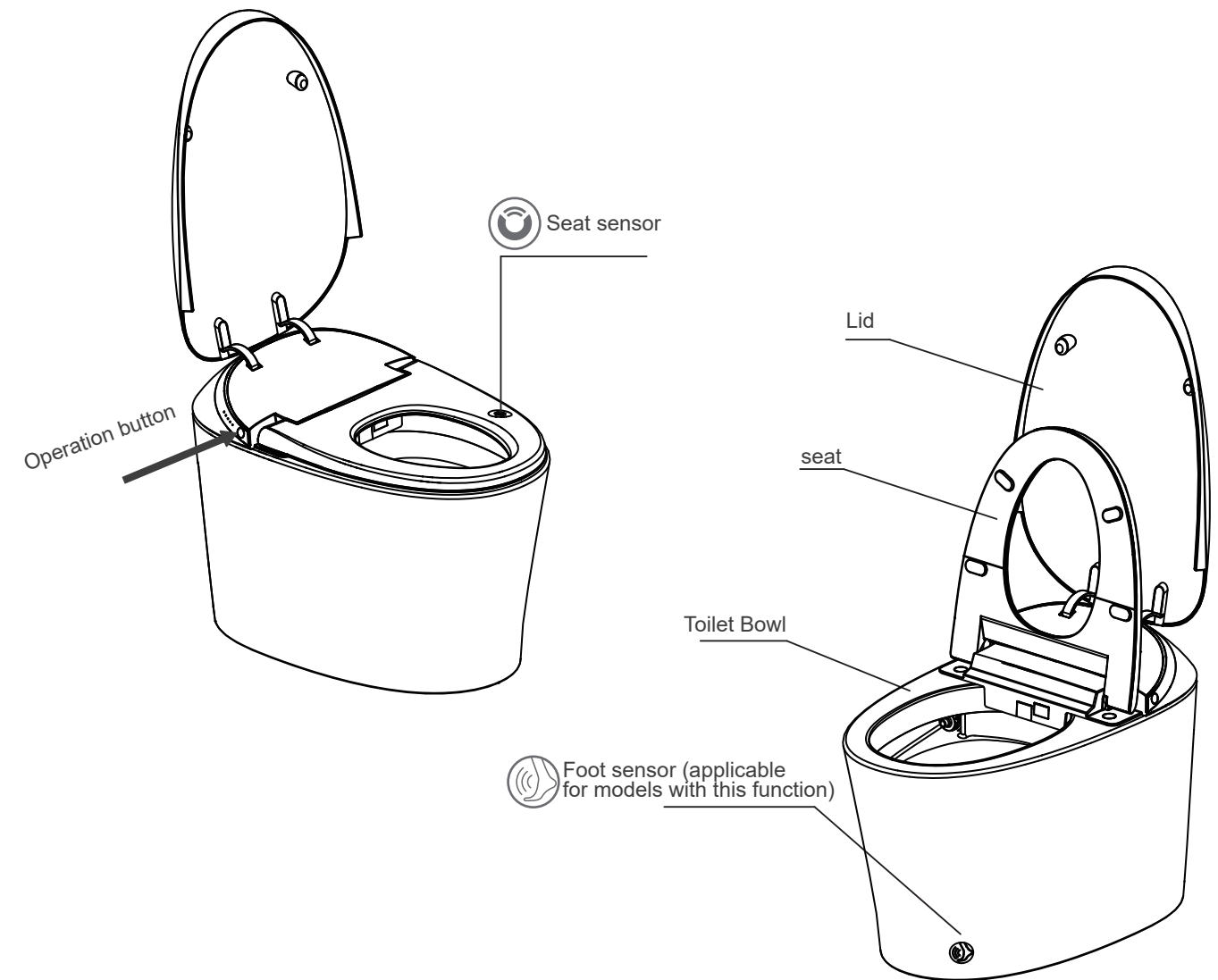

Tools required

Please prepare the following required tools before installation.

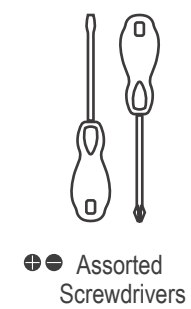
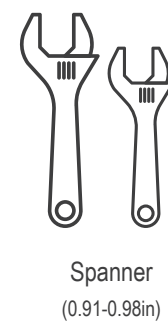
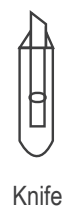
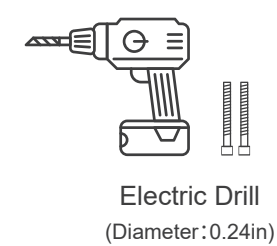

Pre-installation

Hardware Included

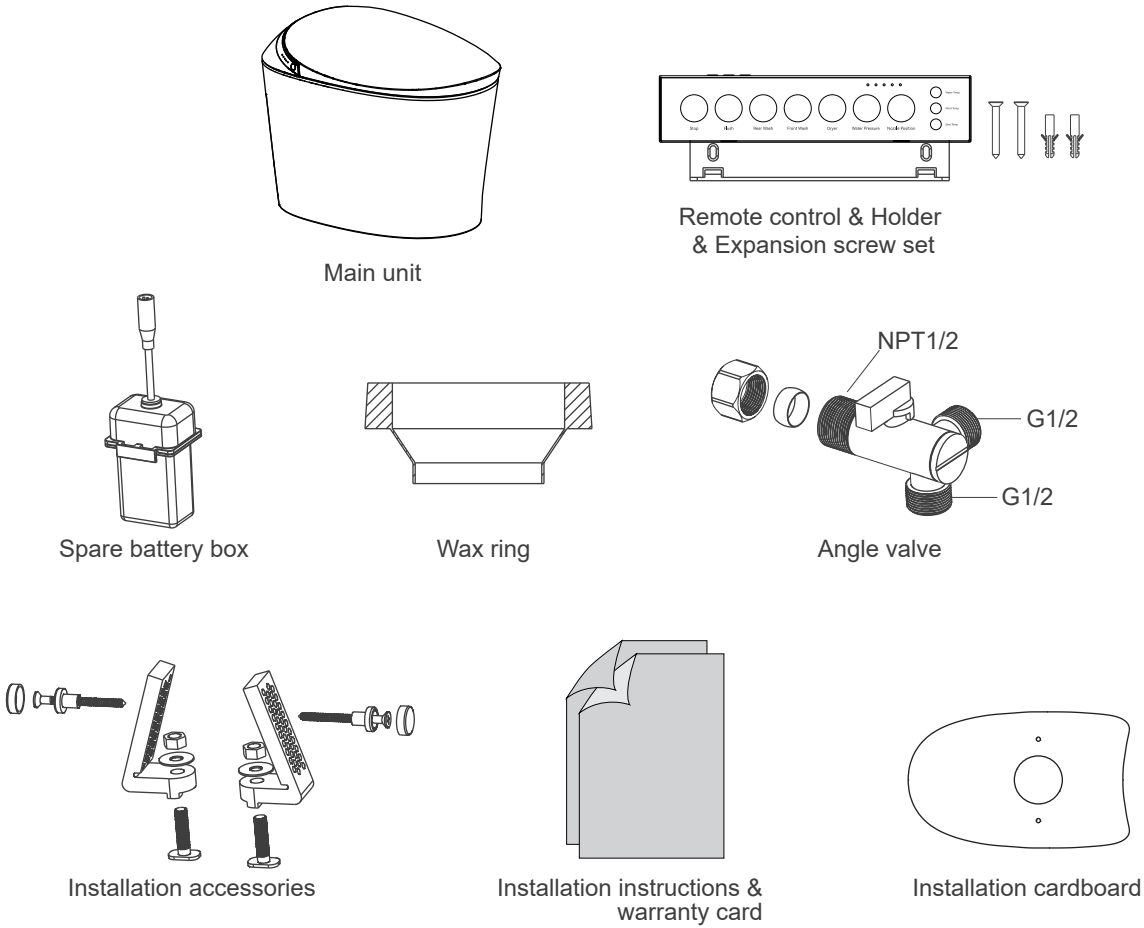

Part	Quantity	Part	Quantity
Main unit	1	Spare battery box	1
Remote control	1		
Wax ring	1		
Angle valve	1		
Installation accessories	1 Set		
User manual	1		
Installation cardboard	1		

Picture for reference only

4. Remote control match code

Before powering on, long press the Front wash button "  " on the remote control. When the indicator lights flash, power on the machine to start remote control paring. Press the Stop button on the remote control or waiting for 10s, the five indicator lights will be off and quit paring mode.



5. Turn on/off pre-wetting inner ring

Long press Rear wash button "  " to turn on/off pre-wetting function.

6. ECO mode

When no one is seated, long press Stop button "  " on the remote control to enter or exit ECO mode. Under ECO mode, the seat temperature will be lowered to the 1st gear automatically. Once human is seated, it will exit ECO mode. When human is off-seat, the ECO mode will resume.

7. Turn on/off automatic flush after user leaving seat

Long press the Flush button "  " and Rear wash button "  " on the remote control to turn on/off automatic flush function after human leaving the seat.

Control function setting

1. Nozzle manual cleaning function

- Press the "Stop" button and "Rear wash" button on the remote control for 3 seconds at the same time to enter the manual cleaning procedure.
Manual cleaning procedure: the nozzle extend out with self-clean water flowing. While the water is flowing out, using a soft cloth to wipe the nozzle. When there are 10 seconds left for cleaning, the machine will make beep sound.
After procedure is finished, the nozzle retracts automatically.

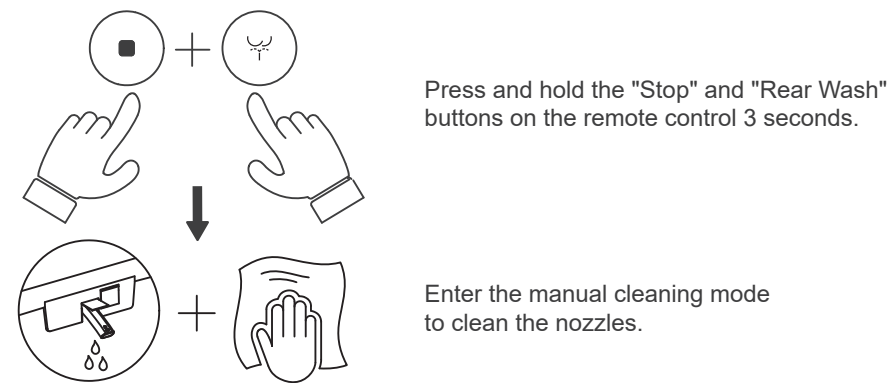

- During the manual cleaning process, press the "Stop" button on the remote control or knob to exit the manual cleaning mode and the nozzle will retract;
- After the manual cleaning is completed or stopped halfway, the nozzle retracts automatically.

2. Nozzle automatic cleaning function

- Press the "Stop" button and "Front Wash" button on the remote control for 3 seconds at the same time to enter the nozzle automatic cleaning mode.
- Automatic cleaning procedure: the nozzle will extend and retract automatically during cleaning process. Totally 10 cleaning cycles. Press the stop button to cease the function halfway.

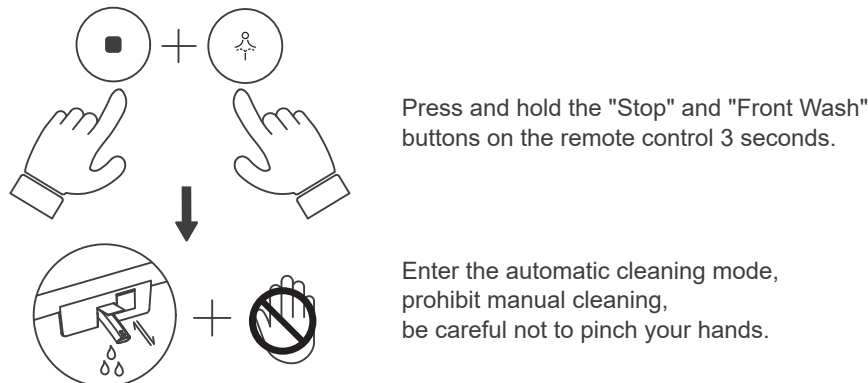

- During the automatic cleaning process, once human seated, it will exit the automatic cleaning mode. The nozzle will stop flowing water and retract.

3. Mute function

- Press the "Stop" and "Drying" keys on the remote control for 3 seconds at the same time to enter the mute mode.
Press the "Stop" and "Drying" keys on the remote control for 3 seconds again to exit the mute mode.
- The buzzer function is off in mute mode.

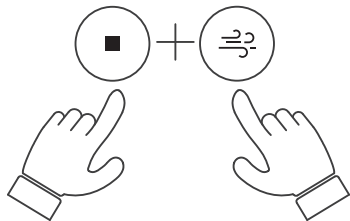

Installation

Technical drawing

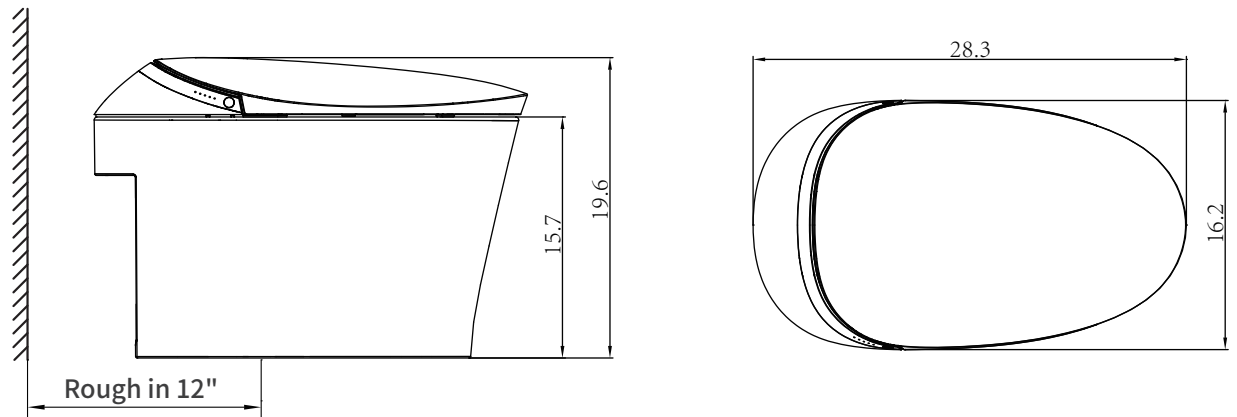

1. Install the offered angle valve

Mark the center line of the drain outlet on the ground, and install the water inlet angle valve at a suitable position on the wall according to the size of the toilet.
After installing the angle valve, open the valve to discharge the sewage.

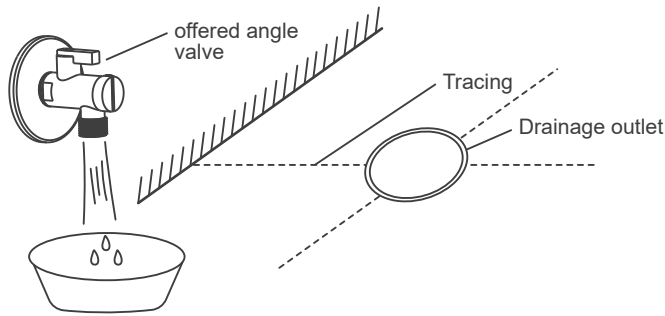

2. Mark the drain with a cross line

Cardboard installation

- Align the cardboard with the center line of the drain;
- Draw contour lines from cardboard.

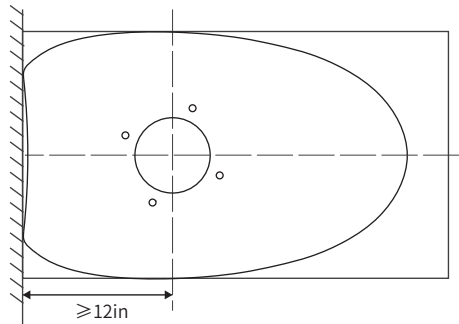

3. Install the flange plate

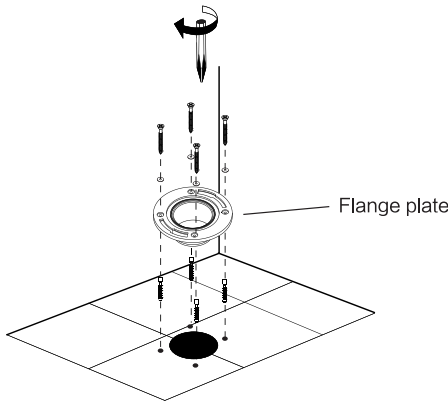

4. Position correctly the two fixing bolts of the flange

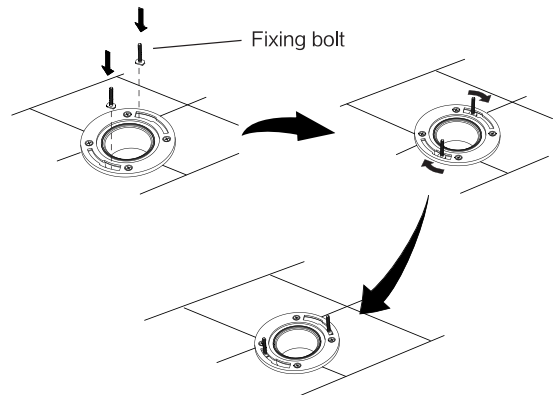

Installation

5. Assemble the mounting bracket with bolts and then install them to the pre-installed flange plate on the ground and lock tight with nuts.

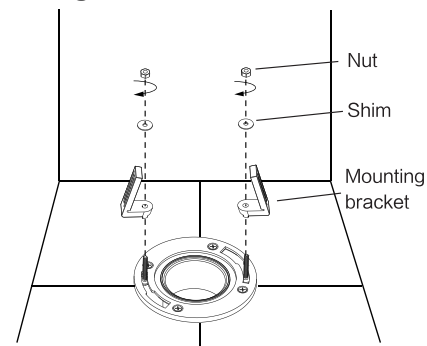

6. Insert the wax ring under the toilet.

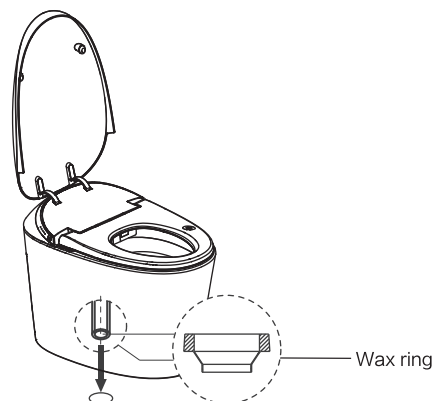

7. Install waxing ring into drain outlet; Install ceramic toilet on corresponding position according to contour line.

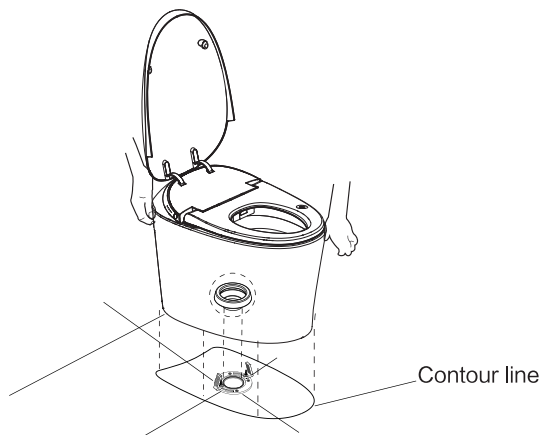

8. Put the screw through the fixing sleeve and then install it through the holes (on both sides of the toilet ceramic) to the mounting bracket on the ground, and lock tight with a tool, put the decorative cap on the fixing sleeve.

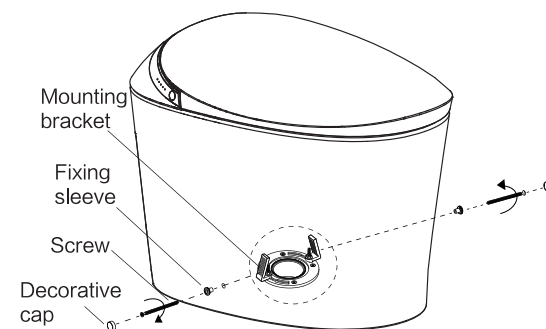

9. Connect hose and angle valve

As shown in the figure below, connect and tighten the inlet hose, angle valve and filter.

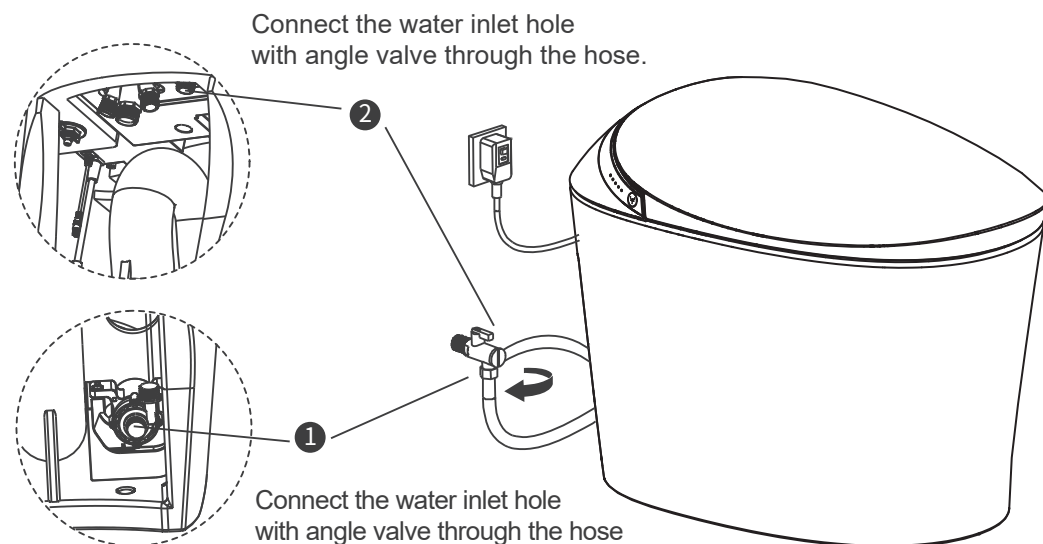

Water temperature adjustment



When cleaning, the water temperature is adjustable with 6 gears. When in off gear, the water flows in ambient temperature and the indicator light is off.

Air temperature adjustment



When drying, the air temperature is adjustable with 6 gears. When in off gear, it blows in ambient temperature and the indicator light is off.

Seat temperature adjustment



The seat temperature is adjustable with 6 gears. Please do not cover the seat sensor in case of sensing failure. The seat temperature will switch to 1st gear after long time sitting in case of low-temperature burns.

Top view of remote control



Pulse massage



When performing rear washing and front washing functions, press the massage button on the remote control to enter the pulse massage mode.

Night light



Press this button to turn on/off night light.
Note: Long press this button for 5 seconds to turn on/off the indicator light on the knob.

Half Flush



Press this button to perform the half flush function.

Remote Control Instructions

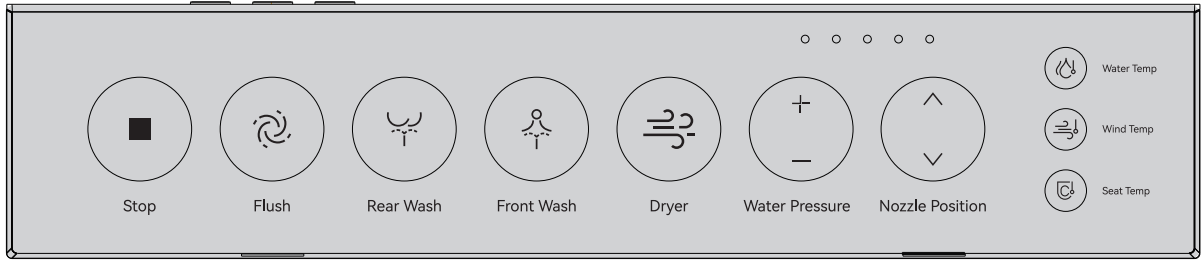

Stop

- 1. Short press stop button to cease on-going functions halfway.
- 2. Long press stop button for 5 seconds to enter ECO mode.
- 3. Long press stop button for 5 seconds to exit ECO mode.

Full flushing

Short press the flush button to perform the flushing funtion.

Rear wash/Oscillating massage

Press this button to start the rear wash function. Press this button again to perform oscillating massage. If you press the Stop key halfway, you can stop it immediately.
Note: Under the oscillating massage procedure, the nozzle will extend and retract repeatedly toachieve the massage effect.

Front wash/Oscillating massage

Press this button to start the front wash function. Press this button again to perform oscillating massage. If you press the Stop key halfway, you can stop it immediately.
Note: Under the oscillating massage procedure, the nozzle will extend and retract repeatedly to achieve the massage effect.

Dryer

Press this button to perform warm air drying. The air temperature can be adjusted. If it is pressed to "stop"button on the way, the air drying can be stopped immediately.

Water pressure adjustment

When cleaning, press this button to adjust water pressure in 5 different gears. Press + key once to raise one level, press - key once to decrease one level. The indicator light will display accordingly.

Nozzle position adjustment

The nozzle position can be adjusted with 5 gears. Press the nozzle adjustment ^ key to extend the nozzle forward, press the nozzle adjustment v key to retract nozzle backwards.

10. Install the battery box

- 1. Put battery (9V, not included) in the battery box.
- 2. Connect the cable

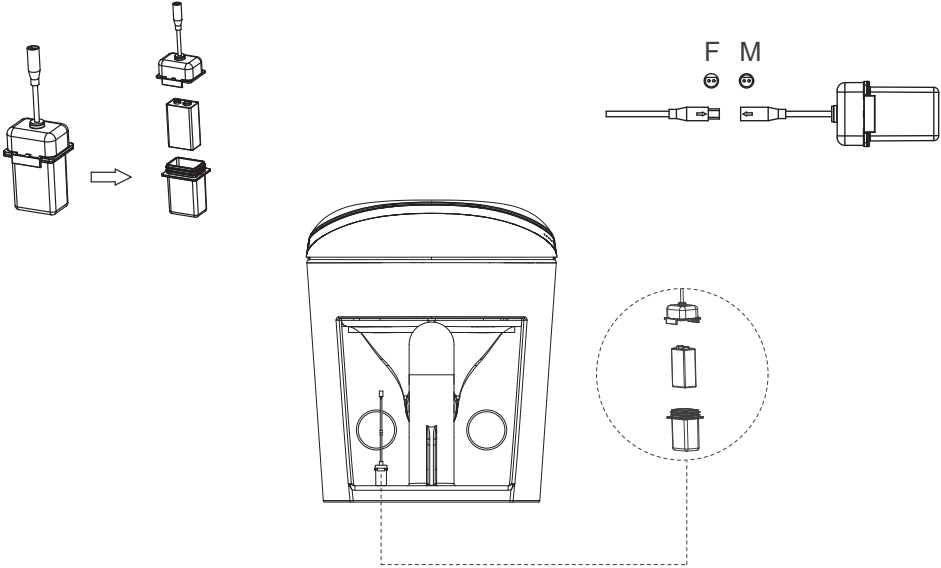

Battery replacement

- 1. Remove the battery box from the back of the toilet and pull out the battery box connector.
- 2. Open the battery box, remove the old battery and replace it with a new one.
- 3. Plug in the battery box connector and the toilet cable and put them back on the back of the toilet.

11. Open the angle valve

Check the tightness of the threaded connection to make sure there is no water leakage. Turn the angle valve counterclockwise and adjust the opening to the maximum.

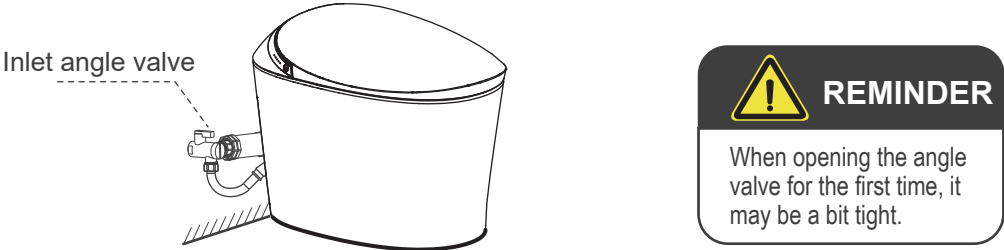

12. Power on

Plug the leakage protection plug into the power socket, press the reset switch, and the plug indicator light will be on, indicating that it is powered on.

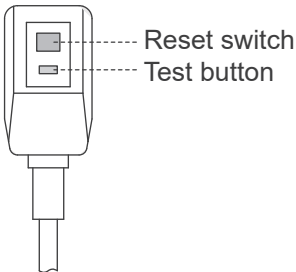
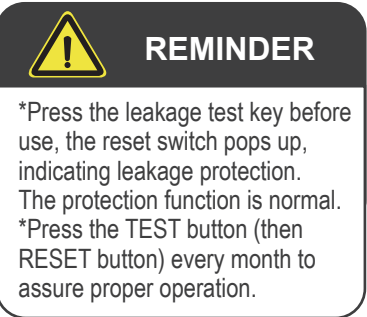

*It is applicable to the model with leakage protection plug. The leakage protection plug is subject to the actual object.

13. Safety self-inspection

After powering on, the cleaning nozzle will extend forward and retract. After machine beeping the sound, indicating the self-inspection is completed.

Remote Control Installation and Battery Replacement

Install remote control

1-1. Install the remote control holder

1. Stick the remote control rack horizontally to the pre-installation area on the wall, and mark the position of two installation holes on the wall with a marker. Use a drill bit with a diameter of 6mm to drill holes at the marked positions on the wall, with a depth of 1.4in.

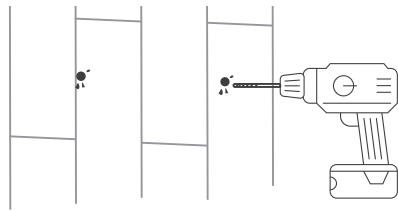

2. Install the expansion pipe into the wall hole, attach the hanger to the wall, align the hole on the hanger with the expansion pipe, and place the screw to lock it.

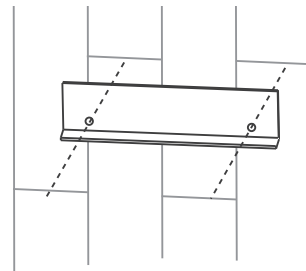

1-2. Install the remote control holder (only for the hanger with fixed plate and foam rubber pad)

1. Clean and dry the pre-installed area of the remote control rack on the wall.

2. Tear off the double-sided adhesive sticker on the back of the hanger and stick it horizontally to the wall.

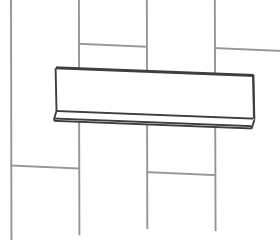
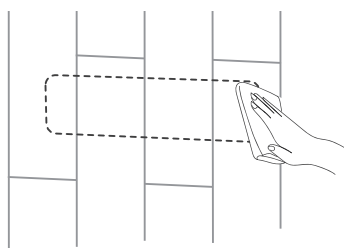

2. Install the battery into the remote control, and place it on the rack.

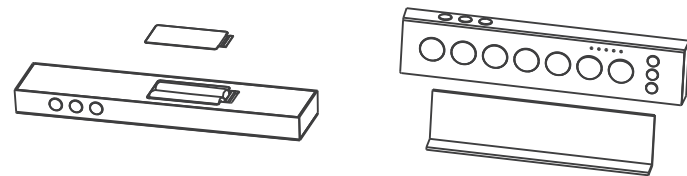

3. Use and replacement of remote control battery

· The remote control uses 2 AAA alkaline batteries.

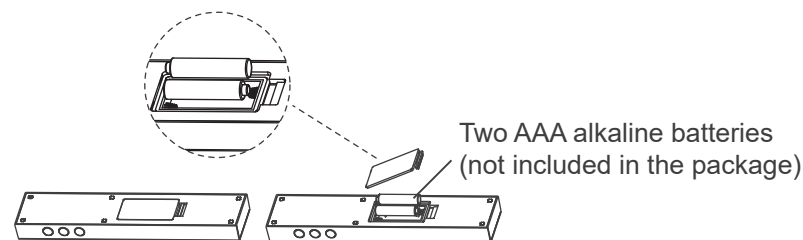

Attention

1. The positive and negative electrodes of the battery must match those on the remote control.
2. New and old batteries cannot be mixed.
3. Please use alkaline battery.

Button&Indicator light Instructions

Indicator light

The seat temperature is displayed by default, and the number of lights corresponds to the corresponding level; When a function is executed (rear wash, front wash, drying), the current temperature level will be displayed.

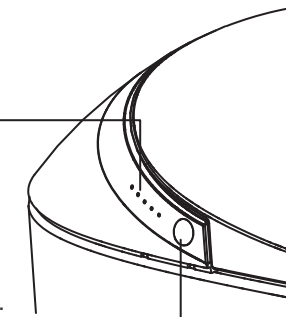

Rear wash

Press this button to activate the rear wash function. When the cleaning function is finished, it will automatically switch to the drying function.

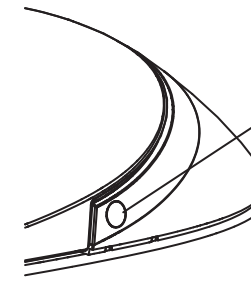

Flush/Stop

Under non-functional status, press this button to perform full flush function. While machine is running functions, press this button to stop on-going procedure. Note: Under non-seated situation, long press this button to enter standby mode, in which mode the night light automatically off. Press any button to quit standby mode.

Note for Ultraviolet Sterilization Function:

After carrying out the cleaning function, human leave the seat, and there is no other operation within 30 seconds, the UV sterilization light will automatically turn on. The sterilization process will continue for approximately 3 minutes. The sterilization function will automatically off once human is seated.