



Lassen™
33" all-in-one top-/undermount single-bowl kitchen
sink kit
K-RH33839-1PC

Features

- 36" (914 mm) minimum base cabinet width
- Single bowl
- 9-1/8" (232 mm) depth provides generous workspace
- Distinct angles and corners make sink easy to clean
- Rear offset drain increases workspace in the sink and storage space underneath
- SilentShield® sound-absorption technology offers quieter performance
- Single faucet hole
- Two-function pull-down sprayhead allows you to switch from aerated stream to Sweep® spray
- Sweep® spray features specially angled nozzles that form a wide, powerful blade of water to sweep your dishes and sink clean
- MasterClean™ sprayface features an easy-to-clean surface that withstands mineral buildup and maximizes spray performance
- Box includes: Sink, assembled Vibrant Stainless pull-down faucet, drain and strainer, cutout template

Material

- Handcrafted from 18-gauge stainless steel

Installation

- Top-mount or undermount

Recommended Products/Accessories

K-33798 Sink rack
K-21613 Bamboo cutting board
K-21614 Colander set

Included Components

K-30822 Semi-professional kitchen sink faucet with two-function sprayhead
7400 Stainless Steel Sink Drain and Strainer



Codes/Standards

ASME A112.19.3/CSA B45.4
ASME A112.18.1/CSA B125.1
NSF/ANSI/CAN 61
NSF/ANSI/CAN 372
DOE - Energy Policy Act 1992
California Energy Commission (CEC)
IAPMO Certification

KOHLER® Stainless Steel Sinks Lifetime Limited Warranty

See website for detailed warranty information.



Lassen™
33" all-in-one top-/undermount single-bowl kitchen
sink kit
K-RH33839-1PC

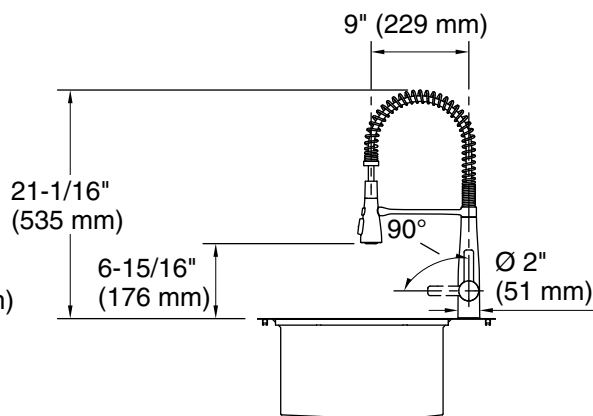
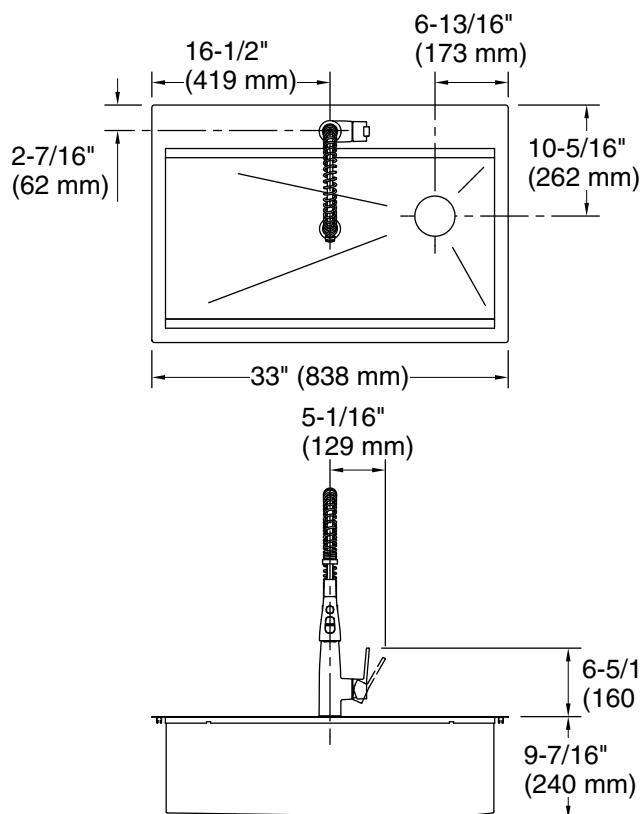

Technical Information

All product dimensions are nominal.

Bowl configuration: Single

Min. base cabinet width: 36" (914 mm)

Bowl area (Basin #1): Length: 30-1/4" (768 mm)
Width: 14-15/16" (379 mm)
Bowl depth: 9-3/16" (233 mm)
Water depth: 9" (229 mm)

Number of deck holes: 1

Faucet hole(s): 1-7/16" (37 mm)

Drain hole: 3-3/4" (95 mm)

Template: Top-mount/Undermount, 1130821-7, required, included

Notes

Install this product according to the installation instructions.

NOTICE: Countertop manufacturer or cutter must use the cut-out template provided with the product, or a current one provided by Kohler Co. (call 1- 800-4KOHLER). Kohler Co. is not responsible for cutout errors when the incorrect cut-out template is used.