

ASSEMBLY INSTRUCTIONS - DRAWER BASE CABINET (2 DRAWERS)

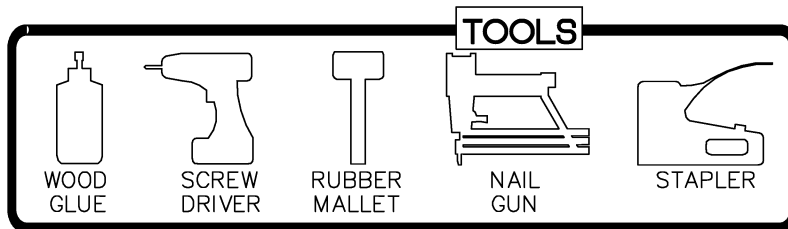
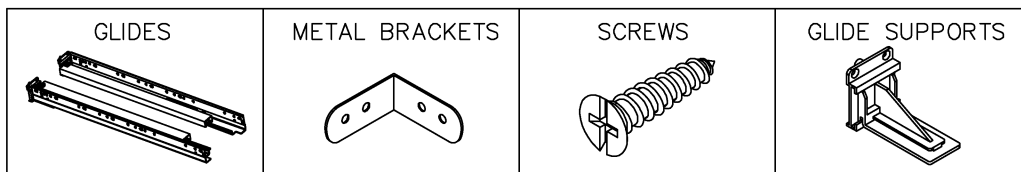
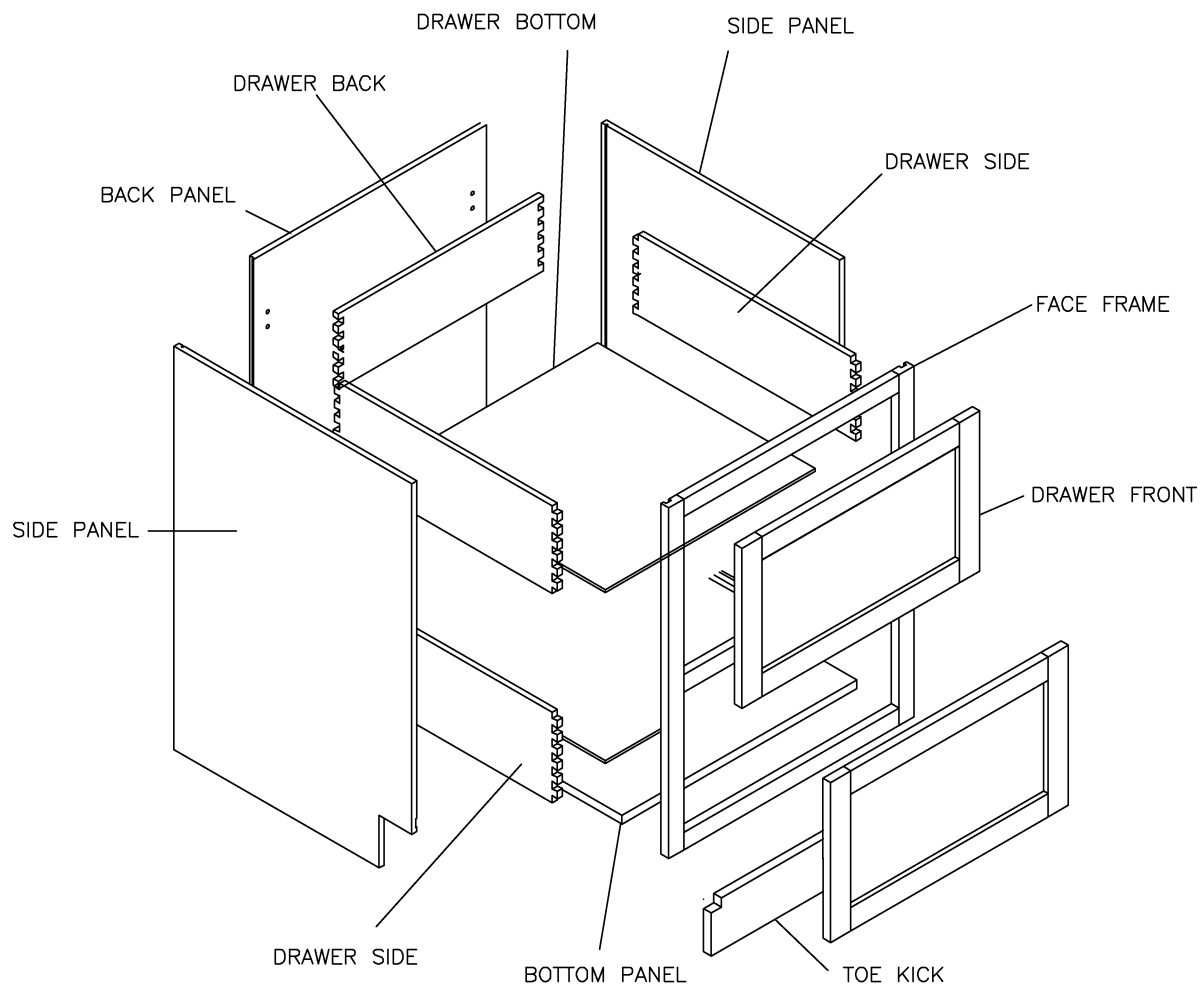

This instruction applies to the following items:
2DB30, 2DB33, 2DB36

STEP
1

Glue each assembly slot

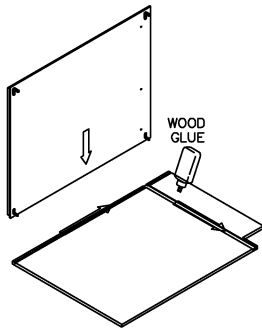

STEP
2

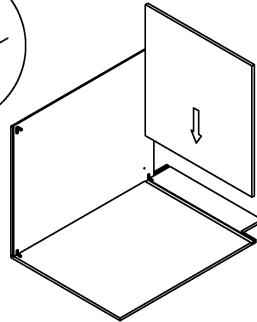
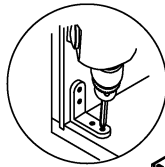

STEP
3

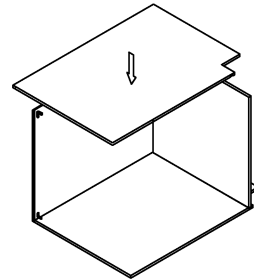

STEP
4

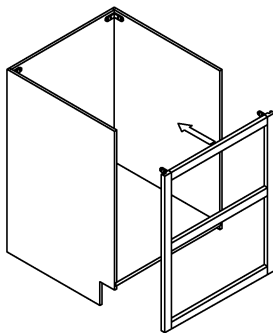

STEP
5

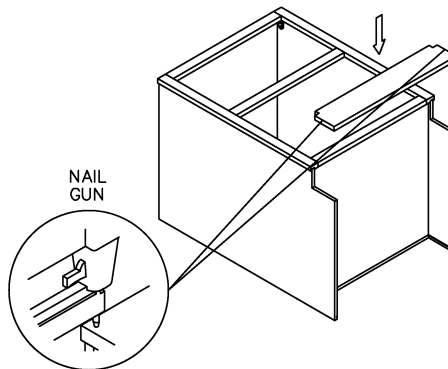

STEP
6

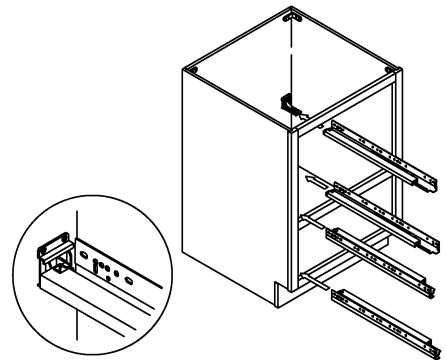

STEP
7

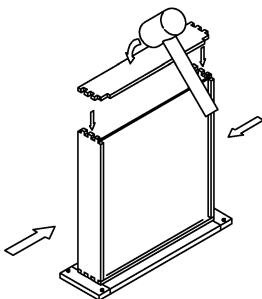

STEP
8

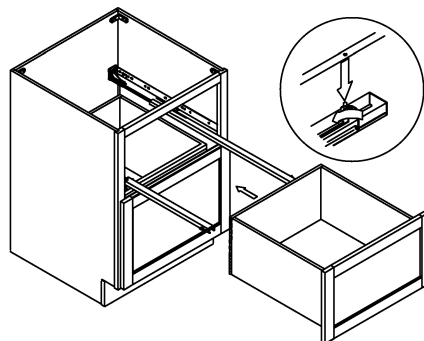

STEP
9

