

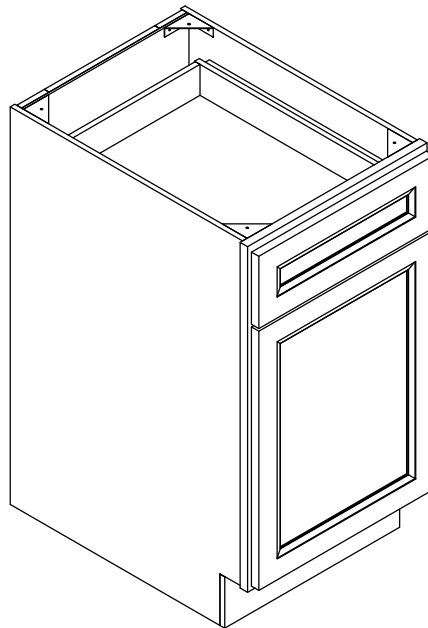

PELHAM & WHITE

Owner's Manual & Installation Guide

One-Door Base Kitchen Cabinets



Model #	
KB12	KB21
KB15	KB24
KB18	

Note: Read all instructions before proceeding with installation. All specifications are subject to change without notice.

Questions? Contact Us:

1-855-561-5222 • info@pelhamandwhite.com



PELHAM & WHITE

ONE-DOOR BASE CABINET ASSEMBLY & INSTALLATION GUIDE

Unpack and inspect your cabinet upon delivery to avoid costly contractor delays.

Package Contents

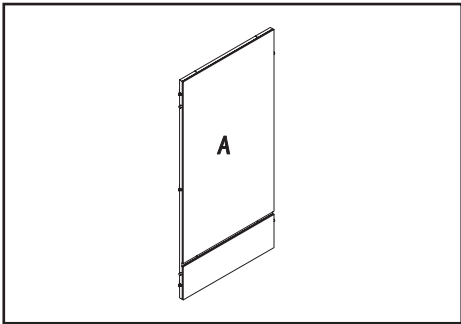

A. Back Panel x1

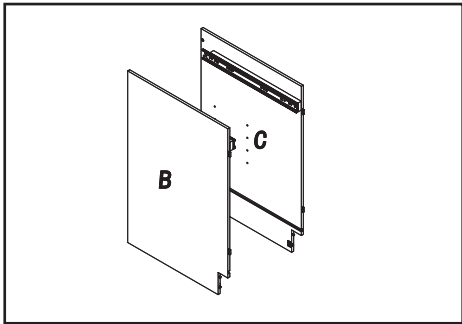

B. Left Panel x1
C. Right Panel x1

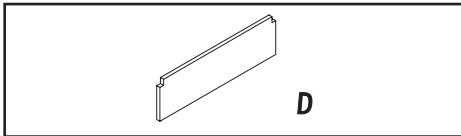

D. Toe Kick x1

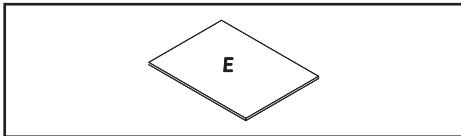

E. Bottom Panel x1

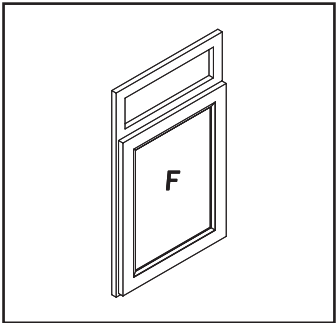

F. Front Face x1

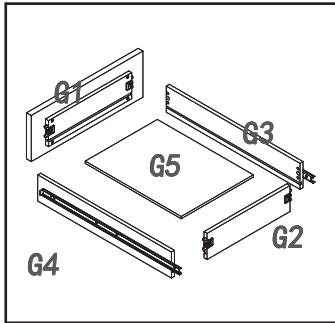

G. Drawer x1

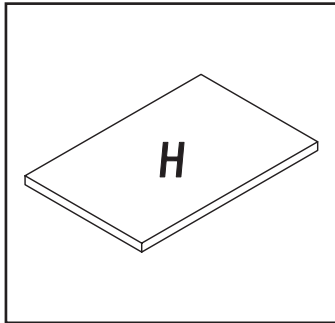

H. Shelf x1

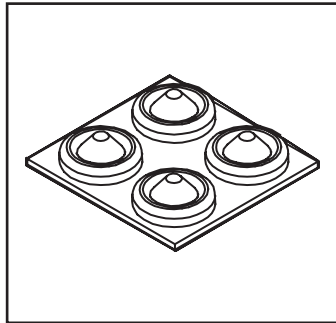

BB. Silicone Pads x6

Optional Installation Hardware

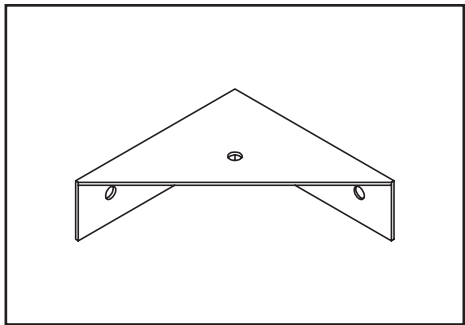

CC. Metal Brackets & Screws x4

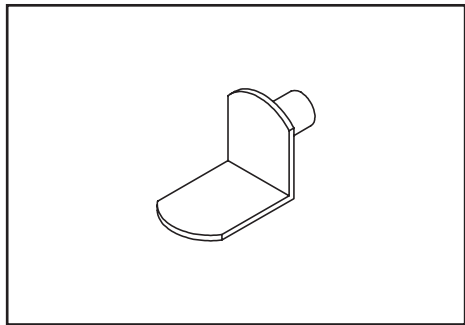

DD. Shelf Clips x4

Base Cabinet Assembly Guide

1

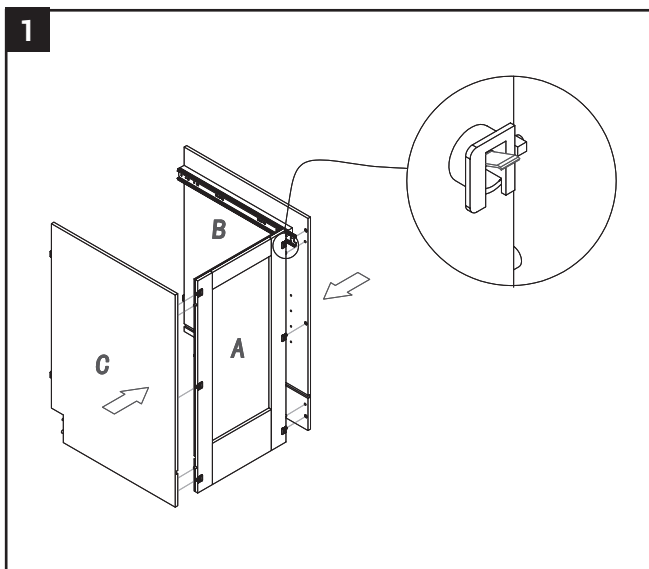

Step 1:

Attach back panel (A) to left side panel (B) and right side panel (C), flip the cam-locks to secure in place.

2

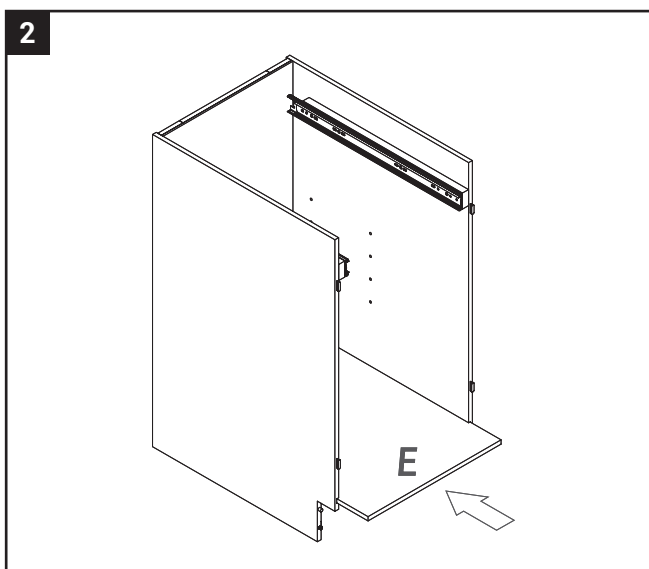

Step 2:

Insert bottom panel (E) into assembled unit.

3

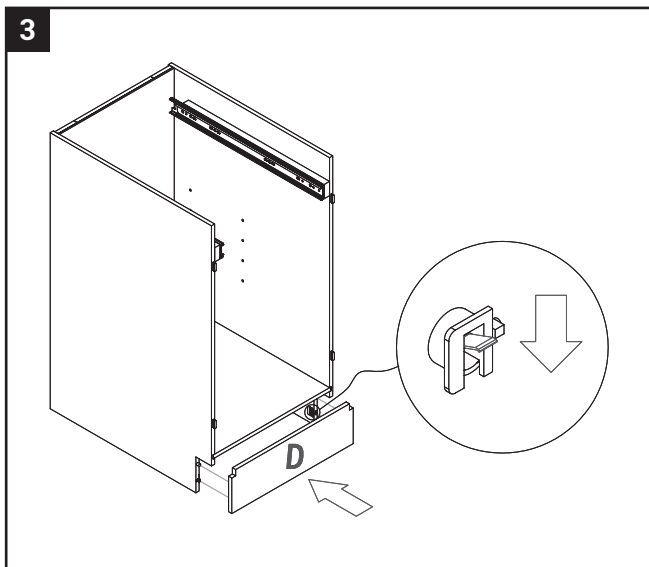

Step 3:

Attach toe kick (D) to the assembly unit by flipping the cam-locks, make sure they are in place.

4

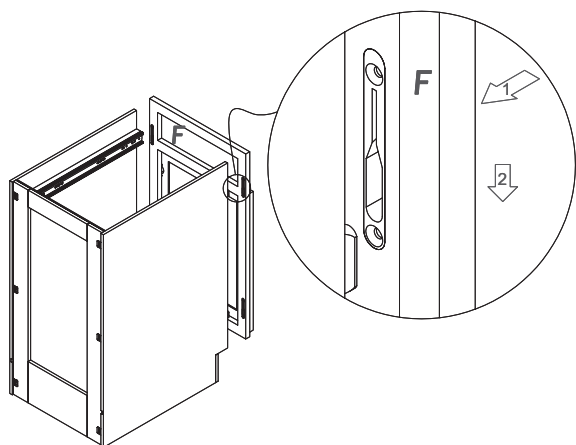
**Step 4:**

Attach front face (F) to assembled unit by inserting the tabs on the left and right side panels into the slots, and pushing down until the panel slide into the place.

5

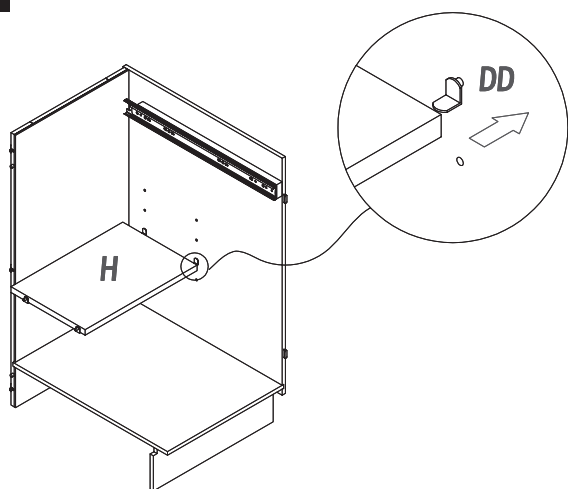
**Step 5:**

Insert shelf support (DD) into the holes on the side panels, put on the shelf panel (H).

6

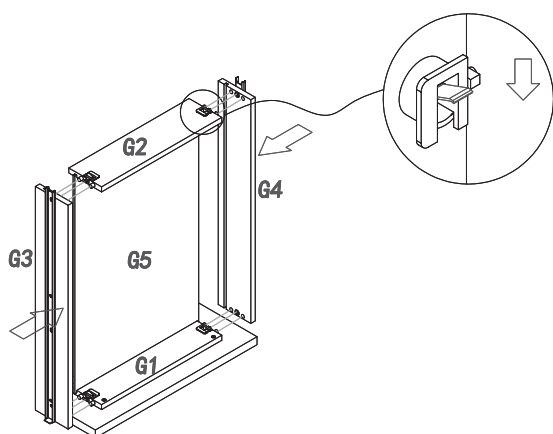
**Step 6:**

Attach drawer side panels (G3) to drawer back panel (G2) by flipping cam-locks, insert drawer bottom panel (G4), attach drawer front panel (G1) by flipping cam-locks.

7

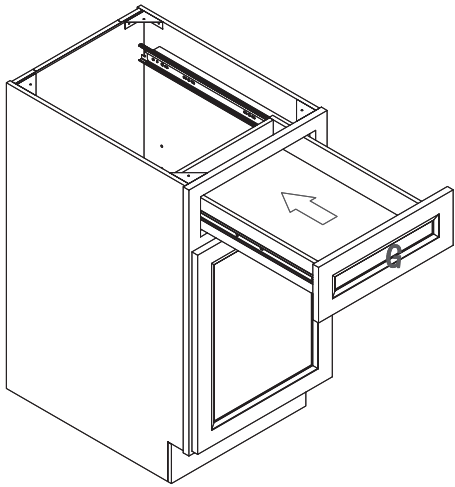

Step 7:

Insert the drawer (G) into the cabinet.

Base Cabinet Installation Guide

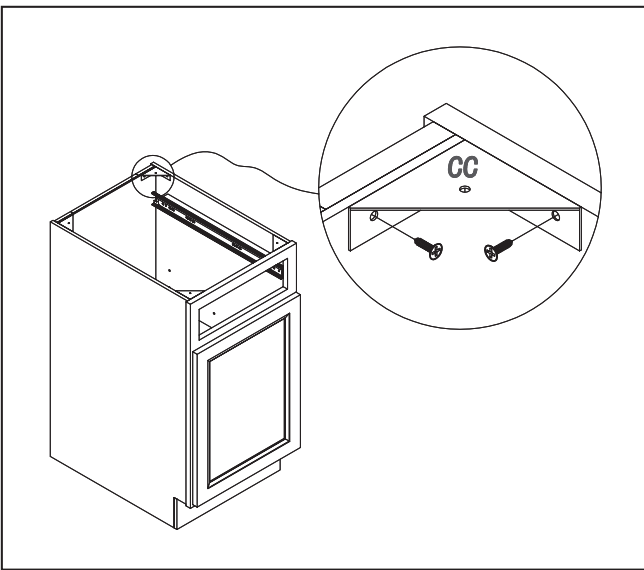

For additional support on cabinets that will be loaded with heavy contents, we have included corner brackets to be used when installing. For base cabinets, these brackets can also be used to secure counter-tops with wood substrates.

IMPORTANT: DO NOT ATTACH CABINET SOLELY INTO DRYWALL.

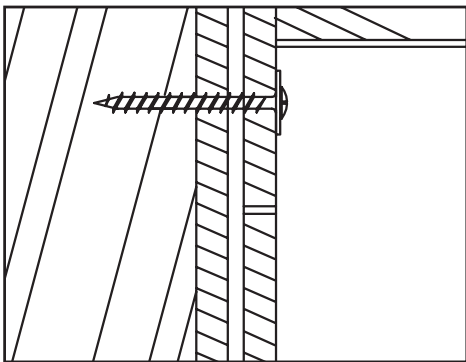

STUDS:

Secure to wall with #10 x 3" screws at stud location.

Important: Use "pan head" or "round head" screws with seat washers. Seat screws tightly against back rail or panel without driving into back rail or panel material.

STARTING IN A CORNER:

Always start in a corner where two runs of cabinets will come together or at the end of the cabinet run (if there is no corner.) All doors and drawers will need to be removed prior to installation.

Locate and mark wall studs for mounting hardware placement. Cabinets must be mounted to studs where available. Place the cabinet into position, use a level and shims (if needed) to ensure cabinet is level and plumb. **IMPORTANT:** Shim cabinets square (flat) to the wall so there are no gaps between back of cabinet and wall in the mounting area.

Drill a 3/16" pilot hole at the stud locations through the back panel and into the stud. Make sure to position screws 1" or more from the top, bottom and sides. Mount the cabinet to the wall with hardware appropriate for your wall type. Once your corner cabinets have been installed, work outward to install the remaining cabinets.

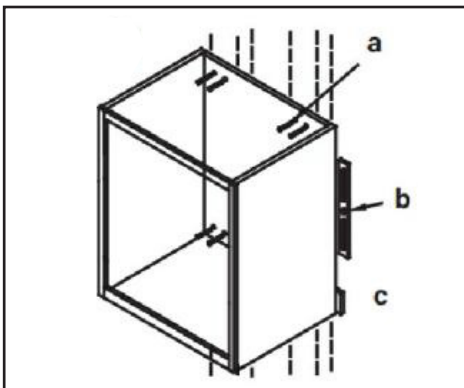

- a. Mounting hardware
- b. Check to level & ensure square flat to wall
- c. Shim if necessary, installation shims are not included

ATTACH CABINETS TOGETHER:

After the corner cabinet is secured to the wall, use clamps to align the next cabinet to the first cabinet. Use a level to be sure the adjoining cabinets are flush and level with each other. If needed, shim the cabinets to level.

Drill a 1/8" pilot hole in the face frame above or below each door hinge location. Attach the second cabinet to the first cabinet using a #8 x 2 1/2" screw and counter sink for best appearance. Always attach cabinets together at the face frame as shown. Do not attach through the cabinet side panel.

ATTENTION: You must drill pilot holes to attach cabinets together. Cabinet drawers and doors should line up as shown below.

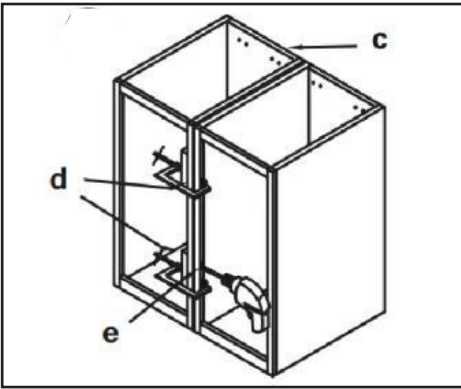

INSTALL REMAINING CABINETS:

Drill a 3/16" pilot hole at the stud locations through the back panel and into the stud. Level and mount the cabinet to the wall with hardware appropriate for your wall type. If needed, shim the cabinet to level.

DO NOT COMPLETELY TIGHTEN MOUNTING SCREWS UNTIL ALL CABINETS HAVE BEEN ATTACHED TOGETHER.

- a. Mounting hardware
- b. Check to level & ensure square flat to wall
- c. Shim if necessary, installation shims are not included
- d. Scrap Block
- e. 1/8" Diameter

After all cabinets have been attached together and are level and secure, then tighten all mounting screws. Take care to seat mounting screws tightly against back panel without driving into back panel material. Check to be sure that all cabinets remain level after tightening.

NOTE: To attach a wall cabinet to a TALL PANTRY unit, drill a 1/8" pilot hole 7/8" deep through the wall cabinet face frame to the tall pantry unit. Use a #8 x 1-5/8" screw to secure cabinets together. After cabinets are installed it will be necessary to adjust doors and drawers for proper alignment.

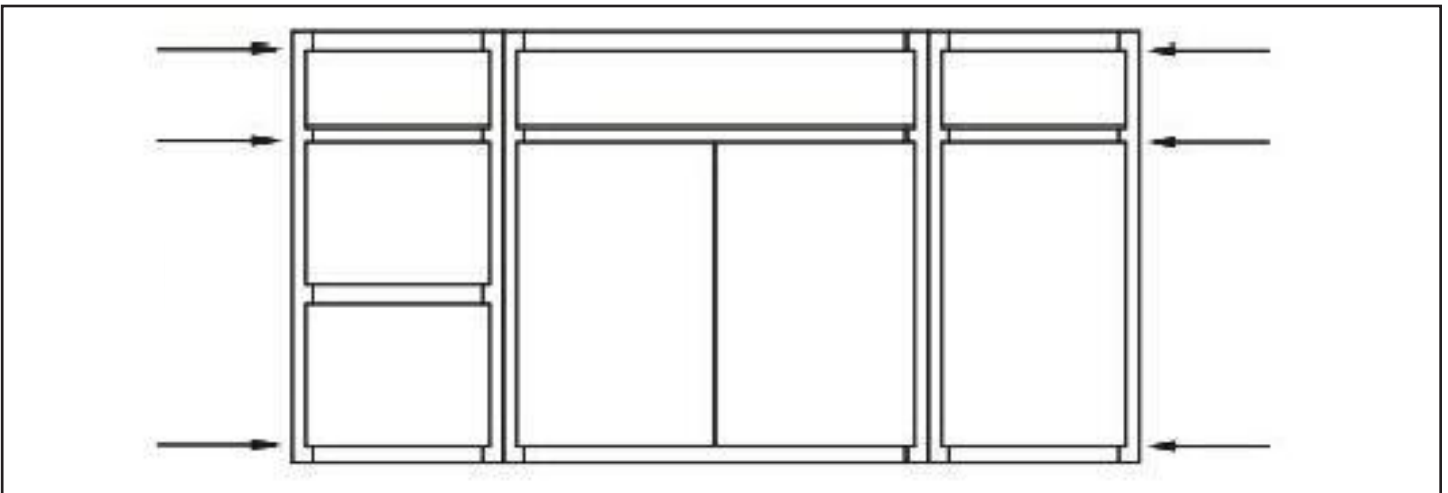

DOOR AND DRAWER ALIGNMENT:

After cabinets are installed it will be necessary to adjust doors and drawers for proper alignment.

HINGE ADJUSTMENT:

Review the illustrations to locate the hinge on your specific cabinet.

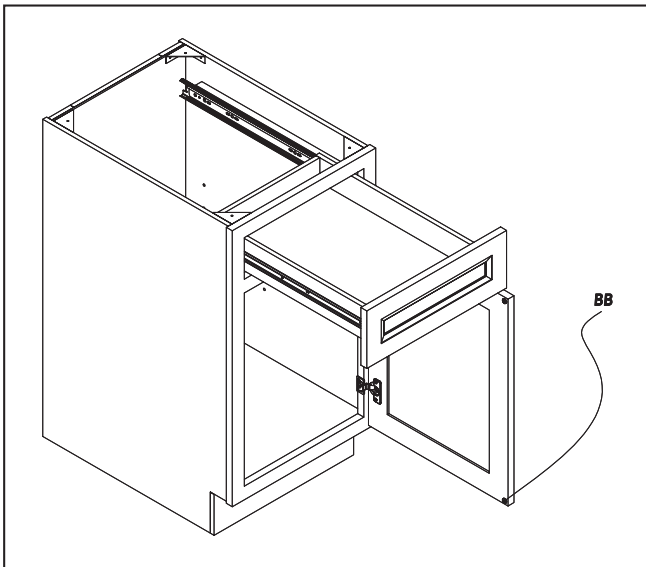
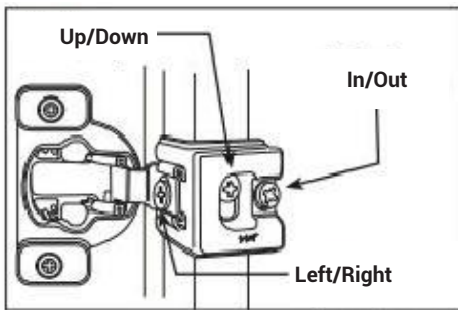

Silicone Pads:

Attach silicone pads (BB) on the top and bottom corners of each door.

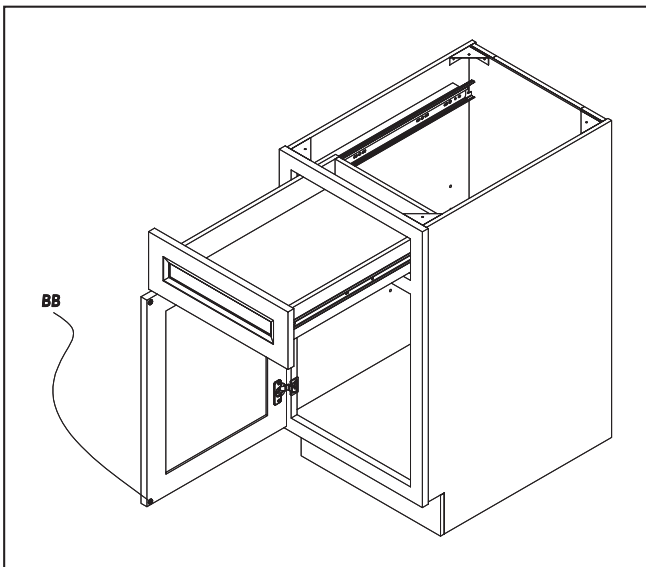

Door panel can be assembled on the other side as required, please remove hinge to install on the other side which are predrilled. Drill and install the cabinet pulls/knobs as preferred.

Care & Maintenance

To keep the product clean & shining, follow the steps below.

1. For normal spills, a damp cloth is sufficient. Dry the surface immediately.
2. Cabinets can be cleaned with most general purpose household cleaners.
3. Do not use caustic agents and/or abrasive scrubbers, or oven cleaners.
4. Do not allow liquids to remain on the surfaces for long periods of time.



Limited Warranty

Pelham & White products are manufactured with superior quality standards and workmanship and are backed by our limited 15 year warranty. Our warranty is limited to residential applications. We will repair or replace free of charge any product or parts that prove defective. Our warranties are extended exclusively to the original purchaser or owner covering defects in material and workmanship. Damage caused by wear and tear, accident, misuse, or abuse is not covered by this warranty, as is damage done by disregarding the care recommendations provided in the installation instructions, or improper installation. This warranty may not cover products not installed by a qualified professional installer. Our warranty covers the replacement of the defective product only and does not cover installation or other consequential costs or damages. Proof of purchase (original sales receipt) from the original consumer purchaser must be made available for all Pelham & White warranty claims. Authorized Pelham & White representatives are not agents of Pelham & White, and no agent, dealer, representative, salesperson, or other person is authorized to change, modify, expand, or extend the limited warranties contained herein, or to bind Pelham & White or any of its authorized representatives to be held for injury or damage to any person or property for any claim, regardless of how claims arise. This warranty gives you specific legal rights, and you may also have other rights which vary from state to state. Some states do not allow the exclusions or limitations of incidental or consequential damages, so the above limitations or exclusions may not apply to you. For warranty claims or questions, contact Pelham & White at 855-561-5222. All measurements are approximations and should be used for reference only. Pelham & White reserves the right to make specification changes without notice or obligation, and to change or discontinue models and finishes.



PELHAM & WHITE

548 South Columbus Avenue • Mount Vernon, New York 10550
1-855-561-5222 • www.pelhamandwhite.com

All rights reserved.
Copyright Pelham & White 2024.