

# HAMPTON BAY®

## USE AND CARE GUIDE

---

### PANTRY

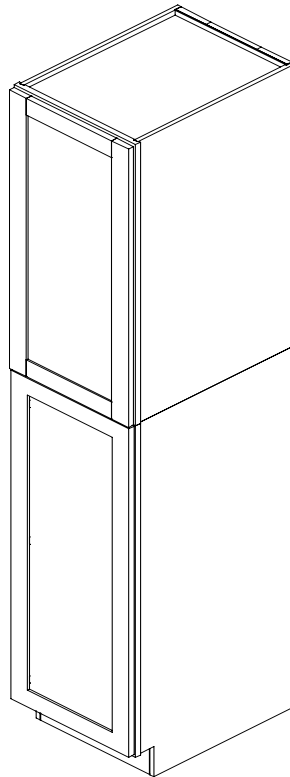

Questions, problems, missing parts? Before returning to the store,  
call Hampton Bay Customer Service  
8 a.m. – 7 p.m., EST, Monday – Friday, 9 a.m. – 6 p.m., EST, Saturday

1-855-HD-HAMPTON

HAMPTONBAY.COM

---

#### THANK YOU

*We appreciate the trust and confidence you have placed in Hampton Bay through the purchase of this Cabinet. We strive to continually create quality products designed to enhance your home. Visit us online to SEE our full line of products available for your home improvement needs. Thank you for choosing Hampton Bay!*

# Table of Contents

Table of Contents .....2

Safety Information.....2

    CALIFORNIA RESIDENTS.....2

    MINNESOTA RESIDENTS .....2

Warranty .....2

Introduction to CLICKREADY Technology .....3

Pre-Assembly .....4

    BEFORE YOU BEGIN.....4

    PEOPLE REQUIRED .....4

    TOOLS REQUIRED .....4

    HARDWARE INCLUDED .....4

Pre-Assembly ..... 5

    PACKAGE CONTENTS.....5

Cabinet Assembly ..... 6

Cabinet Assembly (Continued) ..... 8

Before Putting in Use ..... 13

Care and Cleaning ..... 14

# Safety Information

Please read and understand these instructions before you begin this assembly.

## CALIFORNIA RESIDENTS



**WARNING:** This product can expose you to chemicals including Formaldehyde (GAS), which is [are] known to the State of California to cause cancer. For more information go to [WWW.P65Warnings.ca.gov/products](http://WWW.P65Warnings.ca.gov/products).

**⚠WARNING**

- Unit must be placed on a level surface or leveled with shims.
- Do not sit or stand on or allow children to climb, sit or stand on the assembled product.
- For safety reasons, it is imperative that this unit be mounted to the wall.
- Unit can tip over causing severe injury or death.
- Do not exceed the recommended weight limits.
- Evenly distribute the weight on each level and always keep the heavier loads on the bottom.
- Before cutting, drilling, or hammering into any wall or floor surface, verify the location of electrical, plumbing and gas lines. Cutting may cause serious injury.

## MINNESOTA RESIDENTS

### IMPORTANT HEALTH NOTICE

SOME OF THE BUILDING MATERIALS USED IN THIS HOME (OR THESE BUILDING MATERIALS) EMIT FORMALDEHYDE. EYE, NOSE, AND THROAT IRRITATION, HEADACHE, NAUSEA AND A VARIETY OF ASTHMA-LIKE SYMPTOMS, INCLUDING SHORTNESS OF BREATH, HAVE BEEN REPORTED AS A RESULT OF FORMALDEHYDE EXPOSURE. ELDERLY PERSONS AND YOUNG CHILDREN, AS WELL AS ANYONE WITH A HISTORY OF ASTHMA, ALLERGIES, OR LUNG PROBLEMS, MAY BE AT GREATER RISK. RESEARCH IS CONTINUING ON THE POSSIBLE LONG-TERM EFFECTS OF EXPOSURE TO FORMALDEHYDE.

REDUCE VENTILATION MAY ALLOW FORMALDEHYDE AND OTHER CONTAMINANTS TO ACCUMULATE IN THE INDOOR AIR. HIGH INDOOR TEMPERATURES AND HUMIDITY RAISE FORMALDEHYDE LEVELS. WHEN A HOME IS TO BE LOCATED IN AREAS SUBJECT TO EXTREME SUMMER TEMPERATURES, AN AIR-CONDITIONING SYSTEM CAN BE USED TO CONTROL INDOOR TEMPERATURE LEVELS. OTHER MEANS OF CONTROLLED MECHANICAL VENTILATION CAN BE USED TO REDUCE LEVELS OF FORMALDEHYDE AND OTHER INDOOR AIR CONTAMINANTS.

IF YOU HAVE ANY QUESTIONS REGARDING THE HEALTH EFFECTS OF FORMALDEHYDE, CONSULT YOUR DOCTOR OR LOCAL HEALTH DEPARTMENT.

# Warranty

Contact the Customer Service Team at 1-855-HD-HAMPTON or visit [www. Hamptonbay.com](http://www.Hamptonbay.com).

# **CLICK READY™** 101

## Introduction to **CLICKREADY** Technology

Powered by **OVVO**



This cabinet uses **PERMANENT** Ready to Assemble (RTA) technology that **CANNOT** be disassembled. You must carefully review instructions and ensure proper alignment during assembly.

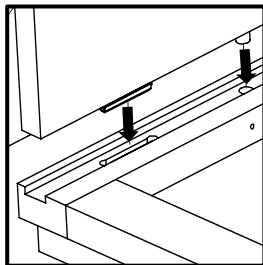

All connectors and dowels must line up when assembling cabinet.

Quantity of connectors/dowels depends on the cabinet type and size.

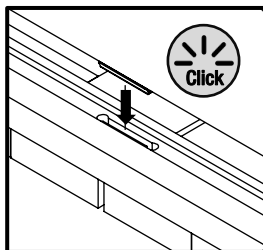

There will be a “clicking” sound when the connectors lock together properly.

**BEFORE INSTALLATION, ENSURE ALL CONNECTORS ARE LOCKED IN PLACE AND SEATED.**

# Pre-Assembly

## BEFORE YOU BEGIN

Compare all parts with the Hardware Included and Package Contents sections. If any part is missing or damaged, do not assemble this product. Contact Customer Service.

Assemble the cabinet on a soft surface such as carpet or the cardboard container of this product.

## PEOPLE REQUIRED



BASE CABINETS with a width greater than or equal to 27" , CORNER WALL CABINET, LAZY SUSAN CABINET, PANTRY, OVEN CABINET require two people to assemble.

## TOOLS REQUIRED

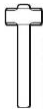

Rubber  
mallet

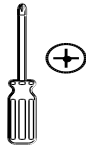

Phillips  
screwdriver

## HARDWARE INCLUDED



**NOTE:** Hardware not shown to actual size.

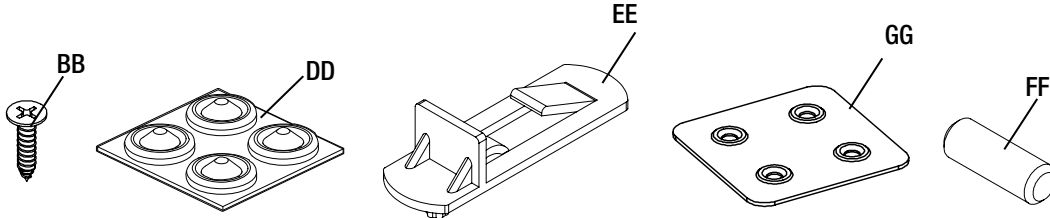

*\* Extras quantity is provided based upon your cabinet*

Part	Description	Qty. Top Cabinet	Qty. Bottom Cabinet
BB	M4 x 15 mm Screws (silver)	32	
DD	Silicone Pads	2	2
EE	Shelf Pin	4-8	8
GG	Metal brackets	8	
FF	Wooden dowel	0	2



**NOTE:** Metal brackets GG and screws BB are packed inside the BASE CABINET package

# Pre-Assembly

## PACKAGE CONTENTS

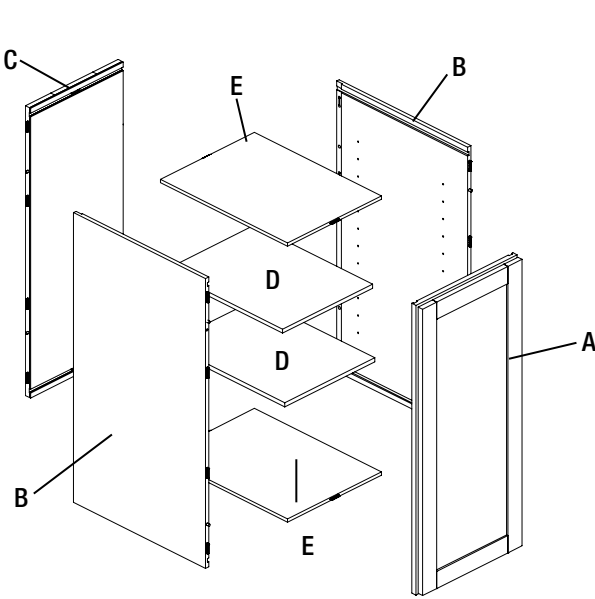

TOP CABINET

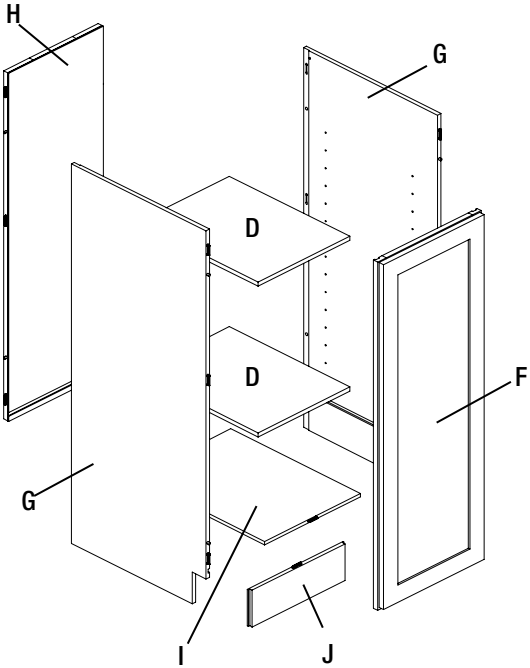

BASE CABINET

Part	Description	Qty.
TOP CABINET		
A	Face Frame and Doors	1
B	Side Panel	2
C	Back panel	1
D	Shelf	1-2
E	Top and Bottom Panels	2

BASE CABINET		
F	Face Frame and Doors	1
G	Side Panel	2
H	Back panel	1
I	Bottom Panel	1
D	Shelf	2
J	Toe Kick	1

*\* 96 in. Tall pantry has 4 shelves, lower pantries have 3 shelves.*

# Cabinet Assembly

## 1 Attaching the side panels into the face frame

- Start by placing the face frame (A) flat on a smooth surface that will not scratch or damage the face of the cabinet, such as a towel or piece of cardboard (1) from the packaging.



**NOTE:** Identification: Face frame /Side panels of BASE CABINET are longer than Face frame /Side panels of TOP CABINET.

### TOP CABINET

- Install the two side panels (B) into the mating grooves on the face frame (A) by: aligning the wooden dowels & male connectors on side panel (B) to the holes & female connectors on face frame (A).
- Use both hands to firmly press the side panels (B) down at all locations with connectors to ensure they lock together tightly.

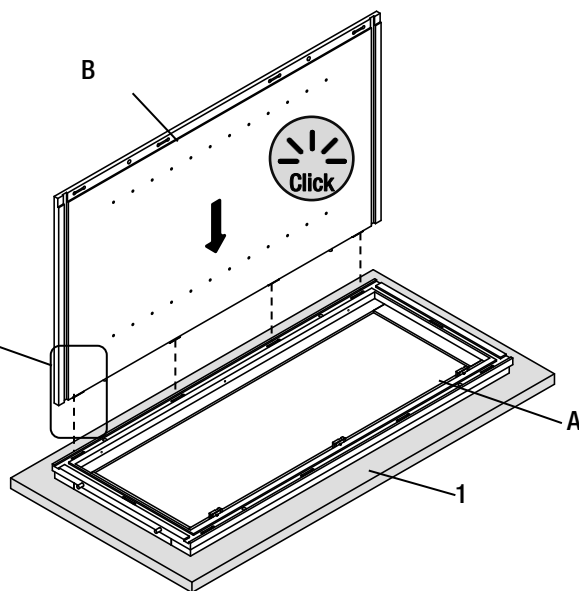
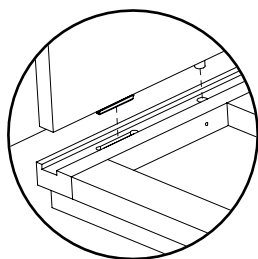
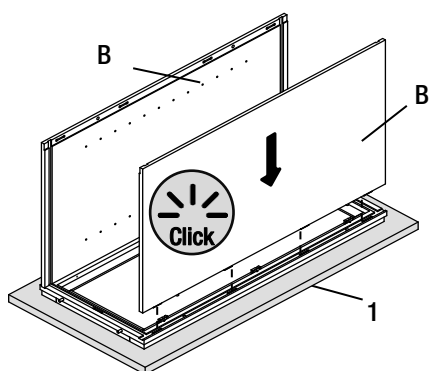

**IMPORTANT:** There will be a “clicking” sound when the connectors lock together properly

### BASE CABINET

- Repeat these steps for the front (F) and sides (G) of the Base Cabinet

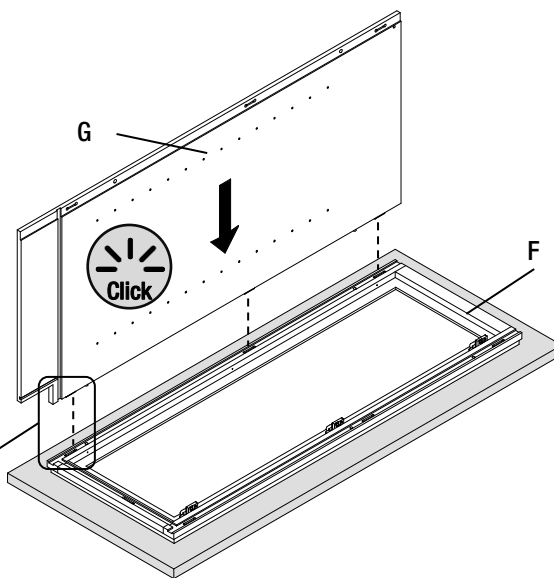
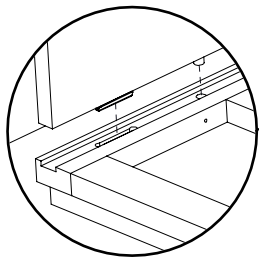
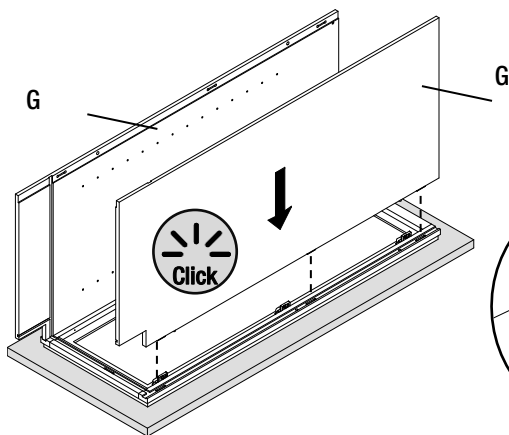

# Cabinet Assembly

## 2 Attaching the bottom and top panel



**NOTE: Identification**

The top and bottom panels (E) of TOP CABINET are identical and have:  
2 male connectors.

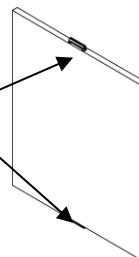

The bottom panel (I) of BASE CABINET has

- 1 male connector
- 1 female connector for Toekick.

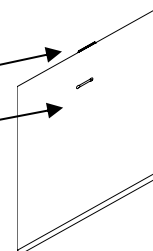

### TOP CABINET

- ☐ Slide the Top and bottom panel (E) into grooves in the sides (B). Use both hands to firmly press the panel (E) down at all locations with connectors to ensure they lock together tightly.

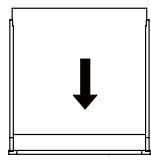
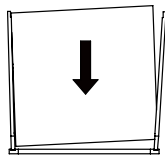
SLIDING PANEL	
Bottom/top/middle panel slides vertically.	Bottom/top/middle panel slides unevenly and tilting.
	
✓ RIGHT	✗ WRONG

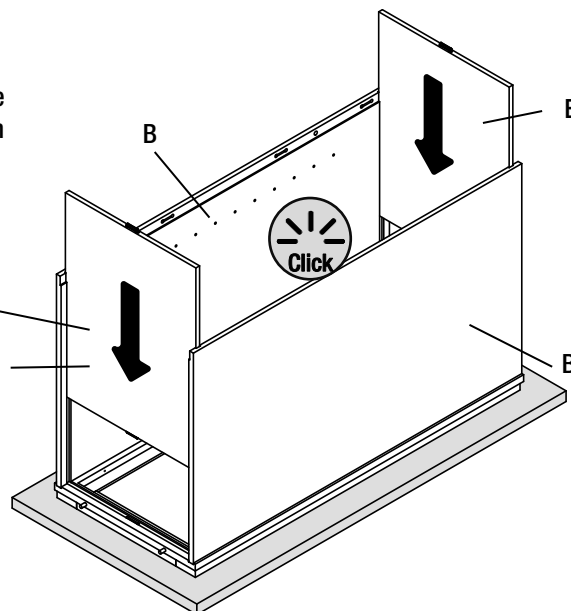
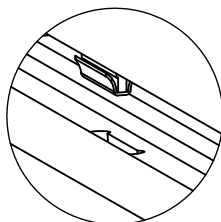

### BASE CABINET

- ☐ Repeat these steps for the bottom panel (I) and sides (G) of the Base Cabinet



**NOTE: Make sure the female connector at the bottom panel (I) is facing out.**

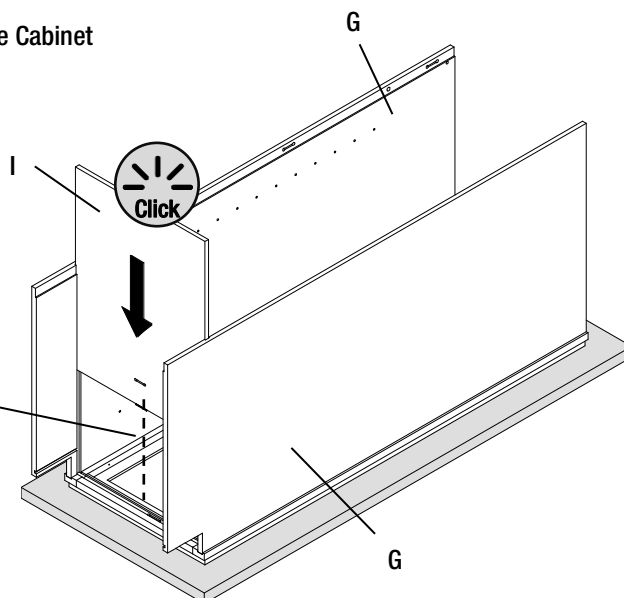
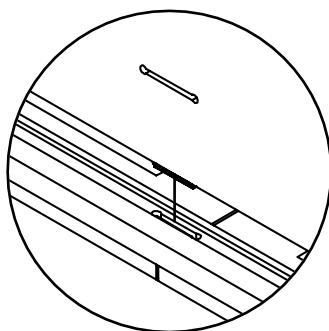

# Cabinet Assembly (Continued)

## 3 Attaching the back panel to the bottom/top panels



**NOTE:** Identification

Back panel (C) of  
TOP CABINET has  
2 groove and  
shorter.

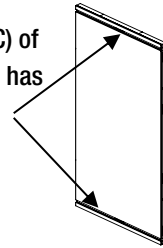

Back panel (H) of  
BASE CABINET has  
1 groove and  
longer.

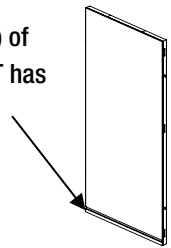

### TOP CABINET

- ☐ Flex outwards 2 side panels (B) slightly then place mating groove on the back panel (C) to the top and bottom panel (E) as shown.
- ☐ Aligning the female connectors on back panel (C) to the male connectors on top/bottom panels (E).
- ☐ Use both hands to firmly press the back panel (C) down at all locations with connectors to ensure they lock together tightly.

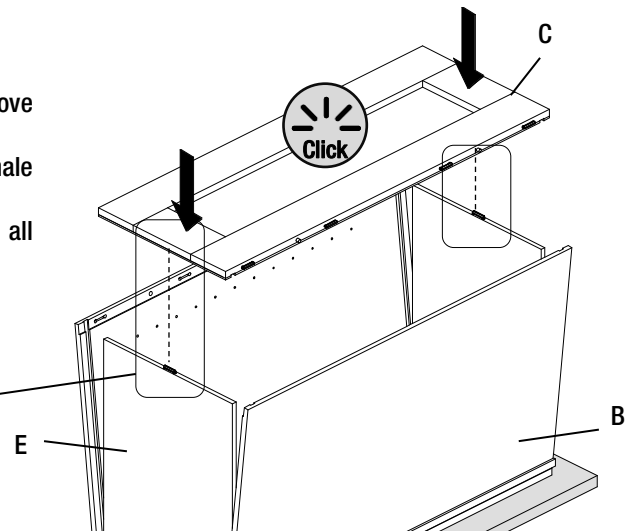
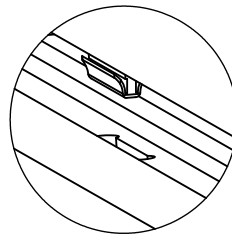

### BASE CABINET

- ☐ Install the Wooden dowels (FF) into the pre-drilled hole in side panels (G) as shown. It helps hold the other end on the back panel. It can be removed after assembly is completed.

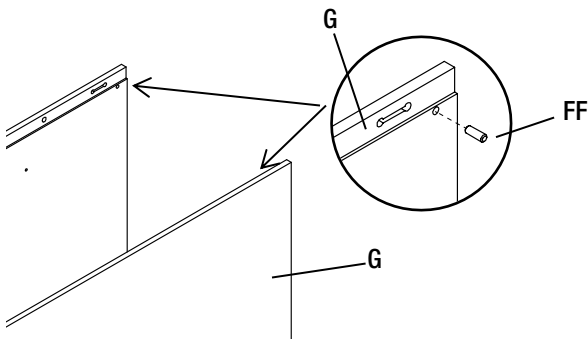

- ☐ Flex outwards 2 side panels (G) slightly then place mating groove on the back panel (H) to the bottom panel (I) as shown

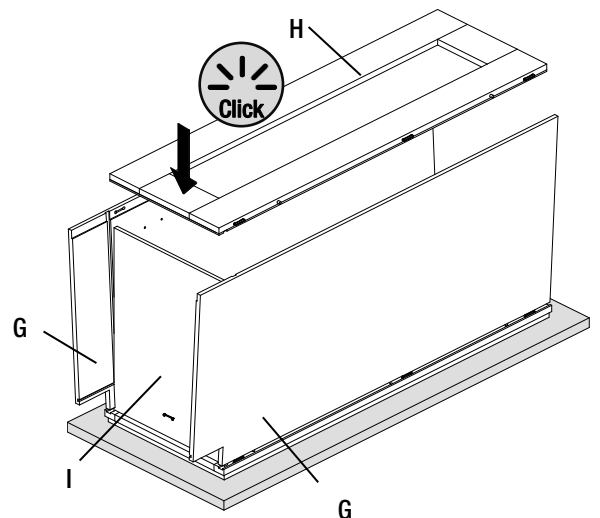

## Cabinet Assembly (Continued)

### 4 Attaching the side panels to bottom panel.

- Install the two side panels (B/G) to the back panel (C/H) by: aligning the wooden dowels & female connectors on the back panel (C/H) to the holes & male connectors on side panels (B/G).



**IMPORTANT:** Use your hands to grab the 2 side panels (B/G) inward at all locations with connectors to ensure they lock together with (C/H) tightly.

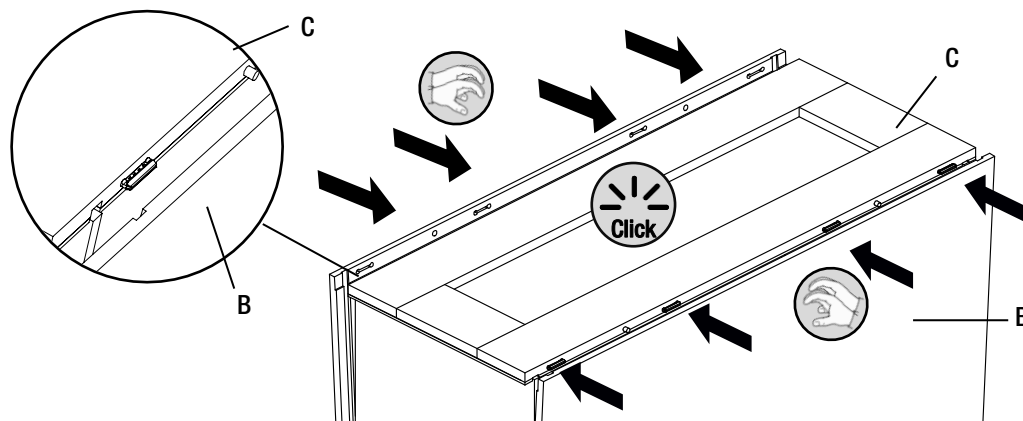

### 5 Attaching the toe kick for the bottom cabinet

- Slide the toe kick (J) into grooves in the bottom (I), make sure the male connector on toe kick (J) is aligned with female connector on the bottom panel (I).
- Use both hands to firmly press toe kick (J) to ensure connectors they lock together tightly.

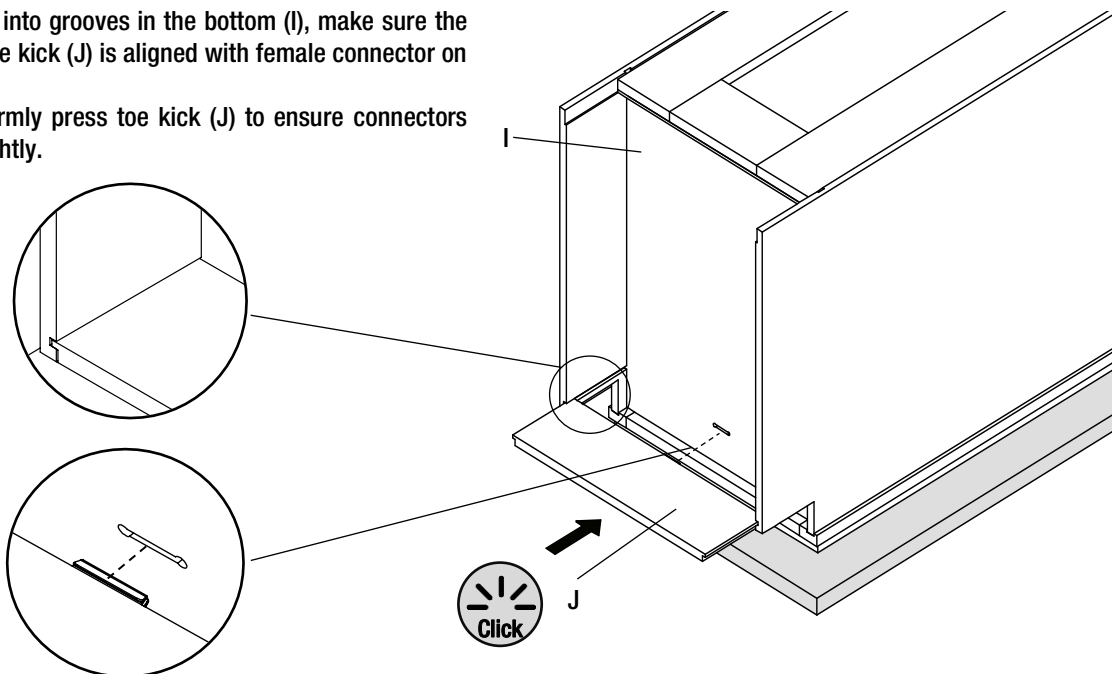

## Cabinet Assembly (Continued)

### 6 Check before installing



#### IMPORTANT:

- Before putting in to use, use a rubber mallet and wooden pad to tap all locations with connectors to ensure they lock together tightly.
- The wooden pad helps avoid damaging the product.

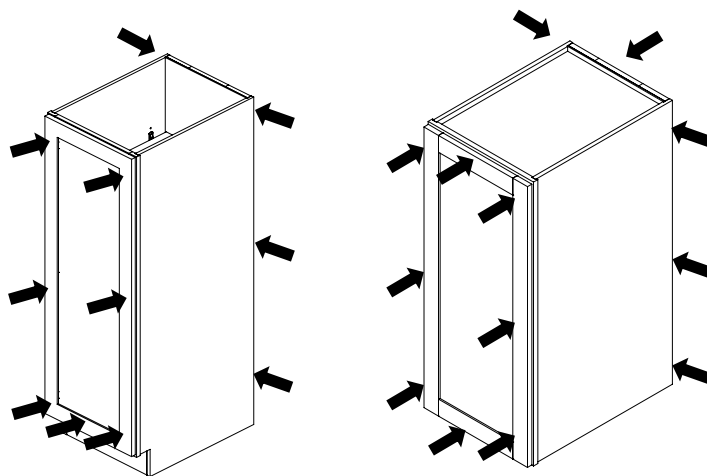
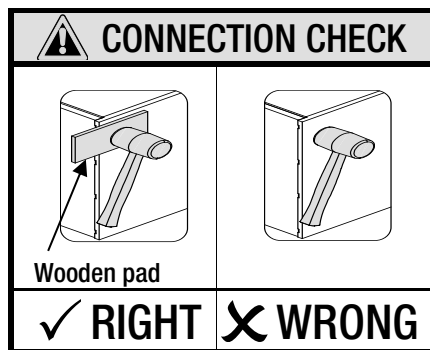

### 7 Attaching silicone pads.

- ☐ Peel and stick 2 silicone pads (DD) onto the inside corners of the door for each cabinet .

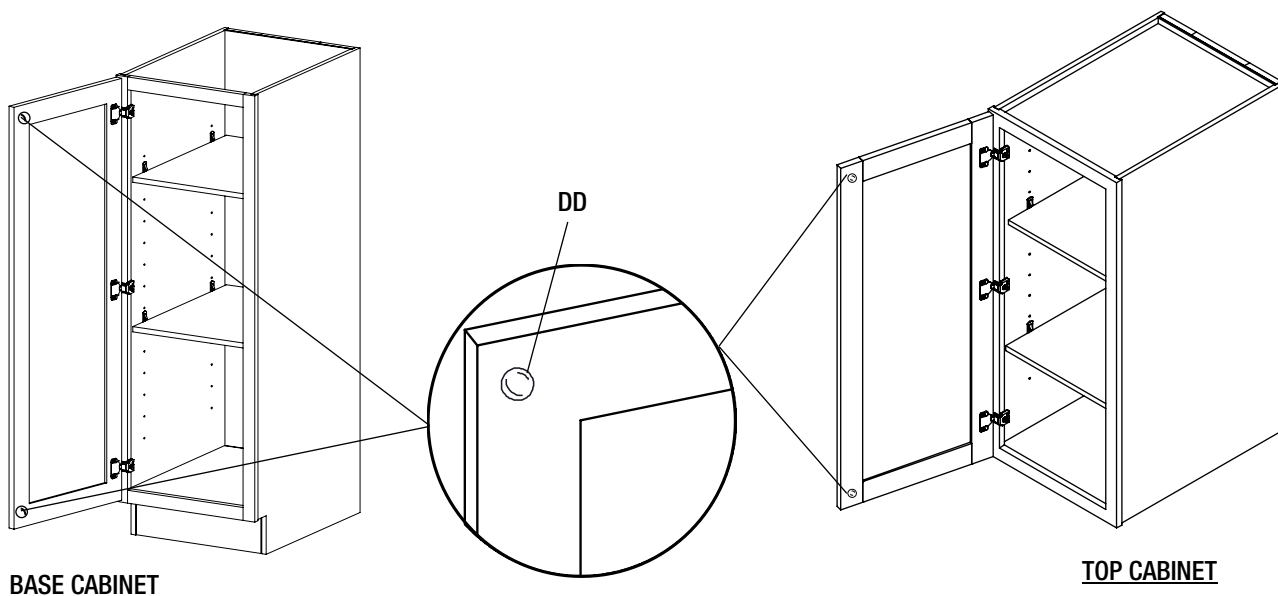

# Cabinet Assembly (Continued)

## 8 Attaching 2 cabinets together

- Install 8 metal plates (GG) into the underside of the TOP CABINET and secure with 2 screws (BB) for each metal plate (DO NOT TIGHTEN THE SCREWS AT THIS STEP)



**IMPORTANT:** To lift the Pantry up, at least 2 people are required.

TOP CABINET

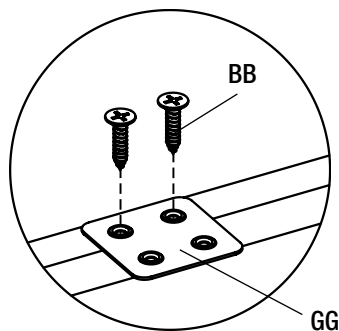
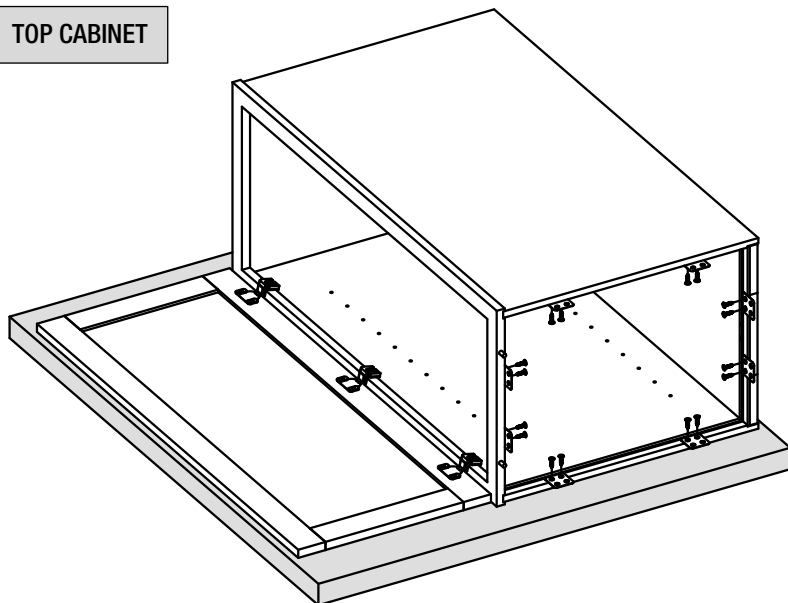

**NOTE:** Metal brackets GG and screws BB are packed inside the BASE CABINET package

- Install the top into the base so that the dowels and the metal plates on the top are aligned with the base.
- Secure with 2 screws (BB) for each metal plate at the base then tighten all the screws both top and base.

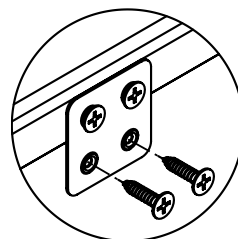
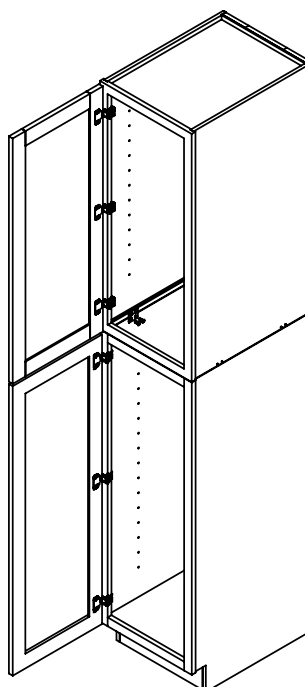
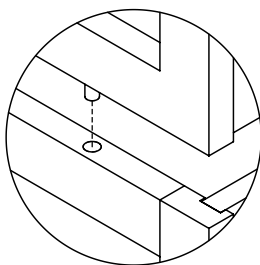
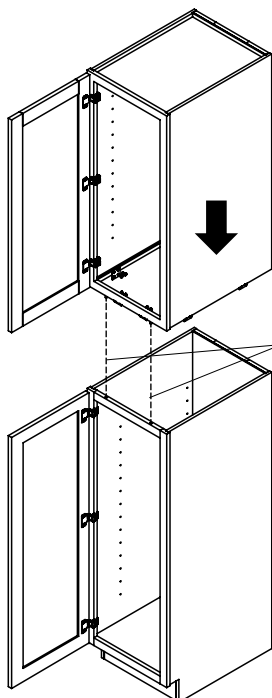

# Cabinet Assembly (Continued)

## 9 Installing the shelves

- ☐ Insert the shelf pins with pre-drilled holes on each side panel.
- ☐ Tilt the shelf (D) to fit inside the face frame and snap over the shelf pins (AA).
- ☐ To remove the shelf, push the tabs (1) on the shelf pins and lift the shelf.

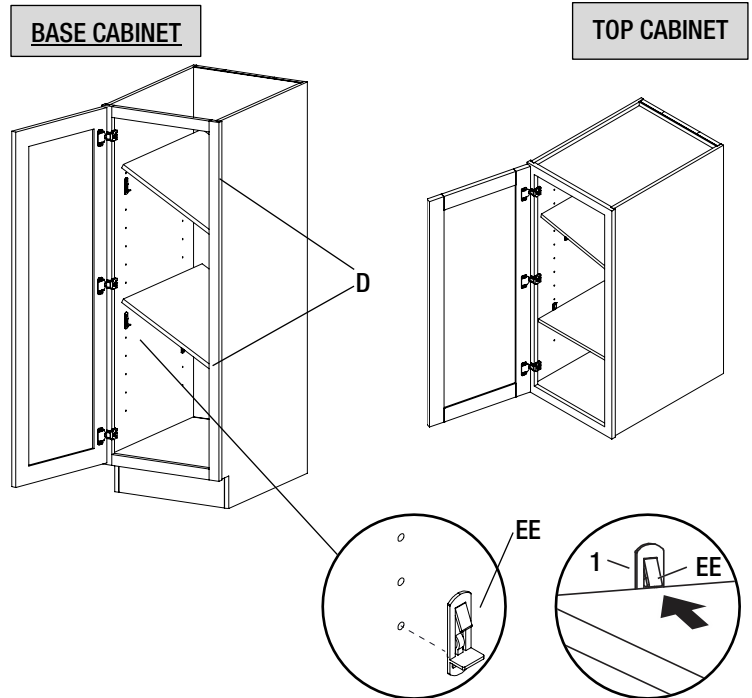

## 10 (OPTIONAL) Reversing the door position.

- ☐ You can remove and reposition the door to the other side of the face frame at any time using the pre-drilled holes. For pre-drilled holes that are not used, you can cover them up using a wax pencil or touch-up paint pen.

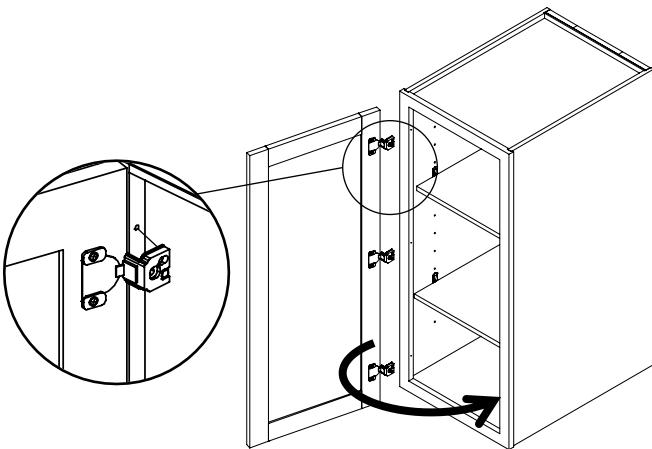

## 11 (OPTIONAL) Adjusting the door.

- ☐ Door hinges are 6-way adjustable.
- ☐ Up or down adjustment – Loosen screw 1, align the door, and tighten screw 1.



**NOTE:** It is critical that you do NOT overtighten screw 1.

- ☐ L/R adjustment Turn screw 2 clockwise or counterclockwise.
- ☐ In or out adjustment – Turn screw 3 clockwise or counterclockwise.

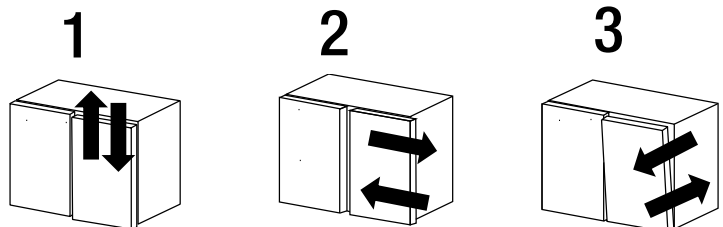
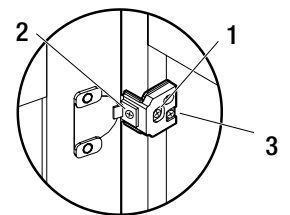

# Before Putting in Use

## 1 Move product



**IMPORTANT:** To avoid damaging the product when moving:

- **DO NOT** slide the product on the floor to avoid product damaged
- Needs at least 2 people to lift the product, move it to another location and then put it down.

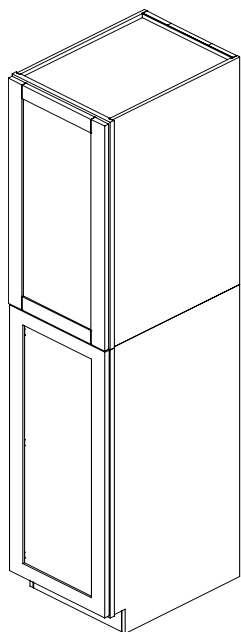

Lift the product, move it to another location and then put it down

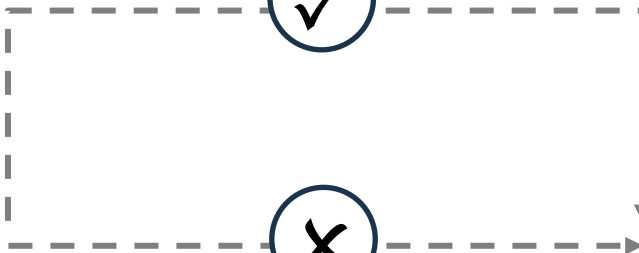

**DO NOT** slide the product on the floor

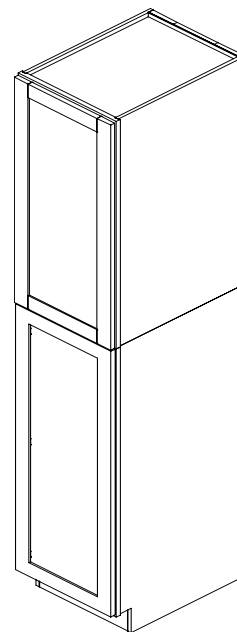

## 2 Attach the cabinet to the wall.



**IMPORTANT:**

When attaching cabinet to the wall, making sure that it is attached to the "frame" of the back panel as shown beside.

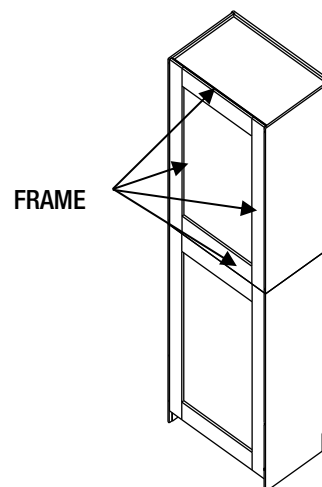

## Care and Cleaning

---

- For normal spills, a damp cloth is sufficient. Dry the surface immediately.
- Doors can be cleaned with most general-purpose household cleaners.
- Do not use caustic agents and/or abrasive scrubbers, or oven cleaners.
- Cabinets can be cleaned with a damp sponge or cloth using soapy water, or most general-purpose household cleaners. Do not use any abrasive cleaner or scrubbers.
- Do not allow liquids to remain on the surface for long periods of time.

# HAMPTON BAY®

Questions, problems, missing parts? Before returning to the store,  
call Hampton Bay Customer Service  
8 a.m. – 7 p.m., EST, Monday – Friday, 9 a.m. – 6 p.m., EST, Saturday

**1-855-HD-HAMPTON**

**HAMPTONBAY.COM**

Retain this manual for future use.