



Tahoe™

20" rectangular drop-in bathroom sink

K-2890-4

Features

- 4" (102 mm) centerset faucet holes
- Overflow drain
- Metal frame installation

Material

- KOHLER® enameled cast iron

Installation

- Drop-in

Recommended Products/Accessories

K-23726 Drain treatment
K-23725 Cast iron cleaner



ADA

CSA B651

OBC

Codes/Standards

ASME A112.19.1/CSA B45.2
ADA
ICC/ANSI A117.1
CSA B651
OBC

KOHLER® Enameled Cast Iron Kitchen and Bathroom Sink Lifetime Limited Warranty

See website for detailed warranty information.

Available Colors/Finishes

Color tiles intended for reference only.

Color	Code	Description
-------	------	-------------



0	White
---	-------

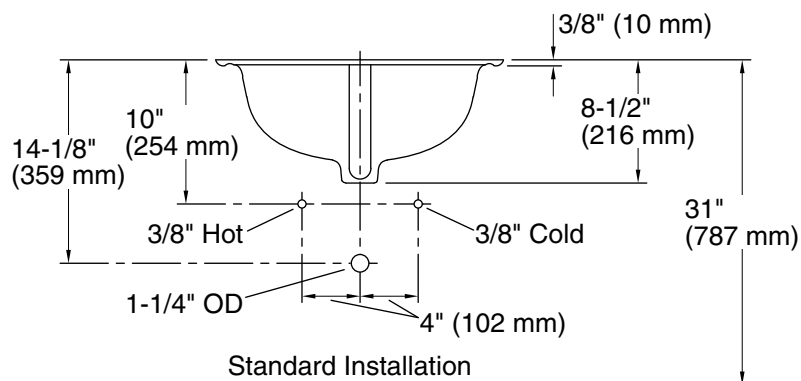
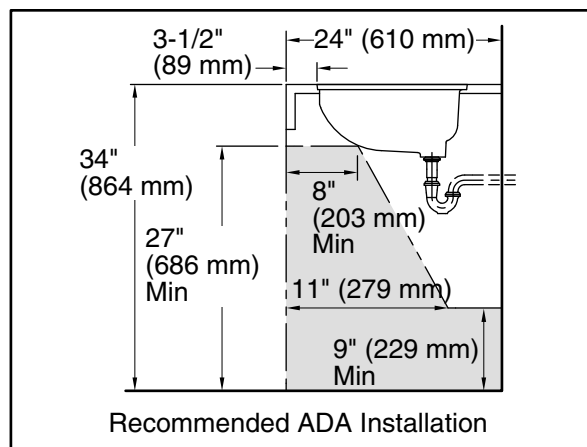
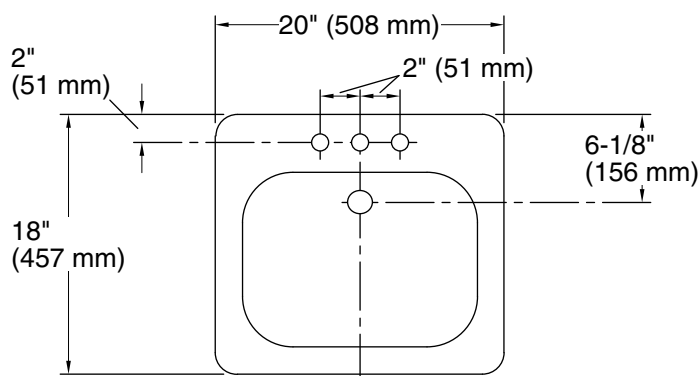

Technical Information

All product dimensions are nominal.

Bowl configuration:	Single
Installation:	Drop-in
Center(s):	4
Bowl area (Only):	Length: 16" (406 mm)
	Width: 12" (305 mm)
	With overflow: Yes
	Water depth: 5" (127 mm)
With overflow:	Yes
Number of deck holes:	3
Faucet hole spacing:	4" (102 mm)
Faucet hole(s):	1-3/8" (35 mm)
Drain hole:	1-11/16" (43 mm)

Notes

Install this product according to the installation instructions.

A metal frame is required for installation.

ADA, OBC, CSA B651 compliant when installed to the specific requirements of these regulations.